

740A

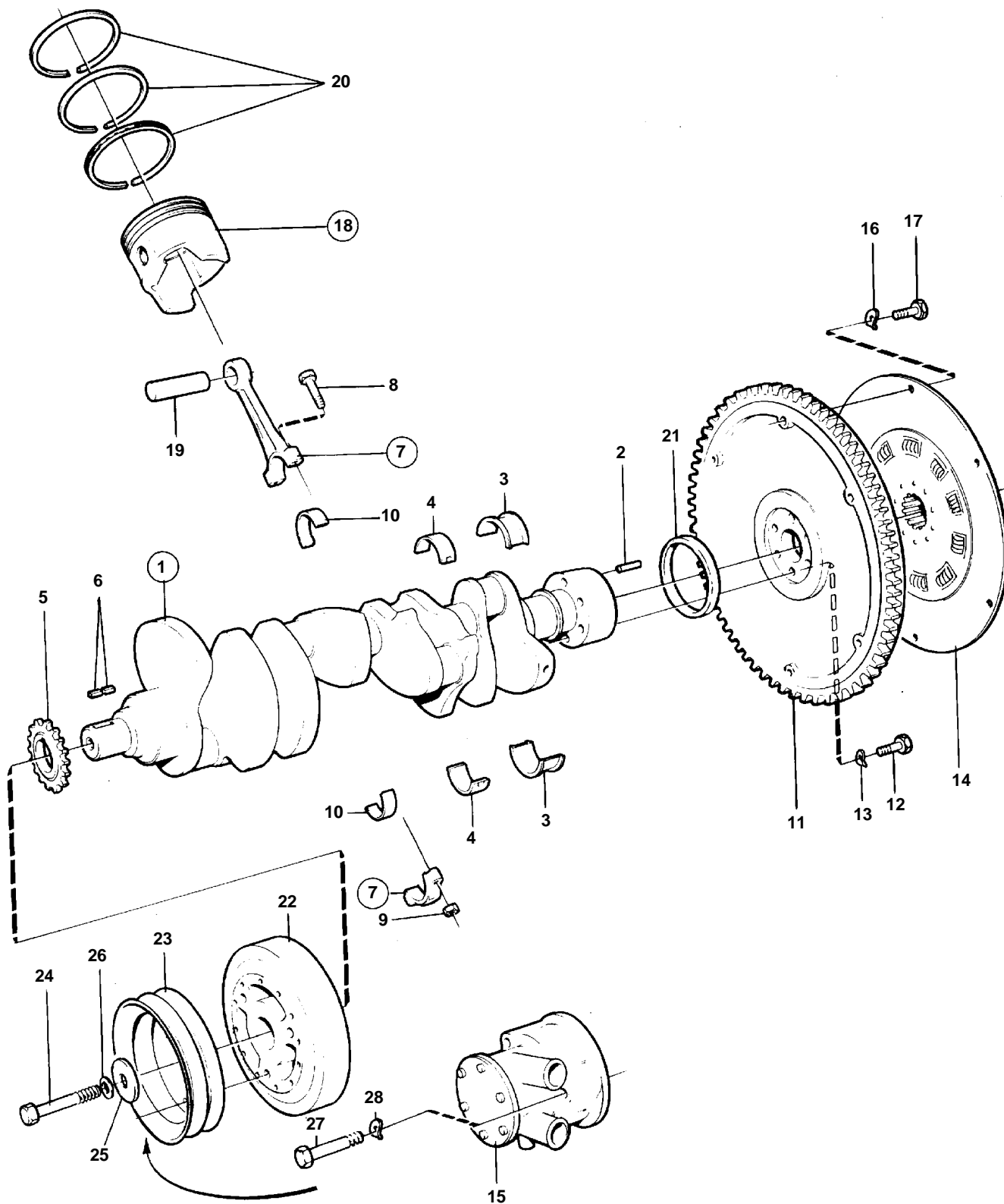

740A

REF	PART NO.	QTY	DESCRIPTION	SEE SEC.	NOTES
1	856579	1	Crankshaft		INCLUDED IN BASIC ENGINE 856708
2	835057	1	• Pin		
3	856557	1	Bearing		INCL.IN CYLINDERBLOCK., STD
	856559	1	Bearing		UNDER SIZE 0,010"
	856561	1	Bearing		UNDER SIZE 0,020"
4	856556	4	Bearing		INCL.IN CYLINDERBLOCK., STD
	856558	4	Bearing		UNDER SIZE 0,010"
		4	Bearing		UNDER SIZE 0,020"
5		1	SPROCKET	19958	
6	835059	2	Key		
7	856586	8	Connecting rod		
8	856587	16	• Screw		
9	856588	16	• Nut		
10		8	Bearing shell		STD
		8	Bearing shell		UNDER SIZE 0,010"
		8	Bearing shell		UNDER SIZE 0,020"
11		1	Flywheel		
12	835439	6	Screw		
13	941909	6	Spring washer		
14	856346	1	Vibration damper		
15		1	SEA WATER PUMP		SEE GROUP 2B
16	942336	3	Spring washer		
17	835482	3	Screw		
18	856589	8	Piston		INCL.IN CYLINDERBLOCK., STD
	856590	8	Piston		OVER SIZE 0,030"
19		8	• GUDGEON PIN		
20	856591	8	Piston ring kit		INCL.IN CYLINDERBLOCK., STD
	856592	8	Piston ring kit		OVER SIZE 0,030"
21	856580	1	Crankshaft seal		
22	856581	1	Vibration damper		
23	856304	1	Pulley		
24	856582	1	Screw		
25	856584	1	Washer		
26	856583	1	Lock washer		
27	976644	3	Hex. socket screw		SEE GROUP 2B
28	942336	3	Spring washer		SEE GROUP 2B