

7.4GiPEFS

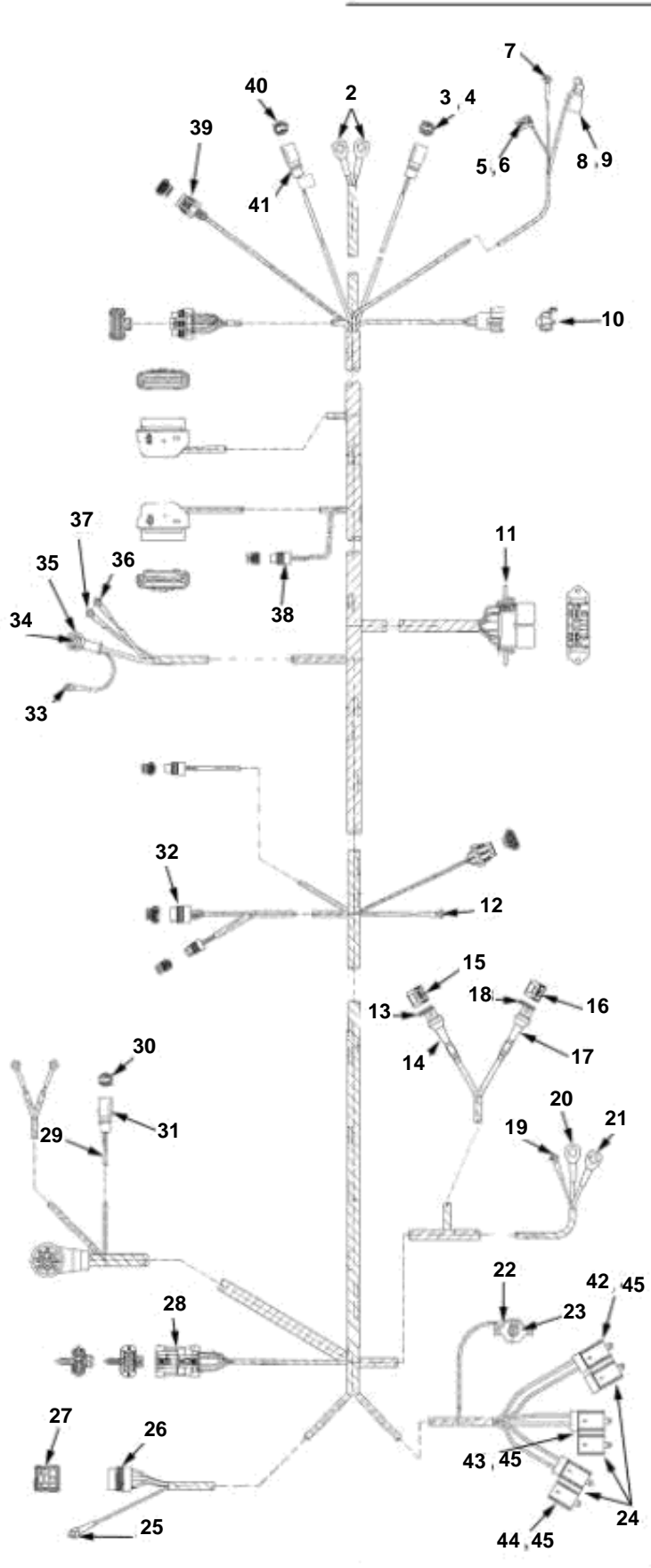

7.4GiPEFS

| REF | PART NO. | QTY | DESCRIPTION                                 | NOTES               |
|-----|----------|-----|---|---------------------|
| 1   | 3860044  | 1   | Wiring harness                              |                     |
| 2   | 3852527  | 1   | Terminal                                    |                     |
| 3   | 3853565  | 1   | Connector, Trim sender                      |                     |
| 4   | 3852229  | 2   | Terminal, Trim sender                       |                     |
| 5   | 3852084  | 1   | Terminal, Oil pressure switch               |                     |
| 6   | 3853320  | 1   | Cardboard tube, Oil pressure switch         |                     |
| 7   | 3852233  | 1   | Terminal, Oil pressure transmitter          |                     |
| 8   | 3857189  | 1   | Cable seal, Knock sensor                    |                     |
| 9   | 3853480  | 1   | Terminal casing, Knock sensor               |                     |
| 10  | 3854244  | 1   | Cable                                       |                     |
| 11  | 3852210  | 1   | Bracket, Fuel pump and ignition relay       |                     |
| 12  | 3852233  | 1   | Terminal, Water temperature transmitter     |                     |
| 13  | 3855021  | 1   | Connector housing, Low pressure fuel pump   |                     |
| 14  | 3853681  | 1   | Trunk, Low pressure fuel pump               |                     |
| 15  | 3853679  | 2   | Terminal, Low pressure fuel pump            |                     |
| 16  | 3853679  | 2   | Terminal, High pressure fuel pump           |                     |
| 17  | 3853681  | 1   | Trunk, High pressure fuel pump              |                     |
| 18  | 3855021  | 1   | Connector housing, High pressure fuel pump  |                     |
| 19  |          | 1   | Terminal, Starter solenoid starter terminal |                     |
| 20  | 3852527  | 1   | Terminal, Alternator output                 |                     |
| 21  | 3852527  | 1   | Terminal, Starter solenoid                  |                     |
| 22  | 3852245  | 1   | Terminal, Circuit breaker                   |                     |
| 23  | 3854164  | 2   | Automatic fuse, 50 amp                      |                     |
| 24  | 3860455  | 3   | Fuse holder                                 |                     |
| 25  | 3852227  | 1   | Terminal, Electrical bracket ground         |                     |
| 26  | 3854192  | 1   | Relay, Starter relay                        |                     |
| 27  | 3852254  | 4   | Terminal, Starter relay                     |                     |
| 28  |          | 1   | Connector                                   | not sold separately |
| 29  |          | 1   | Cable tie                                   |                     |
| 30  | 3852229  | 2   | Terminal, Shift interrupt                   |                     |
| 31  | 3853565  | 1   | Connector, Shift interrupt                  |                     |
| 32  |          | 1   | Connector, Idle air control (IAC)           | not sold separately |
| 33  | 3852233  | 1   | Terminal, Alternator sense                  |                     |
| 34  | 3852038  | 1   | Terminal, Alternator output                 |                     |
| 35  | 3852130  | 1   | Rubber cap, Alternator output               |                     |
| 36  |          | 1   | Terminal, Alternator excite                 |                     |
| 37  | 3852245  | 1   | Terminal, Alternator ground                 |                     |
| 38  | 3857142  | 1   | Connector, MAT sensor                       |                     |
| 39  |          | 1   | Connector, Distributor                      | not sold separately |
| 40  | 3852229  | 2   | Terminal                                    |                     |
| 41  | 3853565  | 1   | Connector                                   |                     |
| 42  | 979686   | 2   | Fuse, 40 amp                                |                     |
| 43  | 966329   | 2   | Fuse, 15 amp                                |                     |
| 44  | 968547   | 2   | Fuse, 20 amp                                |                     |
| 45  | 3860455  | 3   | Fuse holder                                 |                     |