

7.4GSiPEFS, 8.2GSiPEFS, DPX385XEFS, DPX415XEFS

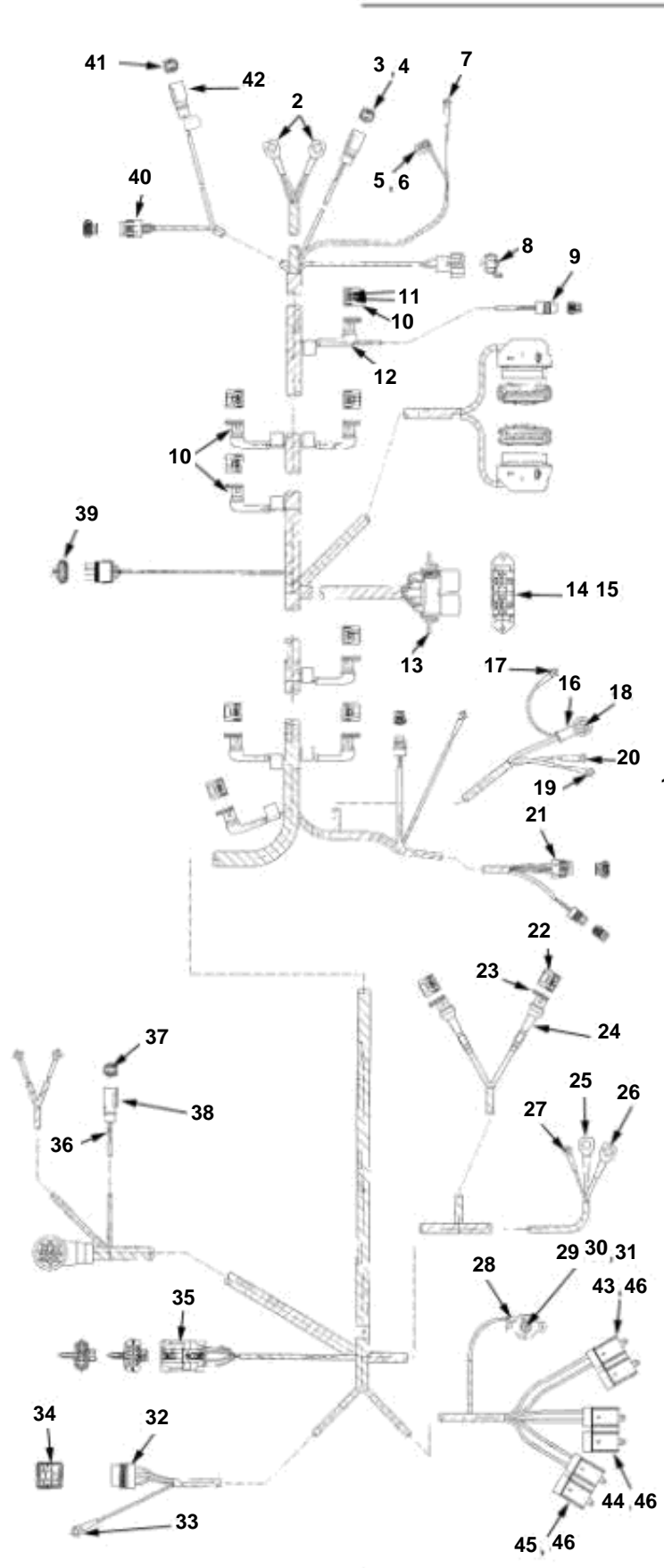

7.4GSiPEFS, 8.2GSiPEFS, DPX385XEFS, DPX415XEFS

REF	PART NO.	QTY	DESCRIPTION	NOTES
1	3860047	1	Wiring harness	
2	3852527	2	Terminal	
3	3853565	1	Connector, Trim sender	
4	3852229	2	Terminal, Trim sender	
5	3852084	1	Terminal, Oil pressure switch	
6	3853320	1	Cardboard tube, Oil pressure switch	
7	3852233	1	Terminal, Oil pressure transmitter	
8	3854244	1	Cable, Ignition coil	
9	3857142	1	Connector, MAT sensor	
10	3855021	8	Connector housing, Injector cylinder	
11	3853679	12	Terminal, Injector cylinder	
12	3853711	8	Receptacle, Injector cylinder	
13	3852210	1	Bracket, Fuel pump and ignition relay	
14	3852247	4	Terminal	
15	3852246	4	Terminal	
16	3852038	1	Terminal, Alternator output	
17	3852233	1	Terminal, Alternator sense	
18	3852130	1	Rubber cap, Alternator output	
19		1	Terminal, Alternator excite	
20	3852245	1	Terminal, Alternator ground	
21		1	Connector	Part not sold
22	3853679	2	Terminal, High pressure fuel pump	
23	3855021	1	Connector housing, High pressure fuel pump	
24	3853681	1	Trunk, High pressure fuel pump	
25	3852527	1	Terminal, Alternator output	
26	3852527	1	Terminal, Starter solenoid	
27		1	Terminal, Starter solenoid to starter terminal	
28	3852245	1	Terminal, Circuit breaker	
29	3854164	1	Automatic fuse, 50 amp	
30	3852064	2	Nut	
31	3852001	2	Spring washer	
32	3854192	1	Relay	
33	3852227	1	Terminal, Starter relay	
34	3852254	4	Terminal, Starter relay	
35		1	Connector	Part not sold
36		1	Cable tie	
37	3852229	2	Terminal, Shift interrupt	
38	3853565	1	Connector, Shift interrupt	
39	3857189	3	Cable seal, MAP sensor	
40		1	Connector, Distributor	Part not sold
41	3852229	2	Terminal	
42	3853565	1	Connector	
43	979686	2	Fuse, 40 amp	
44	966329	2	Fuse, 15 amp	
45	968547	2	Fuse, 20 amp	
46	3860455	3	Fuse holder	