

7.4GIPWTR

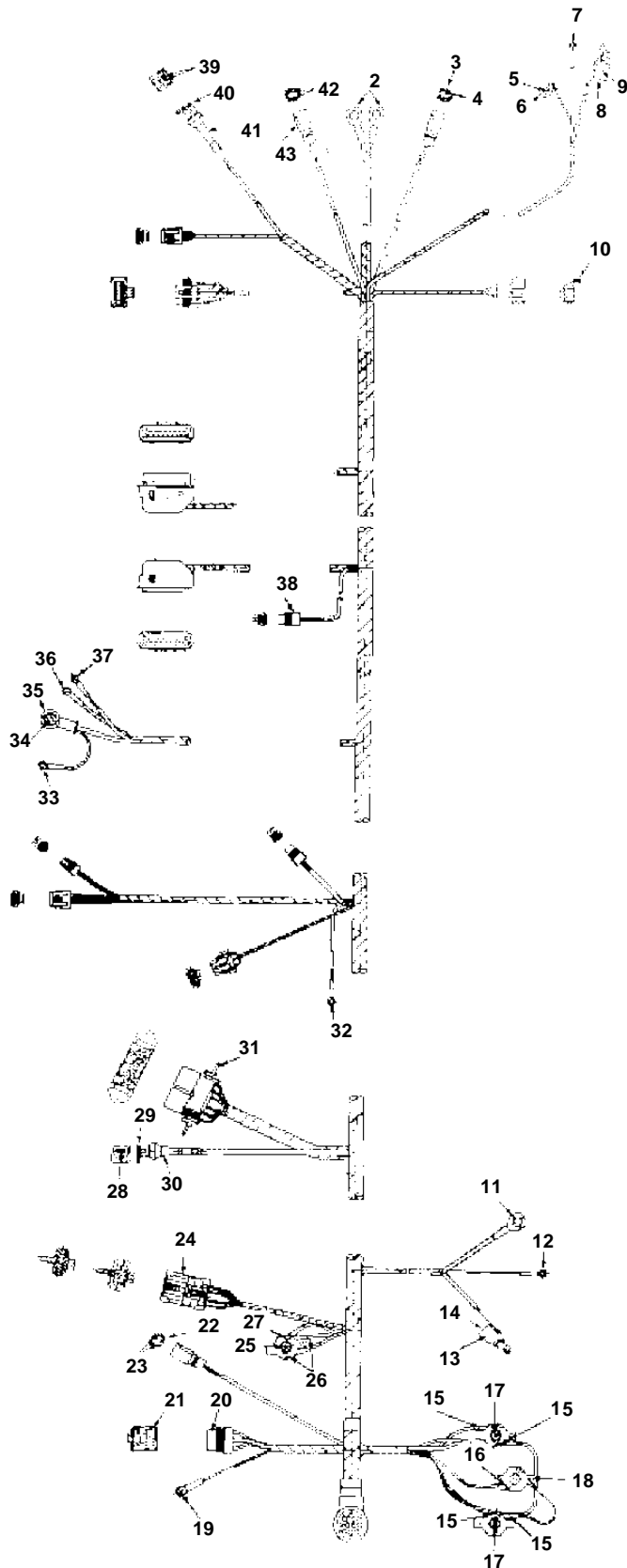

1

Gr71947

7.4GIPWTR

REF	PART NO.	QTY	DESCRIPTION	NOTES
1	3858297	1	Wiring harness	
2	3852227	2	Terminal	
3	3853565	1	Connector, 2 pin	
4	3852229	2	Terminal, Trim sender	
5	3852084	1	Terminal, Oil pressure switch	
6	3853320	1	Cardboard tube, Oil pressure switch	
7	3852233	1	Terminal, Oil pressure transmitter	
8	3857189	1	Cable seal, Knock sensor	
9	3853480	1	Terminal casing, Knock sensor	
10	3854244	1	Cable	
11	3852527	1	Terminal, Starter solenoid	
12		1	Terminal, Starter solenoid starter terminal	
13	3857189	1	Cable seal, Knock sensor	
14	3853480	1	Terminal casing, Knock sensor	
15	3852245	6	Terminal	
16		2	Terminal	
17	3854164	2	Automatic fuse, 50 amp	
18	3854162	1	Automatic fuse, 12.5 amp	
19	3852227	1	Terminal, Electrical bracket ground	
20	3854192	1	Relay, Starter relay	
21	3852254	4	Terminal, Starter relay	
22	3853565	1	Connector, Shift interrupt	
23	3852229	2	Terminal, Shift interrupt	
24		1	Connector	Part not sold
25	3854163	1	Automatic fuse, 20 amp	
26		2	Terminal	
27	3852233	1	Terminal	
28	3853679	2	Terminal, Low pressure fuel pump	
29	3855021	1	Connector housing, Low pressure fuel pump	
30	3853681	1	Trunk, Low pressure fuel pump	
31	3852210	1	Bracket, Fuel pump and ignition relay	
32	3852233	1	Terminal, Water temperature transmitter	
33	3852233	1	Terminal, Alternator sense	
34	3852038	1	Terminal, Alternator output	
35	3852130	1	Rubber cap, Alternator output	
36	3852245	1	Terminal, Alternator ground	
37		1	Terminal, Alternator excite	
38	3857142	1	Connector, MAT sensor	
39	3853679	2	Terminal, High pressure fuel pump	
40	3855021	1	Connector housing, High pressure fuel pump	
41	3853681	1	Trunk	
42	3852229	2	Terminal	
43	3853565	1	Connector	