

5.7GL-C, 5.7GL-D, 5.0GL-C, 5.0GL-D

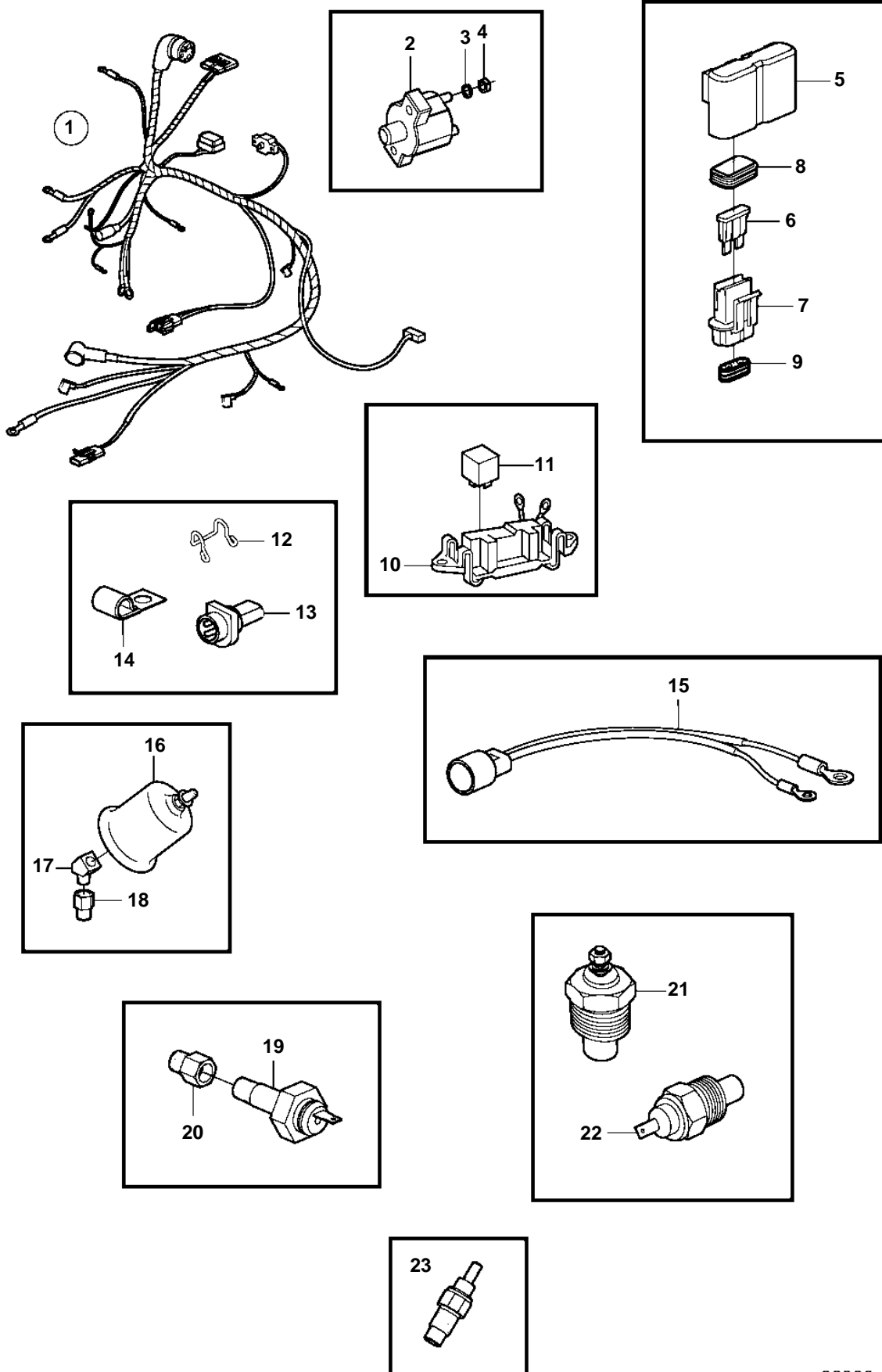

5.7GL-C, 5.7GL-D, 5.0GL-C, 5.0GL-D

REF	PART NO.	QTY	DESCRIPTION	NOTES
1	3862619	1	Wiring harness	
2	3854164	1	· Automatic fuse	50A
3	3852001	2	· Spring washer	
4	3852064	2	· Nut	
5	3860455	1	· Fuse holder	
6	979686	2	· Fuse	40A
	969197	2	· Fuse	7.5A
7	8166029	2	· Insulator	
8		2	· · Seal	
9		2	· · Seal	
10	3852210	1	· Bracket	
11	3857533	1	· Relay	FUEL PUMP
12	3852237	1	Retainer	
13	3855178	1	Connector	
14	3852434	4	Clamp, J	D=.750" (19.0mm)
	3852146	1	Clamp, J	D=.375" (9.5mm)
	3852124	1	Clamp, J	D=.188" (4.8mm)
15	3854031	1	Wiring harness, trim	
16	3857532	1	Oil pressure sensor, oil pressure	
	872064	X	Pressure sensor, oil pressure	DUAL STATION
17	3852503	1	Elbow	
18	3855776	1	Adapter	
19	3852215	1	Pressure monitor, oil pressure	
20	3850660	1	Fitting	
21	3852029	1	Sensor, coolant water temp.	
	872068	X	Temperature sensor, coolant water temp.	DUAL STATION
22	872066	1	Thermo monitor, coolant water temp.	
23	3862500	2	Temperature sensor	Exhaust