

5.0GIPEFS, 5.7GSIPEFS

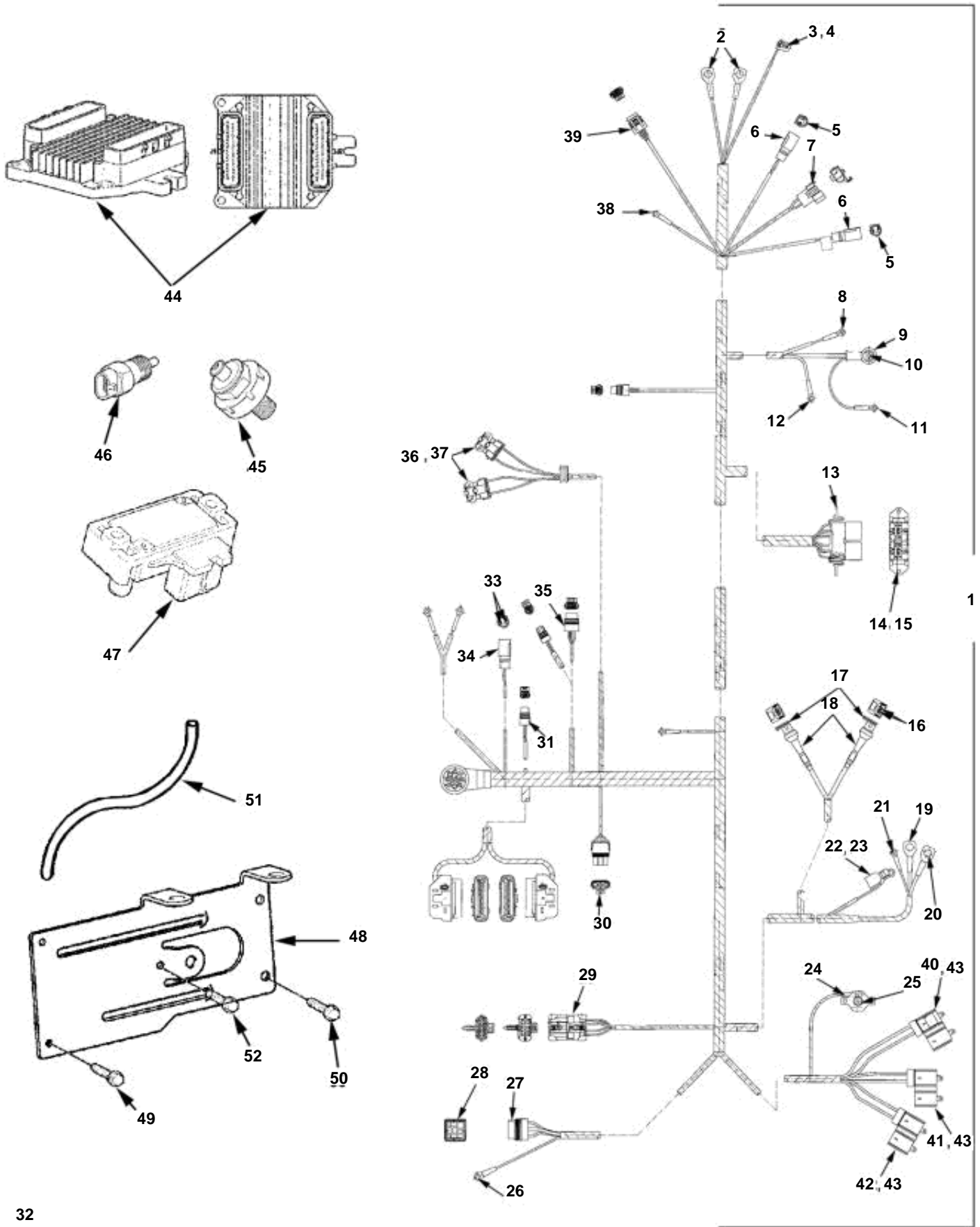

5.0GIPEFS, 5.7GSIPEFS

REF	PART NO.	QTY	DESCRIPTION	SEE SEC.	NOTES
1	3860041	1	Wiring harness		
2	3852527	2	Terminal		
3	3852084	1	Terminal, Oil pressure switch		
4	3853320	1	Cardboard tube, Oil pressure switch		
5	3852229	4	Terminal		
6	3853565	2	Connector		
7	3854244	1	Cable, Ignition coil		
8		1	Terminal, Alternator excite		
9	3852130	1	Rubber cap, Alternator output		
10	3852038	1	Terminal, Alternator output		
11		1	Terminal, Alternator sense		
12	3852227	1	Terminal, Alternator ground		
13	3852210	1	Bracket, Fuel pump ignition relay		
14	3852247	4	Terminal		
15	3852246	4	Terminal		
16	3853679	2	Terminal, High pressure fuel pump		
17	3855021	1	Connector housing, High pressure fuel pump		
18	3853681	1	Trunk, High pressure fuel pump		
19	3852527	1	Terminal, Starter solenoid		
20	3852527	1	Terminal, Alternator output		
21		1	Terminal, Starter solenoid-starter terminal		
22	3857189	1	Cable seal, Knock sensor		
23	3853480	1	Terminal casing, Knock sensor		
24	3852245	1	Terminal, Circuit breaker		
25	3854164	1	Automatic fuse, 50 amp		
26	3852227	1	Terminal, Starter relay		
27	3854192	1	Relay, Starter relay		
28	3852254	4	Terminal, Starter relay		
29		1	Connector		
30	3857189	3	Cable seal, MAP sensor		
31	3857142	1	Connector		
32		1	Cable tie		Not shown
33	3852229	2	Terminal, Shift interrupt		
34	3853565	1	Connector, Shift interrupt		
35		1	Connector		
36	3850671	3	Cable terminal, Injector		
37	3857189	3	Cable seal, Injector		
38	3852233	1	Terminal, Oil pressure transmitter		
39		1	Connector, Distributor		
40	979686	2	Fuse, 40 amp		
41	966329	2	Fuse, 15 amp		
42		2	Fuse, 20 amp		
43	3860455	3	Fuse holder		
44	3858887	1	Engine control modul · Bulletin P-28-4-9	P-28-4-9-EN	Gi ECM Replacement
44	3858888	1	Engine control modul · Bulletin P-28-4-9	P-28-4-9-EN	GSi ECM Replacement
45	3850357	1	Knock sensor		
46	3850397	1	Switch		
47	3850396	1	Sensor		
48	3857815	1	Bracket, ECM and MAP sensor		
49	3852115	2	Screw, MAP sensor bracket		
50	3852053	3	Screw, ECM to bracket		
51	3857179	4	Hose, MAP sensor		
52	3853398	1	Screw, ECU bracket to riser		