

430A, 430B, 431A, 431B, 432A, 434A, 500B, 501B, 570A, 572A, 740B, DP-A, DP-A1, DP-A2, DP-C, DP-C1, DP-C1 1.95, DP-C1 2.30, DP-D, DP-D1, DP-D1 1.68, DP-D1 1.78, DP-D1 1.95, DP-D1 2.30, SP-A, SP-A1, SP-A2, SP-C, SP-C1

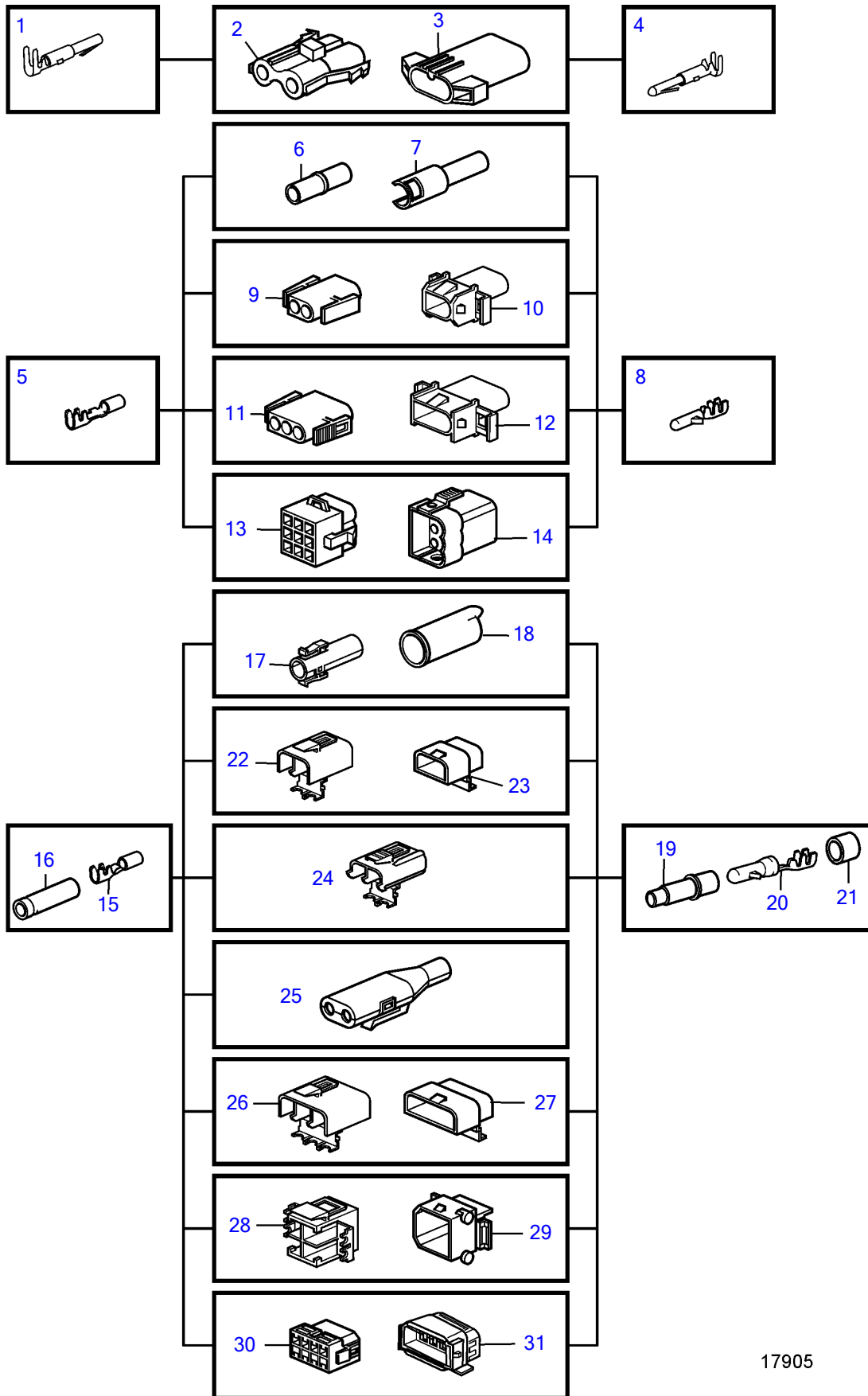

17905

430A, 430B, 431A, 431B, 432A, 434A, 500B, 501B, 570A, 572A, 740B, DP-A, DP-A1, DP-A2, DP-C, DP-C1, DP-C1 1.95, DP-C1 2.30, DP-D, DP-D1, DP-D1 1.68, DP-D1 1.78, DP-D1 1.95, DP-D1 2.30, SP-A, SP-A1, SP-A2, SP-C, SP-C1

REF	PART NO.	QTY	DESCRIPTION	NOTES
1	946038	1	Cable terminal	2,1x0,5-1mm <sup>2</sup>
2	944224	1	Housing	2-pole
3	944223	1	Housing	2-pole
4		1	Cable terminal	Not marketed by Volvo Penta., 2,1x0,5-1mm <sup>2</sup>
5	965822	1	Cable terminal	3,5x1,1-2,5mm <sup>2</sup>
	948289	1	Cable terminal	3,5x2,5-4,0mm <sup>2</sup>
6	949584	1	Housing	3,5x1 natural
7	949583	1	Housing	3,5x1 natural
8	969831	1	Cable terminal	3,5x0,5-1mm <sup>2</sup>
	965824	1	Cable terminal	3,5x1,1-2,5mm <sup>2</sup>
	965825	1	Cable terminal	3,5x2,6-4,0mm <sup>2</sup>
9	948996	1	Housing	3,5x2 natural
10	948995	1	Housing	3,5x2 natural
11	948296	1	Housing	3,5x3 natural
12	948297	1	Housing	3,5x3 natural
13	948294	1	Housing	3,5x9 natural
14	948295	1	Housing	3,5x9 natural
15	949371	1	Cable terminal	3,5x0,75-1,5mm <sup>2</sup>
	1598753	1	Insulator	3,5x2,5-4,5mm <sup>2</sup>
16	1598753	1	Insulator	
17	1307035	1	Housing	1-pole
18	1308436	1	Housing	1-pole
19	1608765	1	Insulator	
20	965824	1	Cable terminal	3,5x2,5-4,5mm <sup>2</sup>
21	1608766	1	Sealing	
22	1307048	1	Housing	2-pole
23	1307049	1	Housing	2-pole
24	970753	1	Housing	2-pole
25	1624477	1	Housing	2-pole
26	1259828	1	Housing	3-pole
27	3523442	1	Pin housing	3-polig (1259829)
28	1259830	1	Housing	4-pole
29	1259831	1	Housing	4-pole
30	966812	1	Housing	8-pole
31	967809	1	Housing	8-pole