

740B

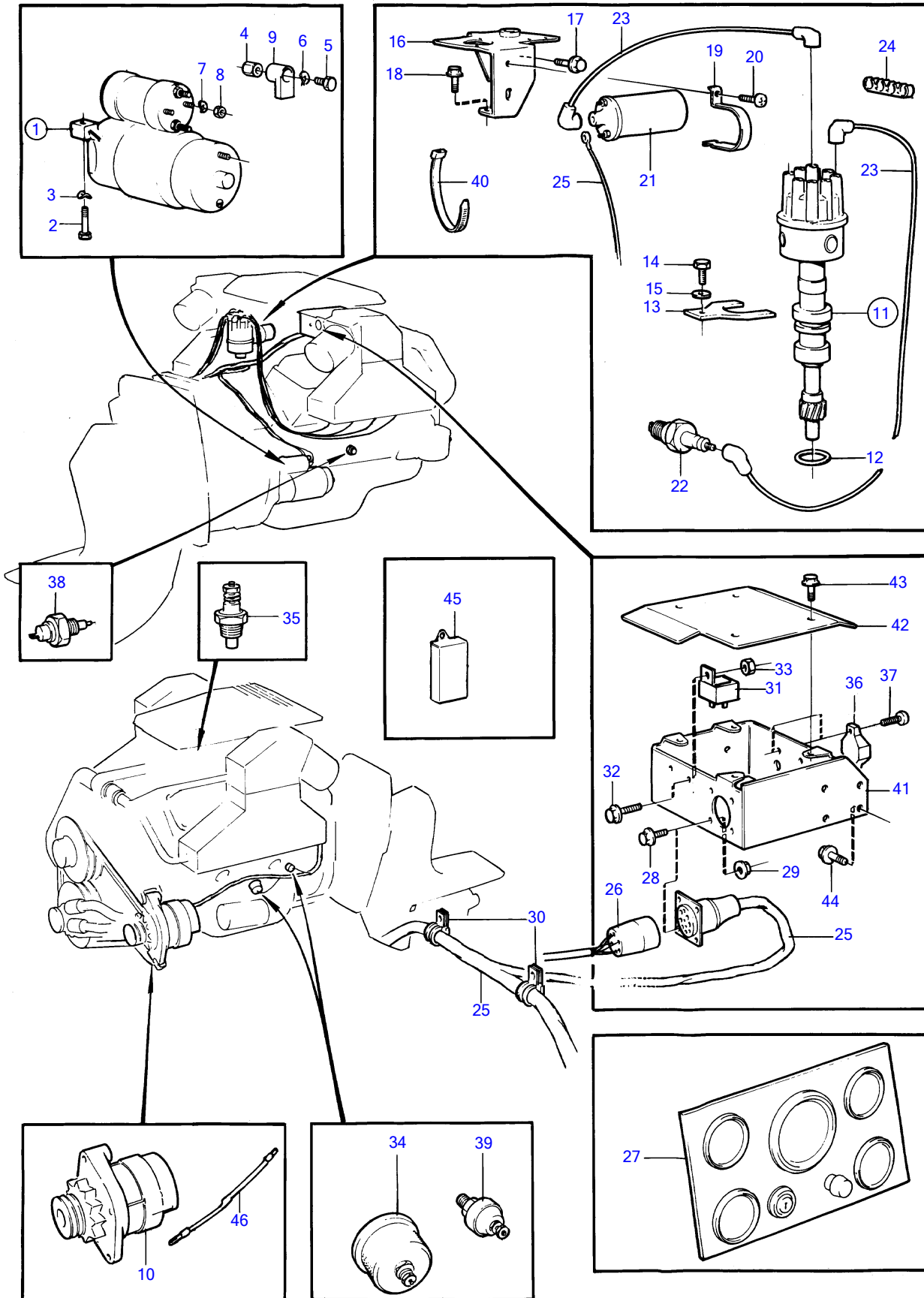

740B

REF	PART NO.	QTY	DESCRIPTION	SEE SEC.	NOTES
1	872394	1	Starter motor		Also available as an exchange part.
			.	12551	
2	835424	2	Screw		
3	942336	1	Spring washer		
4	855330	1	Spacer nut		
5	970943	1	Hexagon screw		
6	940109	1	Toothed washer		
7	941905	2	Spring washer		
8	955780	2	Hexagon nut		
9	855798	1	Protecting sleeve		
10		1	alternator with installation components	12545	
11	(855932)	1	Distributor		Obsolete part
			.	12548	
12	835154	1	Gasket		
13	841530	1	Retainer		
14	940114	1	Hexagon screw		
15	940097	1	Washer		
16	856479	1	Bracket		See group 2D
17	946440	4	Flange screw		
18	942624	1	Flange screw		
19	(856440)	1	Attaching clamp		Obsolete part
20	(834371)	1	Screw		Obsolete part
21	(857409)	1	Ignition coil		Obsolete part, (855706)
22	876047	2	Spark plug kit		
23	856771	X	Ignition cable		All ignition cables partno 856771 which are 1000mm and should be cut off in suitable lengths., L=1000mm
24	(835429)	4	Retainer		Obsolete part
25	872791	1	Wiring harness		
		X	. cables and terminals	12558	
26	(856881)	X	Extension cable\verl		Obsolete part, L=3000mm
		X	Extension cable\verl		L=6000mm
27	(856673)	1	Instrument panel		Obsolete part, Eur
			.	12554	
	(856672)	1	Instrument panel		Obsolete part, USA
			.	12553	
28	946934	4	Flange screw		
29	945407	4	Flange nut		
30		2	clamp		Replaced by 1ea clamp 977592.
31	841177	2	Relay		
32	948663	2	Flange screw		
33	955780	2	Hexagon nut		
34	872063	1	Pressure sensor		
35	872067	1	Temperature sensor		
36	856337	2	Automatic fuse		50A
37	950013	4	Cross recessed screw		
38	(872194)	1	Thermo monitor		Obsolete part
39	(872065)	1	Pressure monitor		Obsolete part, (841599)
40	948210	X	Cable tie		
41	(857007)	1	Shoulder screw		Obsolete part
42	(856524)	1	Cardboard tube		Obsolete part
43	965175	4	Flange screw		
44	946440	4	Flange screw		
45	(856424)	1	Overspeed protection		Obsolete part, To be attached in the engine room.
46	834784	2	Resistor		

7736260-30-12537

11312

Upd:2014-10-28