

432A, 434A

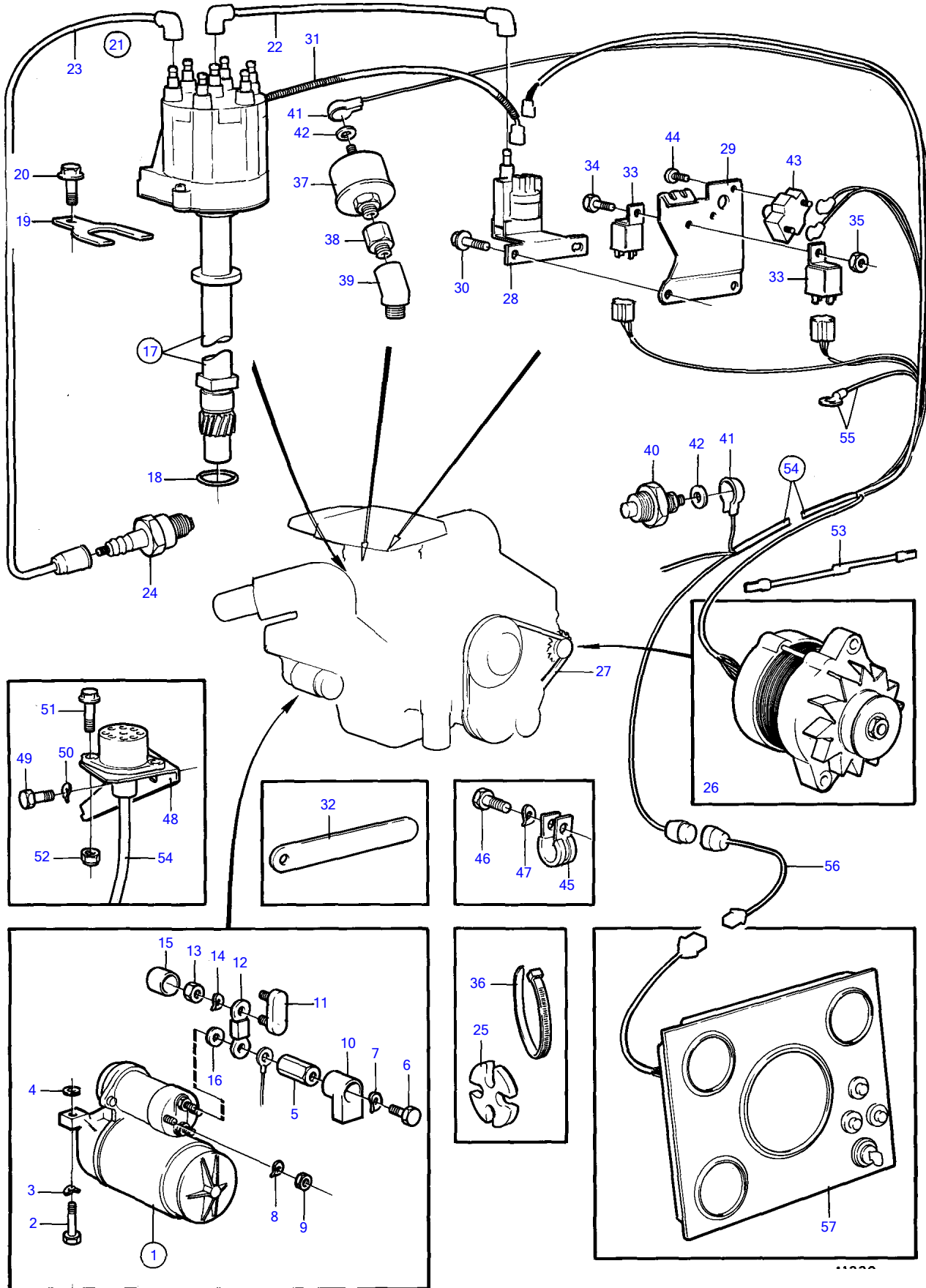

11220

432A, 434A

| REF | PART NO. | QTY | DESCRIPTION | SEE SEC. | NOTES |
|-----|-----------|-----|--|----------|--|
| 1 | 872394 | 1 | Starter motor | | |
| | | | . | 12551 | |
| 2 | 835424 | 2 | Screw | | |
| 3 | 942336 | 2 | Spring washer | | |
| 4 | 841194 | 2 | Adjusting washer | | |
| 5 | 857180 | 1 | Spacer nut | | |
| 6 | 970943 | 1 | Hexagon screw | | |
| 7 | 940109 | 1 | Toothed washer | | |
| 8 | 941905 | 2 | Spring washer | | |
| 9 | 955780 | 2 | Hexagon nut | | |
| 10 | 855798 | 1 | Protecting sleeve | | |
| 11 | 856355 | 1 | Fuse | | |
| 12 | 860212 | 1 | Current bar | | |
| 13 | 955781 | 2 | Hexagon nut | | |
| 14 | 941906 | 1 | Spring washer | | |
| 15 | 853572 | 1 | Protective cap | | |
| 16 | 1585449 | 1 | Gasket | | |
| 17 | (857371) | 1 | Distributor | | Obsolete part |
| | | | . | 12547 | |
| 18 | 835154 | 1 | Gasket | | |
| 19 | 841530 | 1 | Retainer | | |
| 20 | 944209 | 1 | Flange screw | | |
| 21 | 857362 | 1 | Ignition cable kit | | |
| 22 | | 1 | · ignition cable | | |
| 23 | | 6 | · ignition cable | | |
| 24 | 876046 | 1 | Spark plug kit | | Included in base engine., See group 10A |
| 25 | (1219071) | 4 | Retainer | | Obsolete part |
| 26 | | 1 | alternator and installation components | 12540 | |
| 27 | 966857 | 1 | V-belt | | |
| 28 | 857361 | 1 | Ignition coil | | |
| 29 | | 1 | bracket | | See group 2D |
| 30 | 944209 | 2 | Flange screw | | |
| 31 | 857372 | 1 | Wiring harness | | |
| 32 | (83899) | 1 | Clamp | | Obsolete part, For cable unit., On the carburetor. |
| 33 | 841177 | 2 | Relay | | |
| 34 | 955246 | 1 | Hexagon screw | | |
| 35 | 955780 | 1 | Hexagon nut | | |
| 36 | 948210 | X | Cable tie | | |
| 37 | 872063 | 1 | Pressure sensor | | |
| | 872064 | 1 | Pressure sensor | | For fly bridge. |
| 38 | 835980 | 1 | Nipple | | |
| 39 | 809109 | 1 | Elbow nipple | | |
| 40 | 872067 | 1 | Temperature sensor | | |
| | 872068 | 1 | Temperature sensor | | For fly bridge. |
| 41 | (1234326) | 2 | Protecting casing | | Obsolete part |
| 42 | 960140 | 2 | Washer | | |
| 43 | 841178 | 1 | Automatic fuse | | 40A |
| 44 | 950014 | 2 | Cross recessed screw | | |
| 45 | 942810 | 1 | Clamp | | For cable unit. |
| 46 | 940133 | 1 | Hexagon screw | | |
| 47 | 942336 | 1 | Spring washer | | |
| 48 | (857373) | 1 | Bracket | | Obsolete part |
| 49 | 940133 | 1 | Hexagon screw | | |
| 50 | 942336 | 1 | Spring washer | | |
| 51 | 946934 | 2 | Flange screw | | |
| 52 | 949278 | 2 | Flange lock nut | | |
| 53 | 834784 | 1 | Resistor | | |
| 54 | 857370 | 1 | Wiring harness | | |
| 55 | | X | · cables and terminals | 12557 | |
| 56 | (856881) | X | Extension cable'verl | | Obsolete part, L=3000mm |
| | 856882 | X | Extension cable'verl | | L=6000mm |
| 57 | 856820 | 1 | Instrument panel | | |

7736260-30-12559

11220

Upd:2014-10-28

432A, 434A

| REF | PART NO. | QTY | DESCRIPTION | SEE SEC. | NOTES |
|-----|----------|-----|-------------|----------|-------|
| | | | . | 12555 | |