

4.3GiPEFS

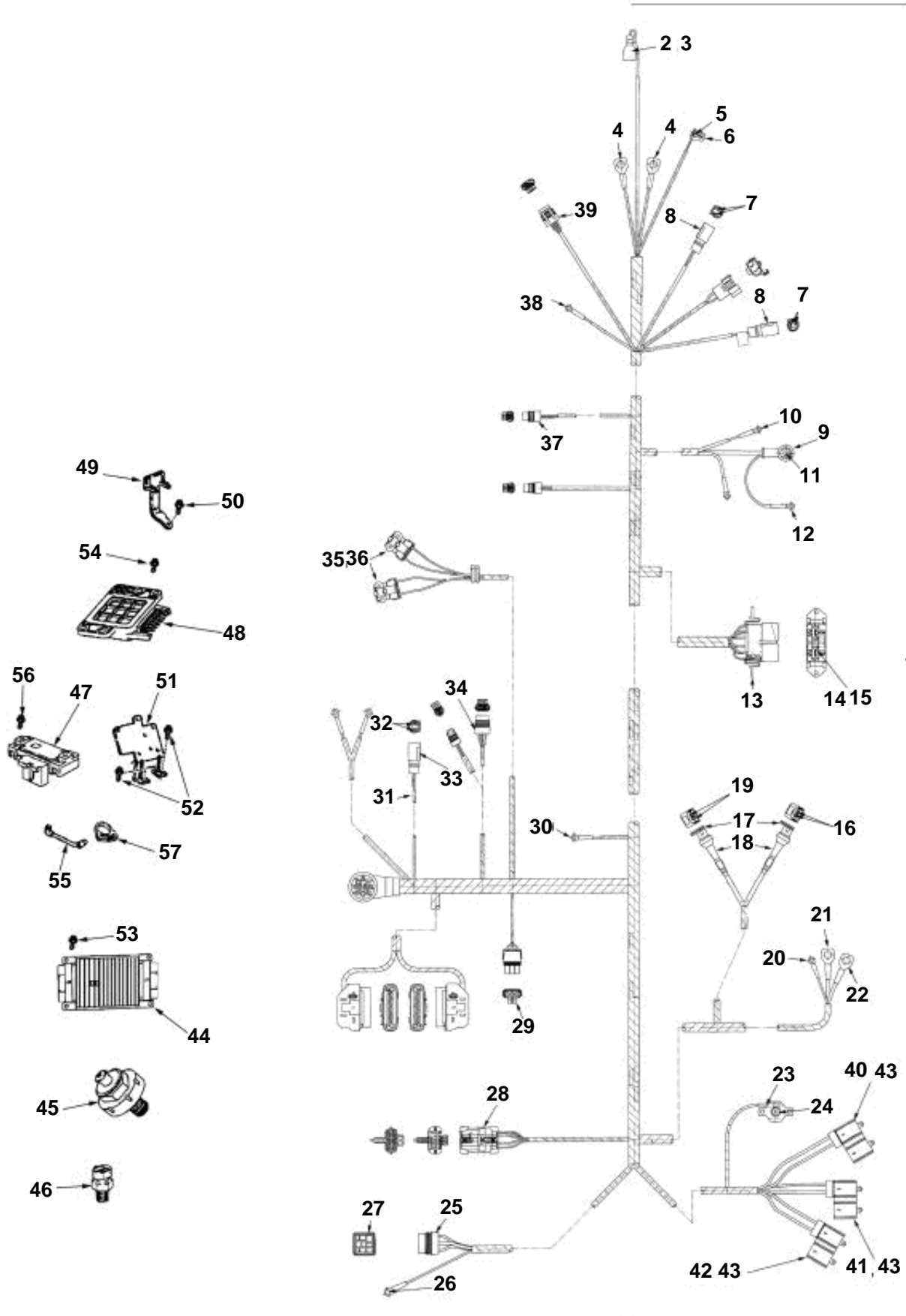

4.3GiPEFS

REF	PART NO.	QTY	DESCRIPTION	SEE SEC.	NOTES
1	3860037	1	Wiring harness		
2	3857189	1	Cable seal, Knock sensor		
3	3853480	1	Terminal casing, Knock sensor		
4	3852527	2	Terminal		
5	3852084	1	Terminal		
6	3853320	1	Cardboard tube		
7	3852229	4	Terminal		
8	3853565	2	Connector		
9	3854244	1	Cable, Ignition coil		
10		1	Terminal, Alternator excite		
11	3852038	1	Terminal, Alternator output		
12	3852233	1	Terminal, Alternator sense		
13	3852210	1	Bracket, Fuel pump ignition relay		
14	3852246	4	Terminal		
15	3852247	4	Terminal		
16	3853679	2	Terminal, High pressure fuel pump		
17	3855021	2	Connector housing		
18	3853681	2	Trunk		
19	3853679	2	Terminal, Low pressure fuel pump		
20		1	Terminal, Starter solenoid, starter terminal		
21	3852527	1	Terminal, Alternator output		
22	3852527	1	Terminal, Starter solenoid		
23	3852245	1	Terminal		
24	3854164	1	Automatic fuse, 50 amp		
25	3854192	1	Relay, Starter relay		
26	3852227	1	Terminal, Starter relay		
27	3852254	4	Terminal		
28		1	Connector housing		Part not sold
29	3857189	3	Cable seal		
30	3852233	1	Terminal		
31		1	Cable tie		
32	3852229	1	Terminal		
33	3853565	1	Connector, 2 pin		
34		1	Connector housing		Part not sold
35	3857189	2	Cable seal		
36	3850671	2	Cable terminal, Injector		
37	3857142	1	Connector		
38	3852233	1	Terminal		
39		1	Connector housing, Distributor		Part not sold
40	979686	2	Fuse, 40 amp		
41	966329	2	Fuse, 15 amp		
42	968547	2	Fuse, 20 amp		
43	3860455	3	Fuse holder		
44	3860098	1	Engine control modul, Electronic control module · Bulletin P-28-4-9	P-28-4-9-EN	ECM Replacement
45	3854905	1	Sensor		
46	3850397	1	Switch		
47	3850396	1	Sensor		
48	3854672	1	Module		
49		1	Bracket, Knock module		
50	3852115	2	Screw, Knock module bracket		
51	3851990	1	Bracket		
52	3852115	2	Screw, Bracket to adapter		
53	3855578	4	Screw, ECM to bracket		
54	3852115	2	Screw, Knock module to bracket		
55	3850688	4	Hose, MAP sensor		
56	3852115	2	Screw, MAP sensor to bracket		
57	3852172	1	Clamp, Hose, MAP sensor		