

230A, 230B

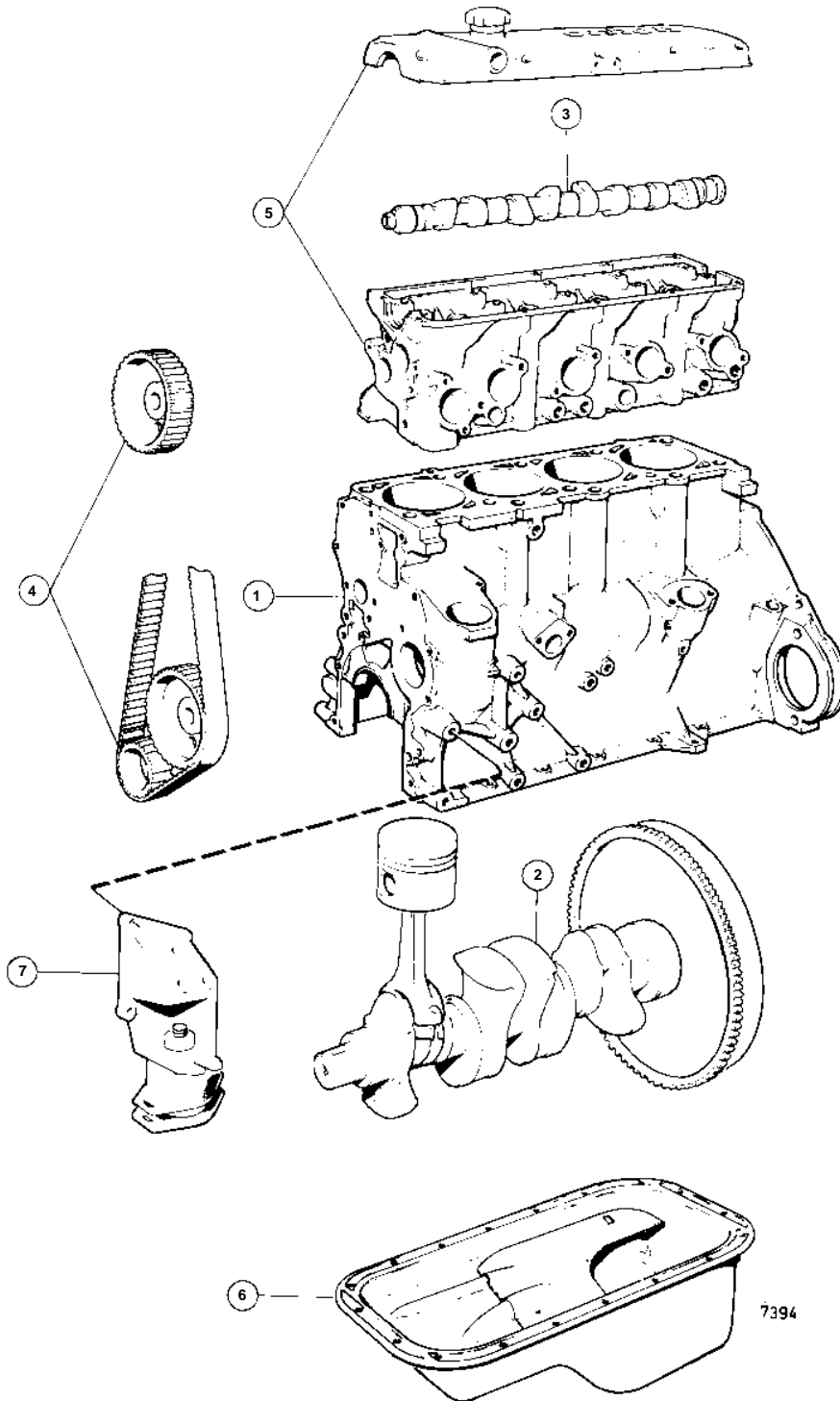

230A, 230B

REF	QTY	DESCRIPTION	SEE SEC.
1	1	CYLINDER BLOCK	11332
2	1	CRANKSHAFT AND RELATED PARTS	11334
3	1	CAMSHAFT AND VALVE MECHANISM	11336
4	1	BELT TRANSMISSION	11338
5	1	CYLINDER HEAD	11328
6	1	LUBRICATING SYSTEM	11326
7	1	ENGINE MOUNTS	11329