

AD41A

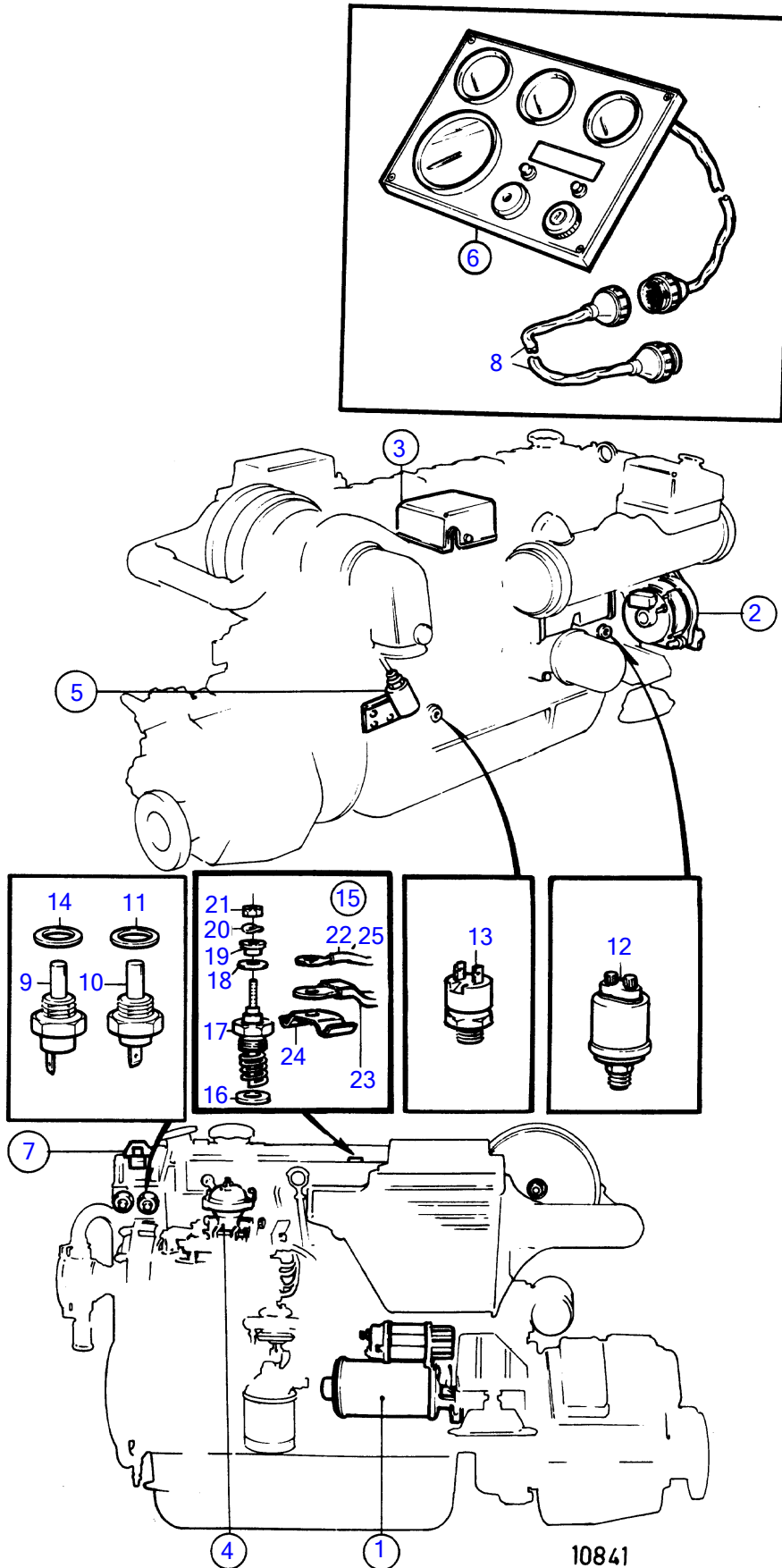

AD41A

REF	PART NO.	QTY	DESCRIPTION	SEE SEC.	NOTES
1		1	starter motor with installation components	19529	
2		1	alternator with installation components	19527	
3		1	electrical box with installation components	19558	
4		1	micro switch with installation components		For engines with wet exhaust line
5		1	solenoid with installation components	19543	
6	838809	1	Instrument panel, instrument panel		SN-2204108611
	858865	1	Instrument panel		SN2204108612-2204114999, Repl by 859099
	859099	1	Instrument panel		SN2204115000-2204126822, Repl by 864040
	864040	1	Instrument panel		12V, SN2204126823-
7		1	relay with installation components	19548	
8	846648	X	Extension cable\verl		CPC, L=3000mm
	846649	X	Extension cable\verl		CPC, L=5000mm
	846650	X	Extension cable\verl		CPC, L=7000mm
9	833927	1	Thermo monitor		12V,93°C
10	827151	1	Temperature sensor		12V,40-120°C
11	957181	1	Gasket		
12	843231	1	Oil pressure sensor		12V
13	864284	1	Pressure monitor		(848367)
14	957181	1	Gasket		
15	876132	1	Glow plug		
16	859211	1	• Sealing ring		
17	3581635	2	• Glow plug		
18		1	• o-ring		Not to be used where contact plate 860044 shall be used.
19	859328	1	• Thrust sleeve		
20	941905	1	• Spring washer		
21	965483	1	• Flange nut		
22	860173	1	Cable kit		Product no.867975,867976,868082,868421,868422,868425, 868426,868433
23	859450	1	Rail		
24	860044	1	Switch brace		

7745630-30-19553C

10841

Upd:2011-09-27