

AQAD41A

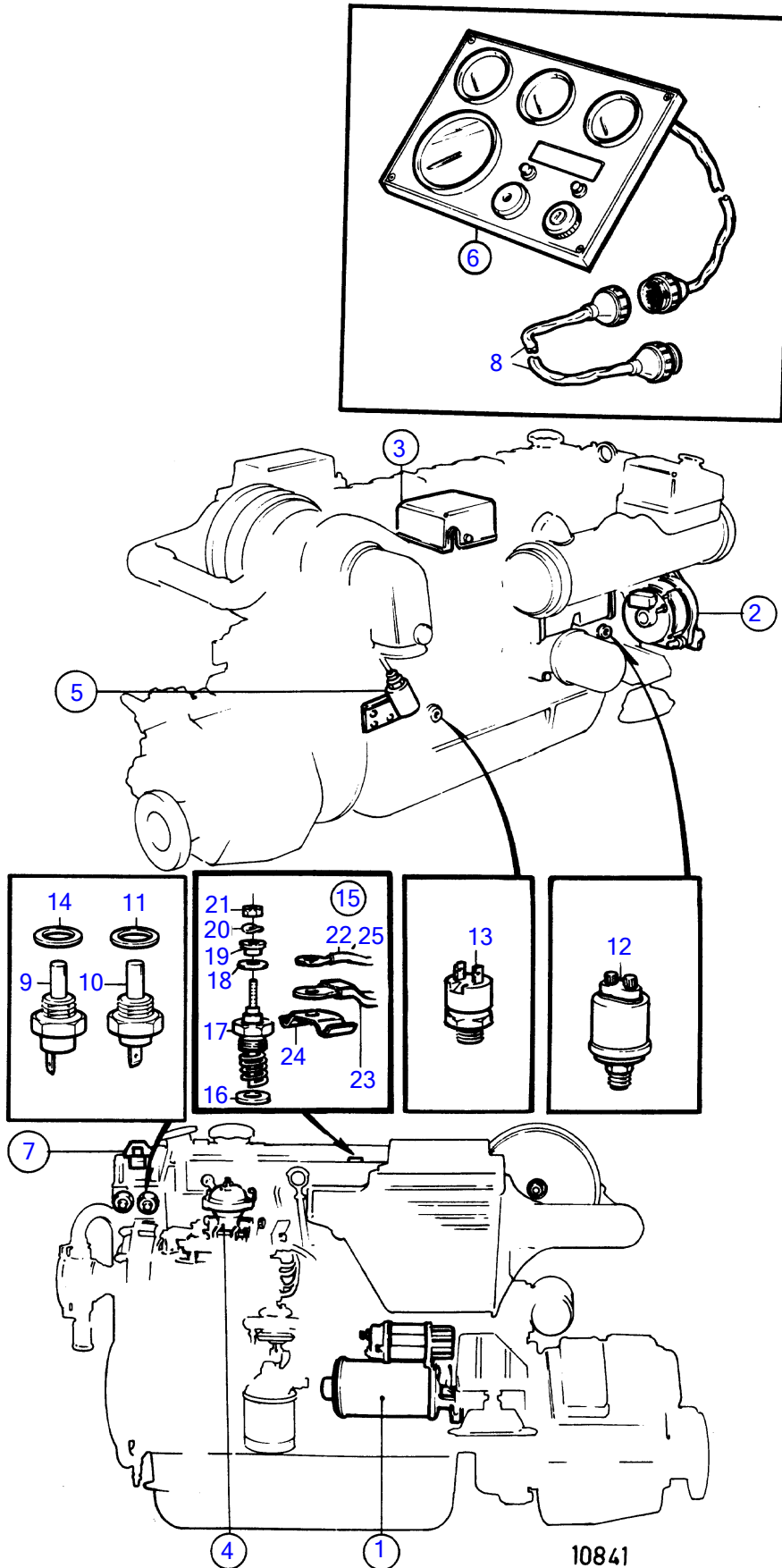

AQAD41A

| REF | PART NO. | QTY | DESCRIPTION | SEE SEC. | NOTES |
|-----|----------|-----|---|----------|---|
| 1 | | 1 | starter motor with installation components | 19529 | |
| 2 | | 1 | alternator with installation components | 19527 | |
| 3 | | 1 | electrical box with installation components | 19558 | |
| 4 | | 1 | micro switch with installation components | | For engines with wet exhaust line |
| 5 | | 1 | solenoid with installation components | 19543 | |
| 6 | 838809 | 1 | Instrument panel, instrument panel | | SN-2204108611 |
| | 858865 | 1 | Instrument panel | | SN2204108612-2204114999, Repl by 859099 |
| | 859099 | 1 | Instrument panel | | SN2204115000-2204126822, Repl by 864040 |
| | 864040 | 1 | Instrument panel | | 12V, SN2204126823- |
| 7 | | 1 | relay with installation components | 19548 | |
| 8 | 846648 | X | Extension cable\verl | | CPC, L=3000mm |
| | 846649 | X | Extension cable\verl | | CPC, L=5000mm |
| | 846650 | X | Extension cable\verl | | CPC, L=7000mm |
| 9 | 833927 | 1 | Thermo monitor | | 12V,93°C |
| 10 | 827151 | 1 | Temperature sensor | | 12V,40-120°C |
| 11 | 957181 | 1 | Gasket | | |
| 12 | 843231 | 1 | Oil pressure sensor | | 12V |
| 13 | 864284 | 1 | Pressure monitor | | (848367) |
| 14 | 957181 | 1 | Gasket | | |
| 15 | 876132 | 1 | Glow plug | | |
| 16 | 859211 | 1 | • Sealing ring | | |
| 17 | 3581635 | 2 | • Glow plug | | |
| 18 | | 1 | • o-ring | | Not to be used where contact plate 860044 shall be used. |
| 19 | 859328 | 1 | • Thrust sleeve | | |
| 20 | 941905 | 1 | • Spring washer | | |
| 21 | 965483 | 1 | • Flange nut | | |
| 22 | 860173 | 1 | Cable kit | | Product no.867975,867976,868082,868421,868422,868425, 868426,868433 |
| 23 | 859450 | 1 | Rail | | |
| 24 | 860044 | 1 | Switch brace | | |

7745630-30-19553B

10841

Upd:2011-09-27