

TMD122A, TAMD122A, TAMD122P-A, TAMD122P-B, TAMD122P-C

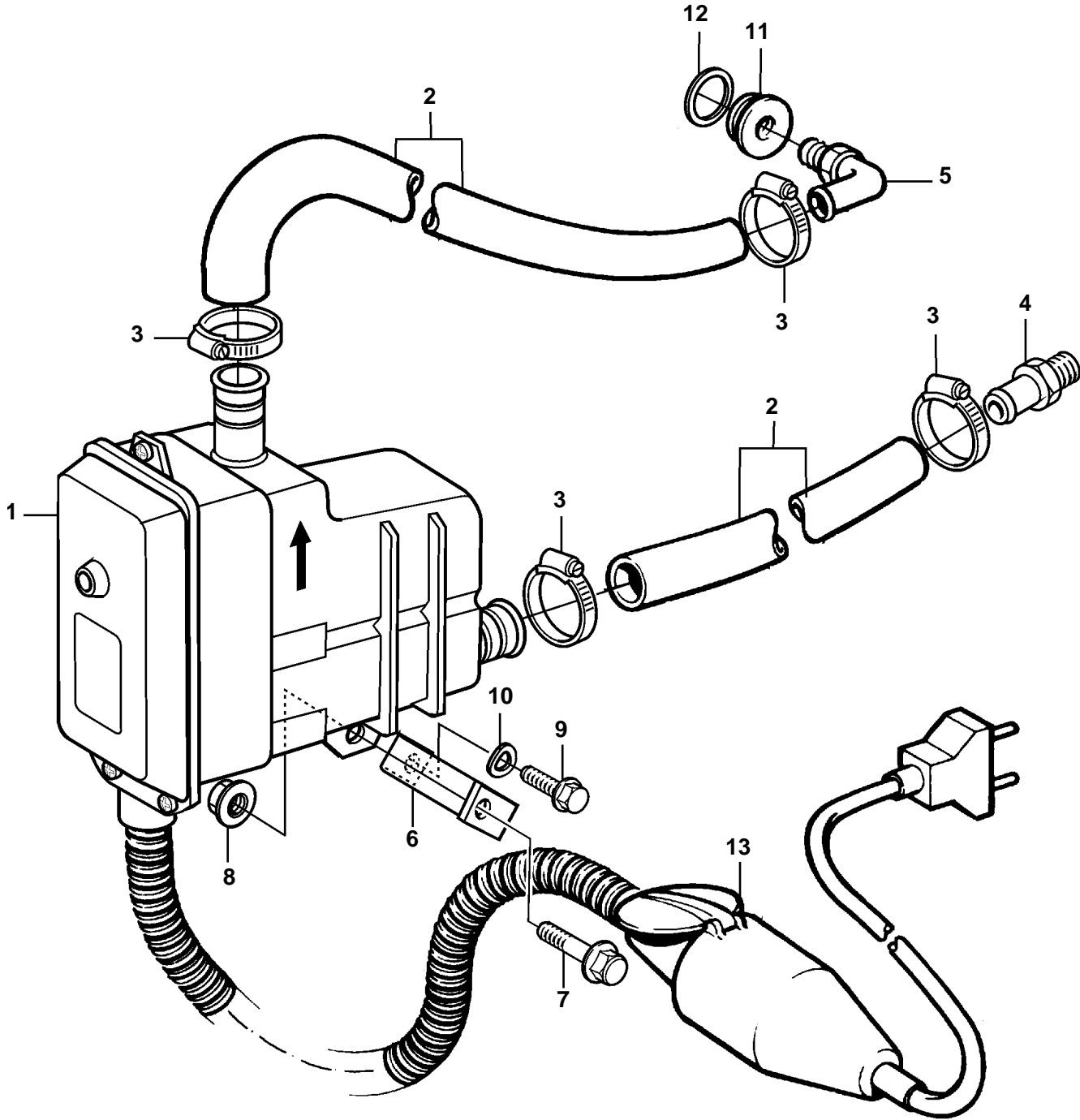

TMD122A, TAMD122A, TAMD122P-A, TAMD122P-B, TAMD122P-C

REF	PART NO.	QTY	DESCRIPTION	NOTES
1	865077	1	Engine heater, 2000W	
2	943369	X	Hose	L=620mm
3	943473	4	Hose clamp	
4	479974	1	Nipple	
5	942590	1	Elbow union	
6	846912	1	Bracket	
7	946173	1	Flange screw	
8	948645	1	Lock nut	
9	955559	1	Screw	
10	940280	1	Spring washer	
11	821335	1	Plug	
12	469328	1	Gasket	
13			Connector	