

TAMD103A-A, TMD122A, TAMD122A, TAMD122P-A, TAMD122P-B, TAMD122P-C

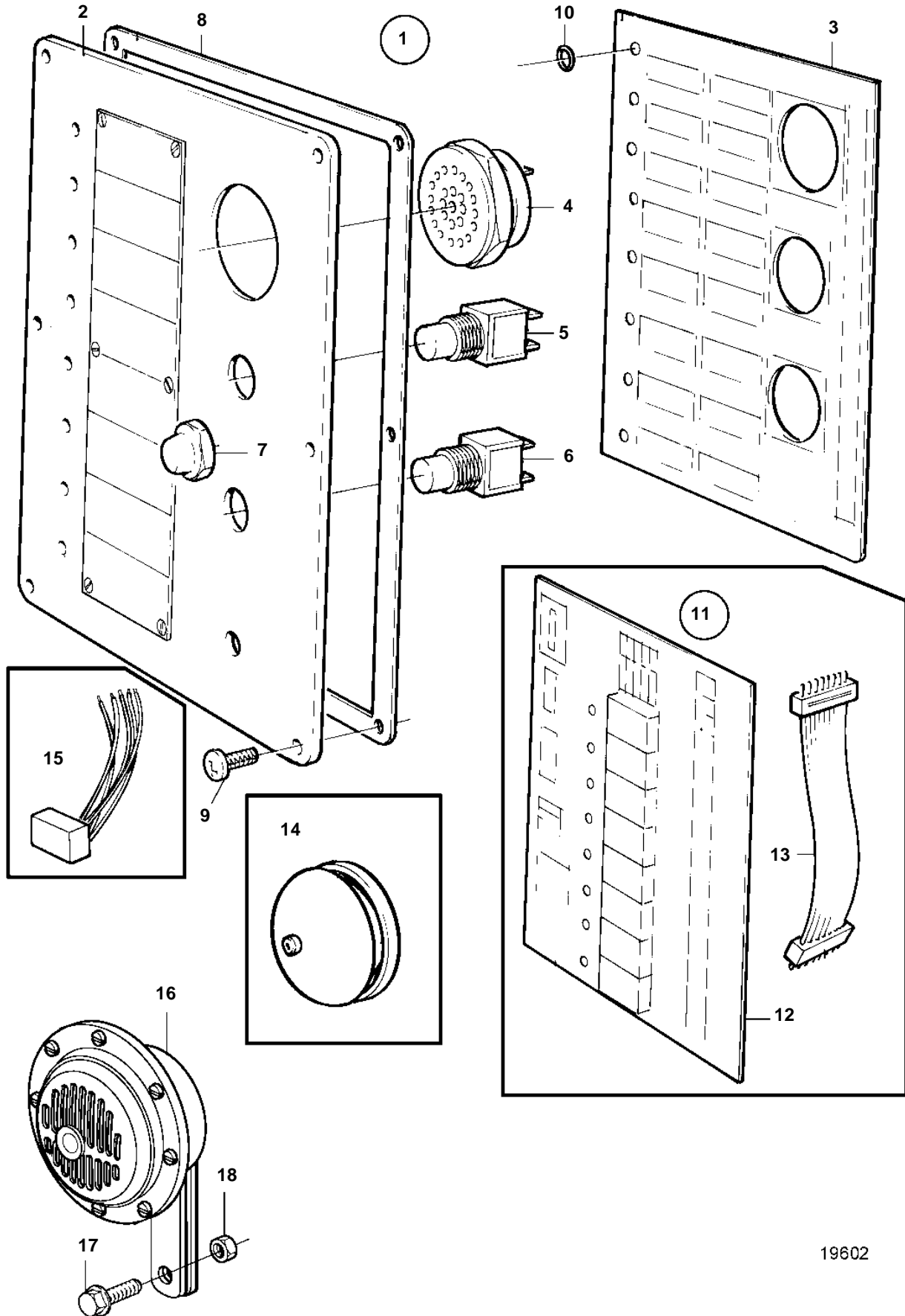

19602

TAMD103A-A, TMD122A, TAMD122A, TAMD122P-A, TAMD122P-B, TAMD122P-C

REF	PART NO.	QTY	DESCRIPTION	NOTES
1	862753	1	Alarm panel	REPL BY 873785
	873785	1	Electronic unit	
	862935	1	· Alarm panel	REPL BY 873785
2	862317	1	· · Front plate	REPL BY 873785
3	862739	1	· · Circuit board	REPL BY 873785
4	828587	1	· · Buzzer	
5	862719	1	· · Switch	
6	828584	1	· · Switch	
7	828586	2	· · Nut	
8	862331	1	· · Gasket	
9	862217	6	· · Screw	
10	955978	9	· · Rubber ring	
11	862793	1	Circuit board	
12		1	· Circuit board	
13		1	· Connecting cable	
14	881806	1	Bell	(823214)
15	863043	1	Interlock box	
16	874050	1	Horn	
17	946440	1	Flange screw	
18	948645	1	Lock nut	