

TMD121C, TAMD121C, TAMD121D

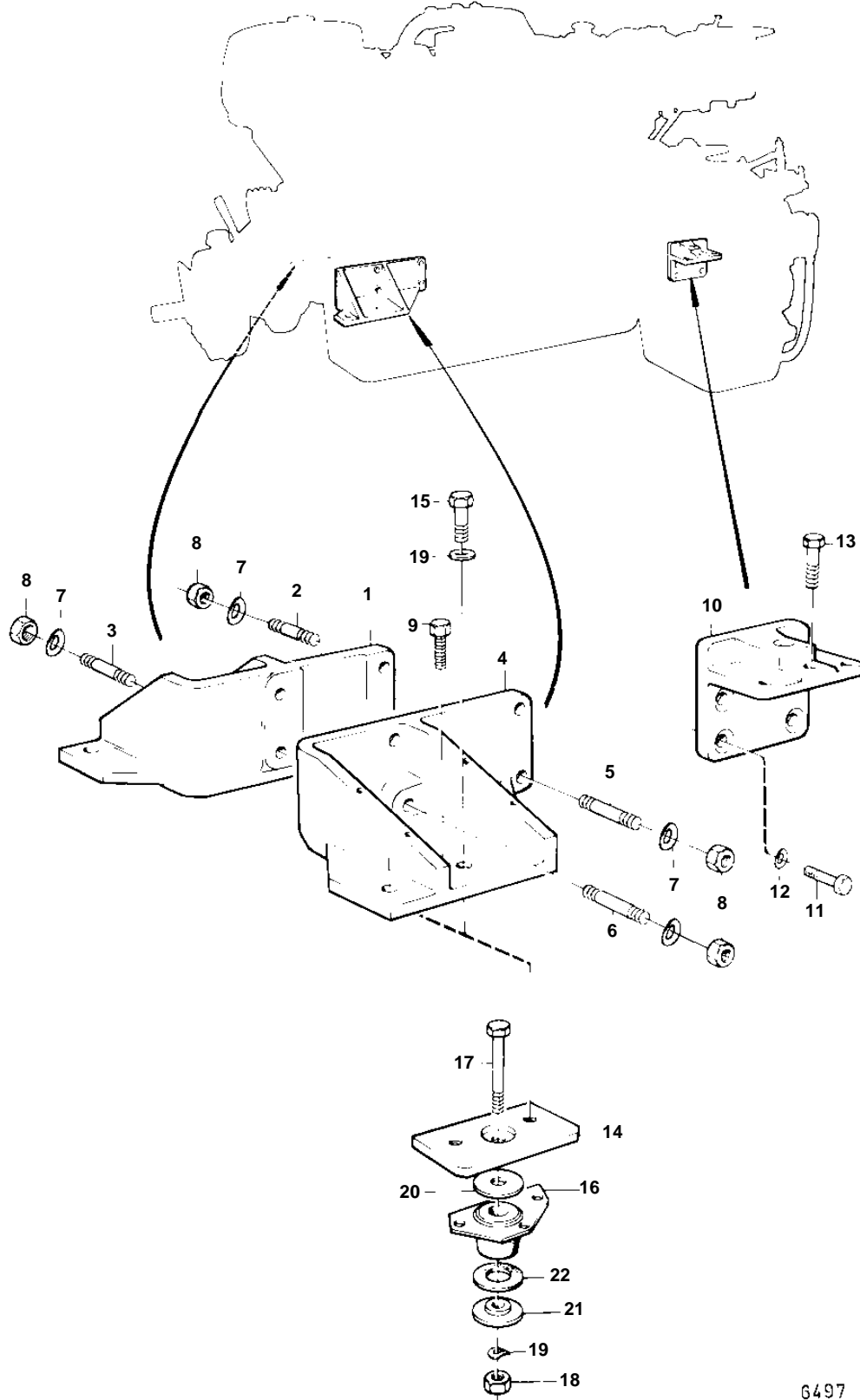

TMD121C, TAMD121C, TAMD121D

REF	PART NO.	QTY	DESCRIPTION	SEE SEC.	NOTES
1	820633	1	Bracket		S.B. Replaced by bracket 862473 + screw 970971 M12.
	837587	1	Bracket		S.B PTO 11,5. Replaced by bracket 862473 + screw 970971 M12.
2	953351	3	Stud		L=70mm
3	953346	1	Stud		L=55mm
4	823584	1	Bracket		P. Replaced by bracket 862474 + screw 970971 M12.
	837477	1	Bracket		P PTO 11,5. Replaced by bracket 862474 + screw 970971 M12.
5	953346	3	Stud		L=55mm
6	953351	1	Stud		L=70mm
7	941911	8	Spring washer		
8	955828	8	Nut		
9	955561	2	Screw		1/2"
10	821685	2	Engine bracket		
11	960737	8	Screw		
12	940280	8	Spring washer		
13	955591	2	Screw		
14	824374	4	Intermediate plate		
15	955589	8	Screw		
16	836961	4	Rubber element	1487	
17	959827	4	Screw		
18	955829	4	Nut		
19	941912	12	Spring washer		
20	836325	4	Washer		
21	862066	4	Washer		
22		4	Rubber washer		Rubber washer and steel washer (earlier model) replaced by complete washer 862066.