

TMD121C, TAMD121C, TAMD121D, TAMD122C, TAMD122D

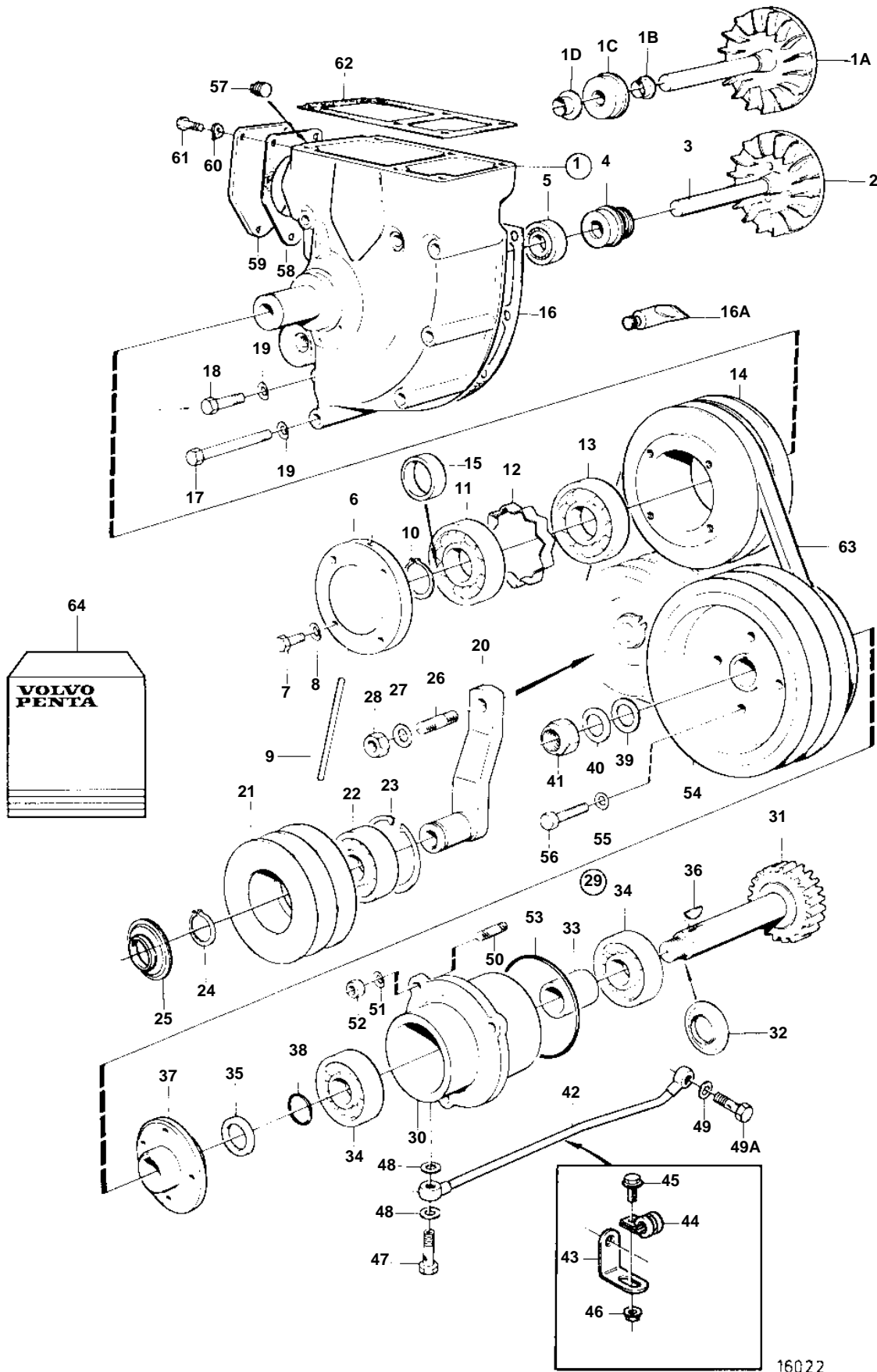

16022

TMD121C, TAMD121C, TAMD121D, TAMD122C, TAMD122D

REF	PART NO.	QTY	DESCRIPTION	SEE SEC.	NOTES
1	875648	1	Water pump		SN-XXXXXXXXXXXX/213479
	866585	1	Water pump		SNXXXXXXXXXXXX/213480-
	3803213	1	Circ. pump, exch		Exchange unit
1A	823484	1	· Shaft		FOR 875648
1B	421306	1	· Wear ring		FOR 875648
1C	1545283	1	· Sealing ring		FOR 875648
1D	70913	1	· Deflector		FOR 875648
2	8121826	1	· Impeller		FOR 866585
3	421082	1	· Shaft		FOR 866585
4	1676432	1	· Sealing ring		FOR 866585
5	1660609	1	· Ball bearing		
6	836805	1	· Companion flange		
7	940159	4	· Screw		
8	941907	4	· Spring washer		
9	951969	1	· Pin		
10	914462	1	· Lock ring		
11	1542870	1	· Ball bearing		
12	422202	1	· Spacer sleeve		
13	181538	1	· Ball bearing		
14	822548	1	· Pulley		
15	1542871	1	· Spacer sleeve		
16	423351	1	Gasket		
16A	1161231	X	Sealant		
17	955542	2	Screw		
18	955536	5	Screw		
19	942336	7	Spring washer		
20	822567	1	Adjuster arm, belt tensioner		
21	822551	1	Pulley		
22	1544092	1	Ball bearing		
23	914533	1	Snap ring		
24	914462	1	Lock ring		
25	420416	1	Protecting plate		
26	953353	1	Stud		
27	941911	1	Spring washer		
28	955828	1	Nut		
29	837702	1	Drive outlet		
30	837703	1	· Bearing housing		
31	837704	1	· Gear		
32	837705	1	· Oil deflector		
33	837706	1	· Spacer sleeve		
34	183731	2	· Ball bearing		
35	958856	1	· Sealing ring		
36	909867	1	· Key		
37	837707	1	· Hub		
38	190418	1	· O-ring		
39	947170	1	· Gasket		
40	837708	1	· Washer		
41	949399	1	· Nut		
42		1	Tube	2511	
43	468850	1	Attaching plate		
44	952622	1	Clamp		
45	946544	1	Flange screw		
46	945407	1	Flange nut		
47	844625	1	Hollow screw, cylinder block		
48	947620	2	Gasket		
49	11994	2	Gasket		
49A	837709	1	Hollow screw		
50	953257	1	Stud		L=35mm
	953280	2	Stud		L=120mm
51	942336	3	Spring washer		
52	955827	3	Nut		
53	949660	1	O-ring		
54	842769	1	Pulley		

