

TAMD70D,AQD70D

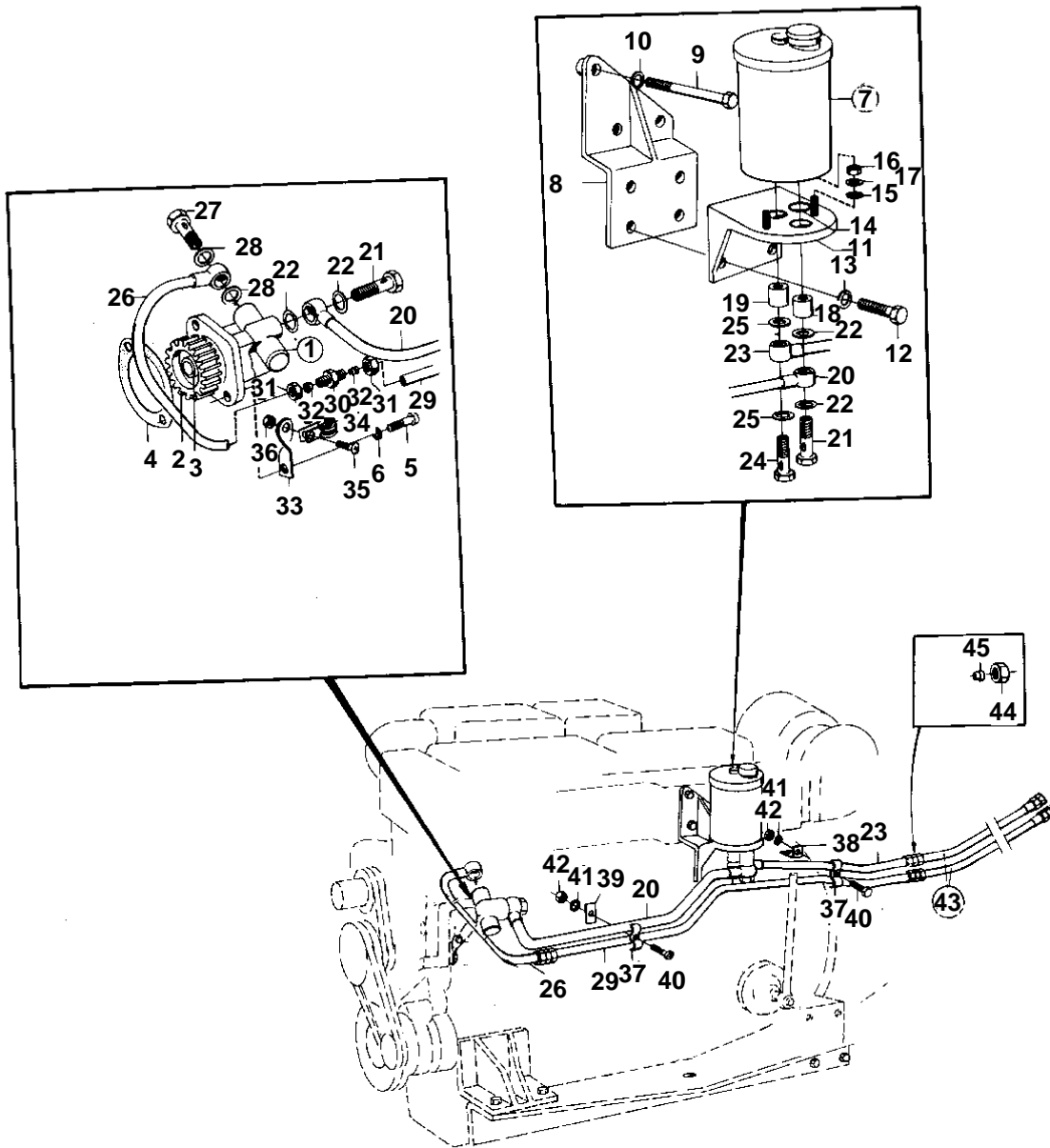

5183

HYDRAULIC PUMP AND OIL RESERVOIR AND INSTALLATION COMPONENTS

060

TAMD70D,AQD70D

| REF | PART NO. | QTY | DESCRIPTION | SEE SEC. | NOTES |
|-----|----------|-----|-------------------|----------|--------------|
| 1 | 356506 | 1 | Hydraulic pump | | |
| | | | | 060-0400 | |
| 2 | 421087 | 1 | Gear | | |
| 3 | 346918 | 1 | Nut | | |
| 4 | 421187 | 1 | Gasket | | |
| 5 | 956586 | 2 | Screw | | |
| 6 | 942336 | 2 | Spring washer | | |
| 7 | 327194 | 1 | Reservoir | | |
| | | | | 060-0500 | |
| 8 | 836478 | 1 | Bracket | | |
| 9 | 941251 | 3 | Screw | | |
| 10 | 942336 | 3 | Spring washer | | |
| 11 | 328378 | 1 | Bracket | | |
| 12 | 940115 | 4 | Screw | | |
| 13 | 942336 | 4 | Spring washer | | |
| 14 | 328382 | 2 | O-ring | | |
| 15 | 328381 | 2 | O-ring | | |
| 16 | 955782 | 2 | Nut | | |
| 17 | 941907 | 2 | Spring washer | | |
| 18 | 328379 | 1 | Connection sleeve | | |
| 19 | 328380 | 1 | Connection sleeve | | |
| 20 | 836683 | 1 | Tube | | |
| 21 | 191620 | 2 | Hollow screw | | |
| 22 | 907132 | 4 | Gasket | | |
| 23 | 837349 | 1 | Tube | | |
| 24 | 26013 | 1 | Hollow screw | | |
| 25 | 957181 | 2 | Gasket | | |
| 26 | 837347 | 1 | Tube | | |
| 27 | 190713 | 1 | Hollow screw | | |
| 28 | 11996 | 2 | Gasket | | |
| 29 | 843983 | 1 | Tube | | |
| 30 | 957056 | 1 | Nipple | | |
| 31 | 956984 | 2 | Nut | | |
| 32 | 956970 | 2 | Ferrule | | |
| 33 | 825629 | 1 | Bracket | | |
| 34 | 952627 | 1 | Clamp | | |
| 35 | 950046 | 1 | Screw | | |
| 36 | 950352 | 1 | Lock nut | | |
| 37 | 836671 | 2 | Clamp | | |
| 38 | 843233 | 1 | Anchorage | | |
| 39 | 824570 | 1 | Washer | | |
| 40 | 950046 | 2 | Screw | | |
| 41 | 941906 | 2 | Spring washer | | |
| 42 | 950352 | 2 | Lock nut | | |
| 43 | 832394 | 2 | Hose | | SEE GROUP 4A |
| 44 | 956985 | 2 | · Nut | | |
| 45 | 956970 | 2 | · Ferrule | | |