

TAMD61A

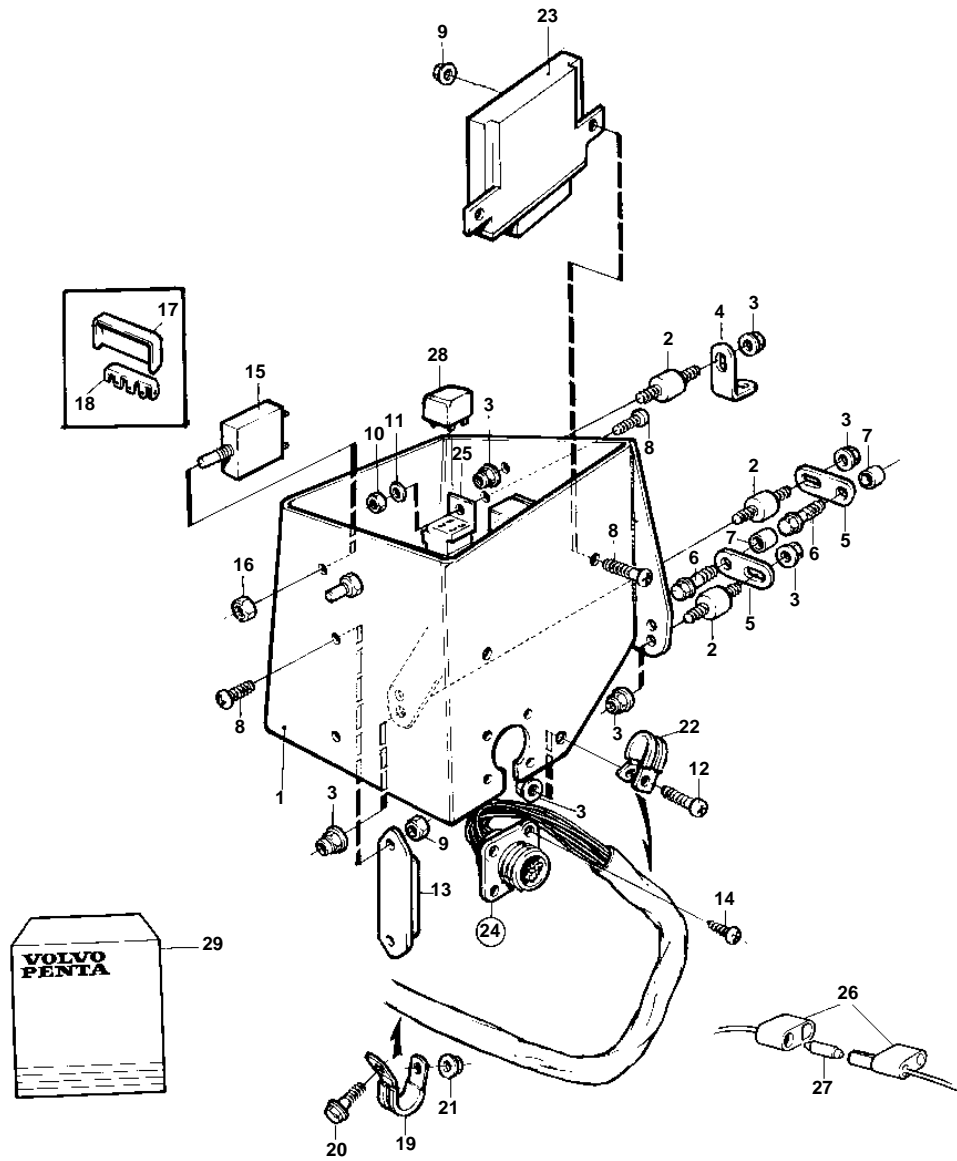

15528

TAMD61A

| REF | PART NO. | QTY | DESCRIPTION    | NOTES                            |
|-----|----------|-----|----------------|----------------------------------|
| 1   | 866128   | 1   | Cover          | Included in kit 876679.          |
| 2   | 3574797  | 3   | Rubber cushion | Included in kit 876679.          |
| 3   | 945407   | 7   | Flange nut     | M6. Included in kit 876679.      |
| 4   | 965555   | 1   | Bracket        | Included in kit 876679.          |
| 5   | 965534   | 2   | Bracket        | Included in kit 876679.          |
| 6   | 948217   | 2   | Flange screw   | Included in kit 876679.          |
| 7   | 821539   | 2   | Spacer sleeve  | Included in kit 876679.          |
| 8   | 967378   | 6   | Screw          | M5x10. Included in kit 876679.   |
| 9   | 965483   | 4   | Nut            | M5. Included in kit 876679.      |
| 10  | 955780   | 2   | Nut            | M5. Included in kit 876679.      |
| 11  | 941905   | 4   | Spring washer  | Included in kit 876679.          |
| 12  | 967390   | 1   | Screw          | M6x12mm. Included in kit 876679. |
| 13  | 1234048  | 1   | Lower section  | Included in kit 876679.          |
| 14  | 945761   | 4   | Screw          | Included in kit 876679.          |
| 15  | 966689   | 2   | Fuse           |                                  |
| 16  |          | 2   | · Nut          |                                  |
| 17  | 1234264  | 1   | Upper section  |                                  |
| 18  | 1234263  | 1   | Pin            |                                  |
| 19  | 949747   | 1   | Clamp          |                                  |
| 20  | 946440   | 1   | Flange screw   |                                  |
| 21  | 955781   | 1   | Nut            |                                  |
| 22  | 952630   | 1   | Clamp          |                                  |
| 23  | 863481   | 1   | Timer relay    |                                  |
| 24  | 862860   | 1   | Cable trunk    |                                  |
| 25  | 977184   | 2   | · Tab housing  |                                  |
| 26  | 966334   | 1   | · Fuse holder  |                                  |
| 27  | 942785   | 1   | Fuse           | 12V, 16A                         |
|     | 11433    | 1   | Fuse           | 24V, 8A                          |
| 28  | 876039   | 2   | Relay kit      | 12V, START-STOP                  |
|     | 8153600  | 2   | Relay          | 24V, START-STOP,(1504951)        |
| 29  | 876679   | 1   | Conversion kit |                                  |