

TAMD162A, TAMD162C, TAMD162C-B

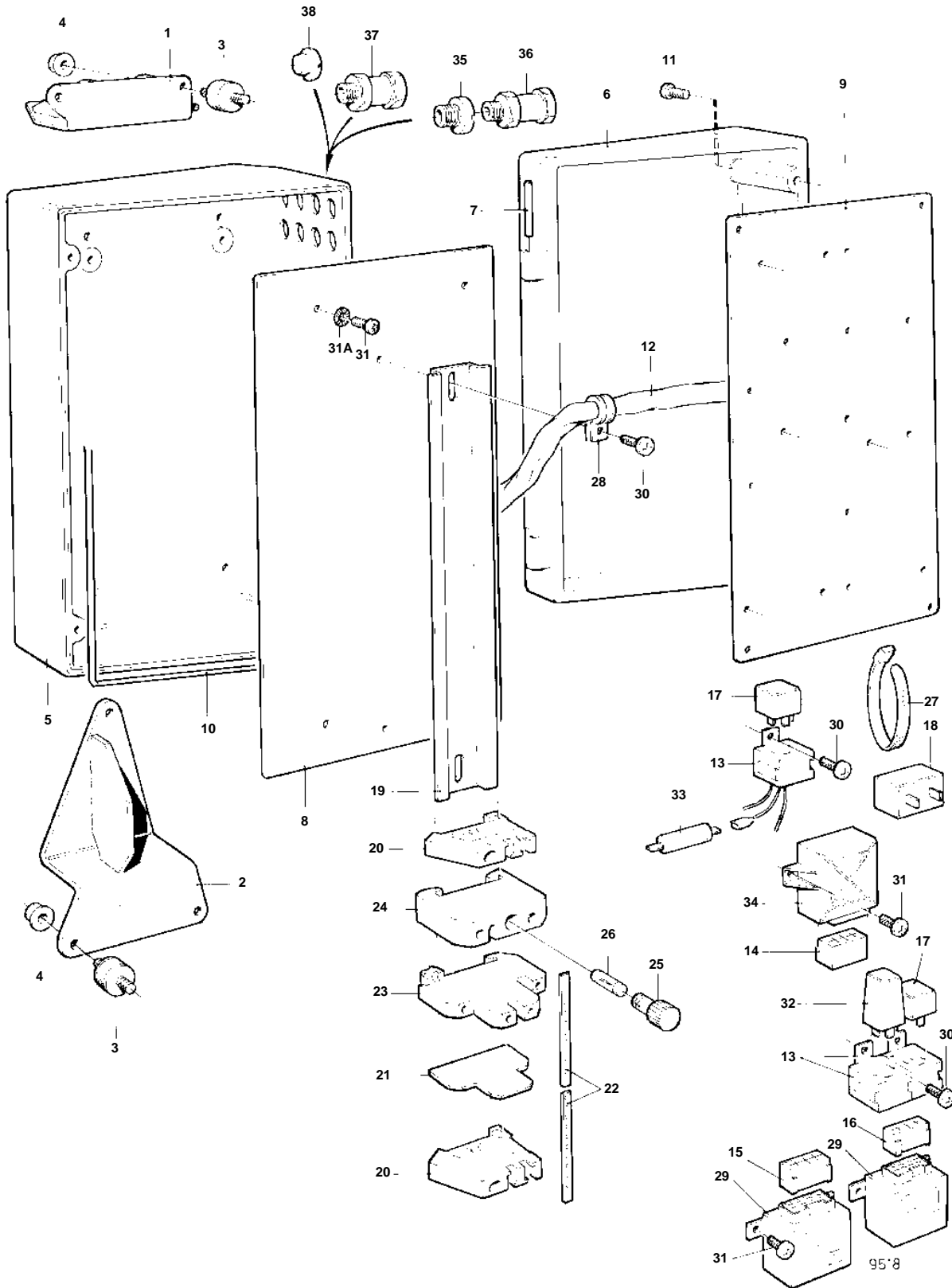

TAMD162A, TAMD162C, TAMD162C-B

REF	PART NO.	QTY	DESCRIPTION	NOTES
1	849947	1	Anchorage	
2	849946	1	Anchorage	
3	863415	4	Rubber cushion	
4	945408	4	Flange nut	
5	862742	1	Box	
6	862148	1	Cover	
7		2	Spring pin	
8		1	Plate	
9	862147	1	Plate	
10		X	Sealing strip	L=1222mm
11	969423	2	Screw	(956097)
12		1	Wiring harness	
13	977184	8	· Tab housing	(946556)
14	944076	1	· Receptacle housing	
15		1	· Housing	
16	944076	1	· Receptacle housing	
17	9518230	7	Relay	(4786690)
18	837722	1	Resistor	
19		1	Rail	
20		2	End piece	
21		1	End plate	
22		2	Brace	
23	862862	26	Plinth	
24		4	Fuse board	
25		4	· Fuse holder	
26	862962	4	Fuse	8A
27	948211	6	Strip clamp	(948210)
28	952635	1	Clamp	
29	873140	2	Race gard	
30	956074	8	Screw	L=8mm
31	956091	14	Screw	L=10mm
31A	942605	1	Lock washer	
32	862850	1	Voltage sensor	
33	1578857	2	Diode, overspeed protection	
34	873788	1	Electronic unit, exhaust	
35	862885	1	Reducer sleeve, exhaust	
36	881190	1	Cable union, exhaust	
37	844576	X	Cable union	9,5-12,0mm PR 18,6
	881191	X	Cable union	7,5-10,5mm PR 18,6
	881192	X	Cable union	12,5-15,0mm PR 22,5
	881193	X	Cable union	16,5-19,5mm PR 28,3
38		X	Plug	PR 18,6
	843903	X	Plug	PR 22,5
	843904	X	Plug	PR 28,3