

TAMD162A, TAMD162C

1

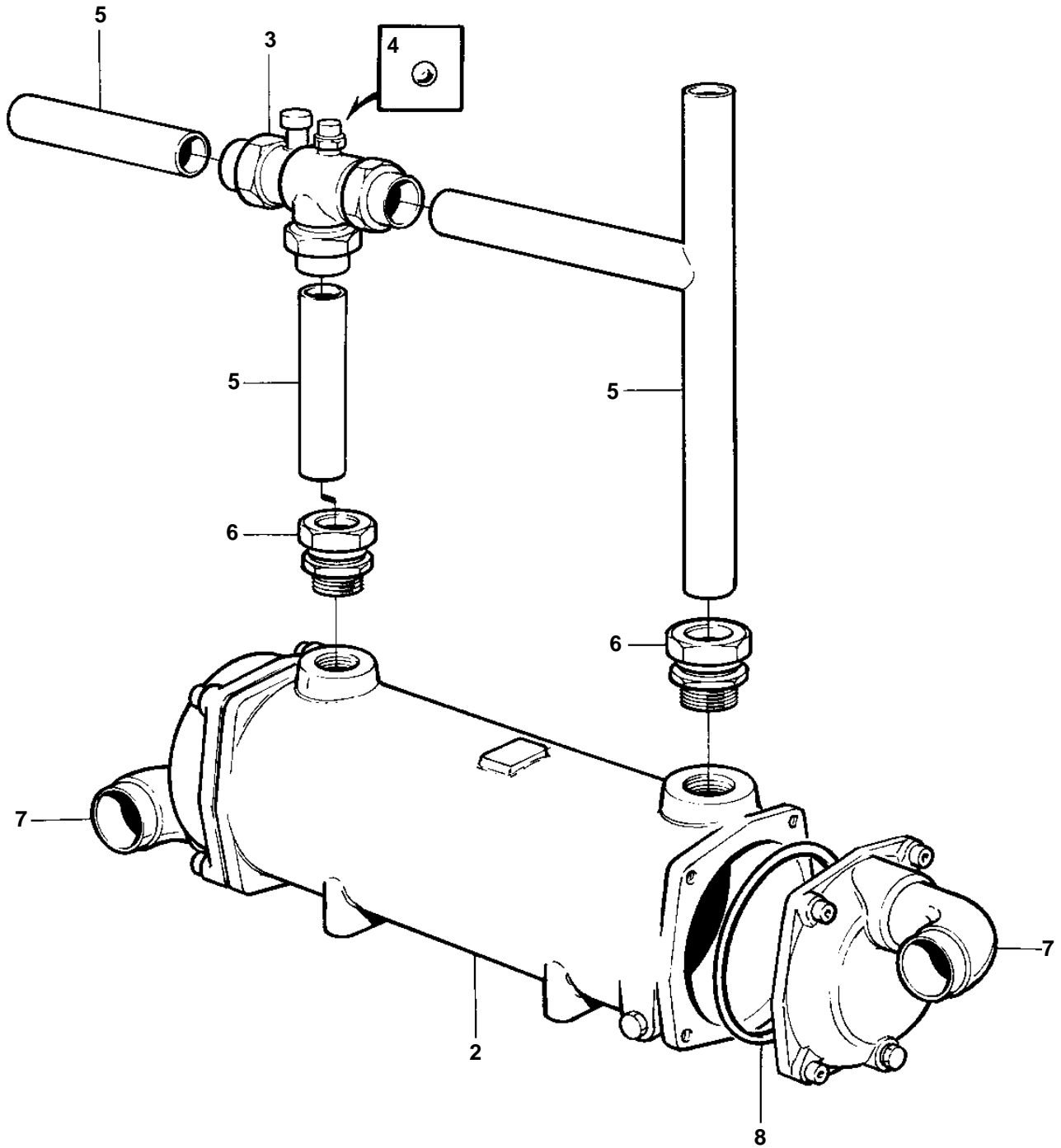

11042

TAMD162A, TAMD162C

REF	PART NO.	QTY	DESCRIPTION	
1		1	Heat exchanger	
2	864956	1	· Heat exchanger	
3	864552	1	· Regulator	SO
4	181332	1	· Steel ball	
5		X	· Copper tube	
6		2	· Nipple	
7	813644	2	· Hose attachment	
8	864740	2	· Sealing ring	