

TAMD162A, TAMD162C

1

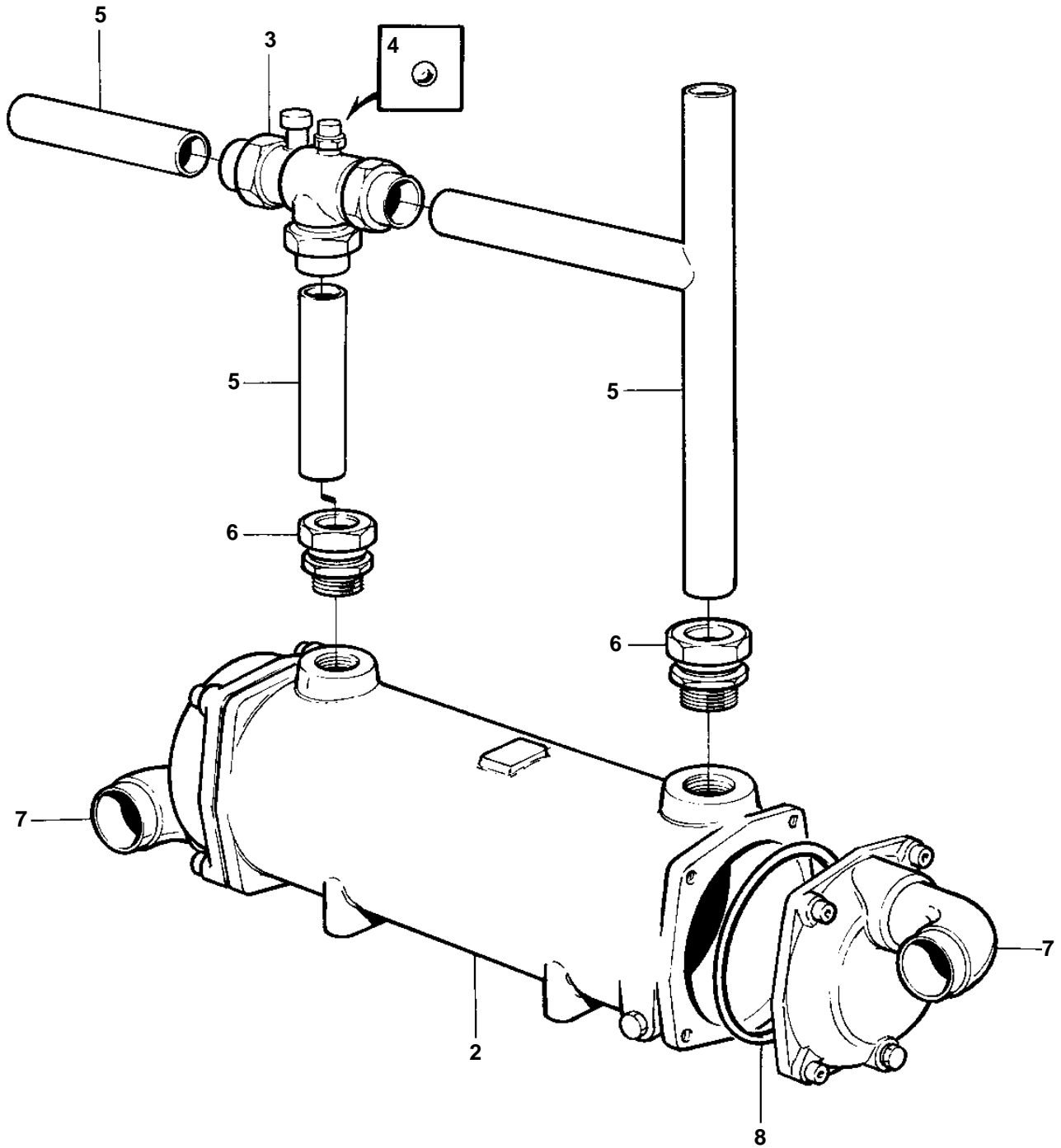

11042

TAMD162A, TAMD162C

REF	PART NO.	QTY	DESCRIPTION	NOTES
1		1	Central radiator	REPL BY 864955
2	864551	1	• Heat exchanger	REPL BY 864956
3	864552	1	• Regulator	SO
4	181332	1	• Steel ball	
5		X	• Copper tube	
6		2	• Nipple	
7	813644	2	• Hose attachment	
8	864740	2	• Sealing ring	