

TAMD103A-A

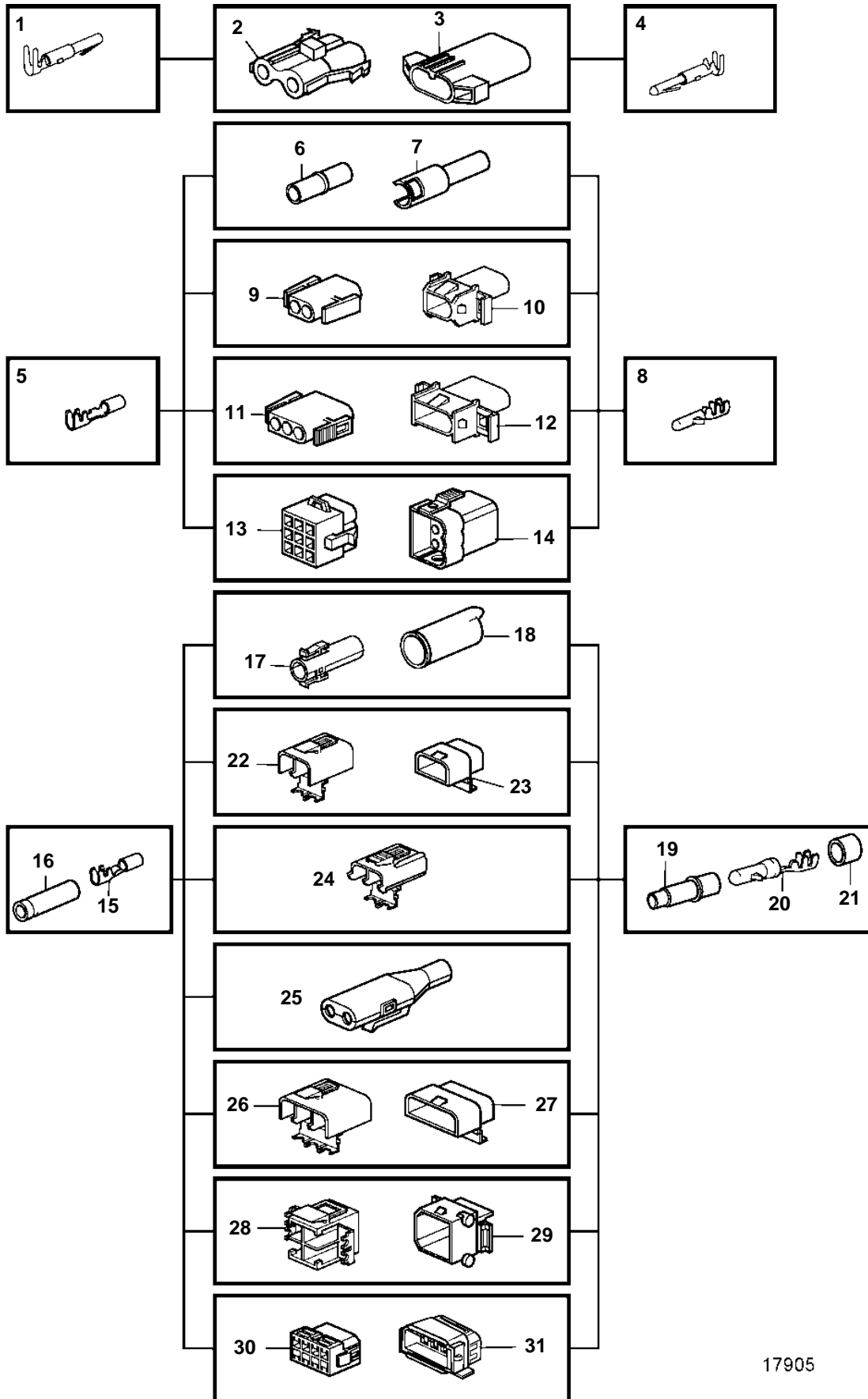

17905

TAMD103A-A

REF	PART NO.	DESCRIPTION		NOTES
1	946038	Cable terminal		2,1x0,5-1mm2
2	944224	Receptacle housing		2-POLE
3	944223	Receptacle housing		2-POLE
4		Cable terminal		2,1x0,5-1mm2. Not marketed by Volvo Penta.
5	965822	Cable terminal		3,5x1,1-2,5sq.mm
	948289	Cable terminal		3,5x2,5-4,0sq.mm
6	949584	Insulator	SO	3,5x1 NATURAL
7	949583	Insulator	SO	3,5x1 NATURAL
8	969831	Cable terminal		3,5x0,5-1mm2
	965824	Cable terminal		3,5x1,1-2,5sq.mm
	965825	Cable terminal		3,5x2,6-4,0sq.mm
9	948996	Receptacle housing		3,5x2 NATURAL
10	948995	Tab housing		3,5x2 NATURAL
11	948296	Housing		3,5x3 NATURAL
12	948297	Insulator	SO	3,5x3 NATURAL
13	948294	Receptacle housing		3,5x9 NATURAL
14	948295	Tab housing		3,5x9 NATURAL
15	949371	Cable terminal		3,5x0,75-1,5mm2
		Cable terminal		3,5x2,5-4,5sq.mm
16	1598753	Isolator		
17	1307035	Insulator	SO	1-POLE
18	1308436	Insulator	SO	1-POLE
19	1608765	Isolator		
20	965824	Cable terminal		3,5x2,5-4,5sq.mm
21	1608766	Seal		
22	1307048	Receptacle housing		2-POLE
23	1307049	Tab housing		2-POLE
24	970753	Receptacle housing		2-POLE
25	1624477	Switch		2-POLE
26	1259828	Housing		3-POLE
27	1259829	Housing		3-POLE
28	1259830	Receptacle housing		4-POLE
29	1259831	Housing		4-POLE
30	966812	Receptacle housing		8-POLE
31	967809	Pin housing		8-POLE