

TAMD103A-A, TAMD103A-A AUX

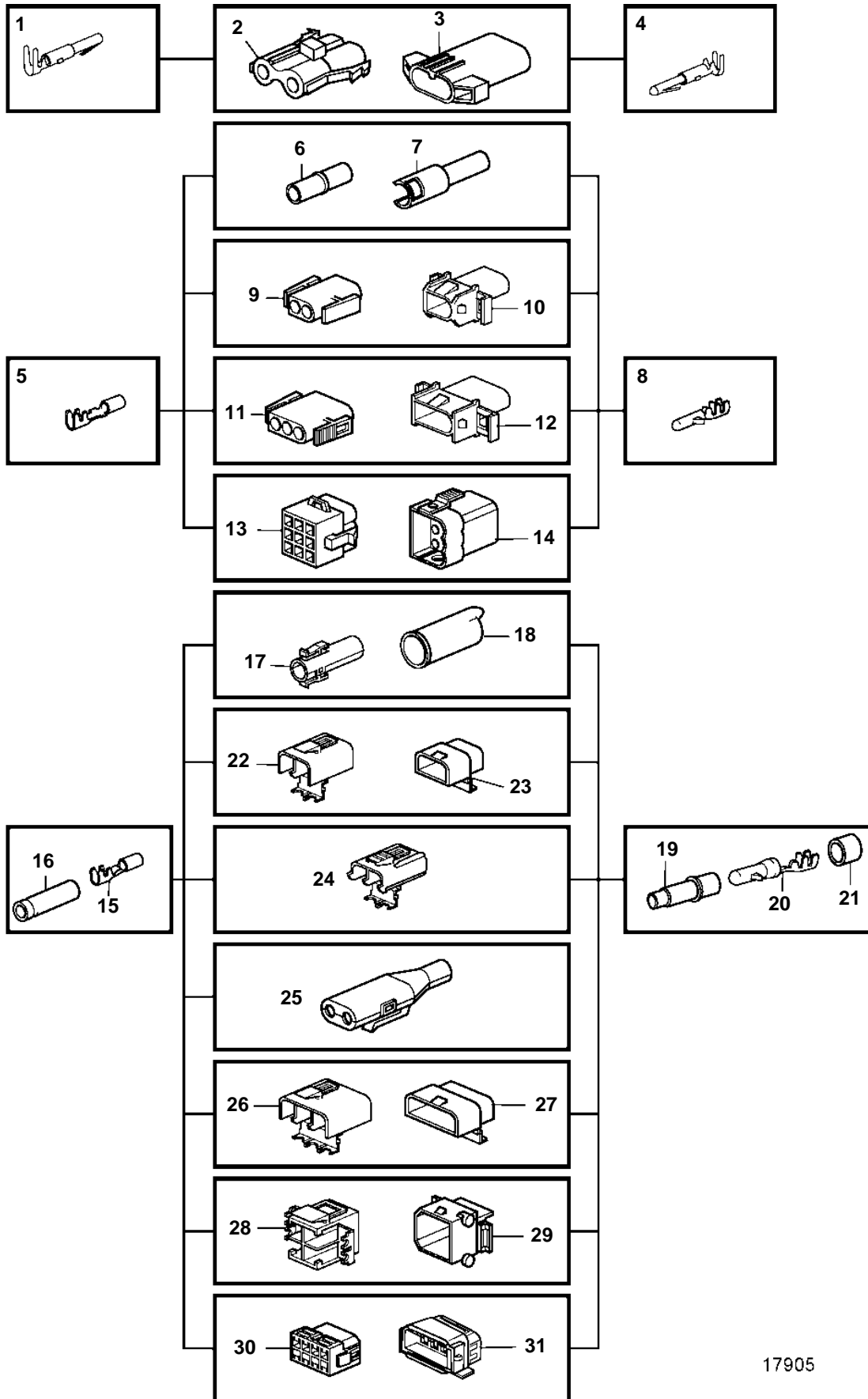

17905

TAMD103A-A, TAMD103A-A AUX

REF	PART NO.	DESCRIPTION	NOTES
1	946038	Cable terminal	2,1x0,5-1mm2
2	944224	Housing	2-POLE
3	944223	Housing	2-POLE
4		Cable terminal	Not marketed by Volvo Penta., 2,1x0,5-1mm2
5	965822	Cable terminal	3,5x1,1-2,5sq.mm
	948289	Cable terminal	3,5x2,5-4,0sq.mm
6	949584	Housing	3,5x1 NATURAL
7	949583	Housing	3,5x1 NATURAL
8	969831	Cable terminal	3,5x0,5-1mm2
	965824	Cable terminal	3,5x1,1-2,5sq.mm
	965825	Cable terminal	3,5x2,6-4,0sq.mm
9	948996	Housing	3,5x2 NATURAL
10	948995	Housing	3,5x2 NATURAL
11	948296	Housing	3,5x3 NATURAL
12	948297	Housing	3,5x3 NATURAL
13	948294	Housing	3,5x9 NATURAL
14	948295	Housing	3,5x9 NATURAL
15	949371	Cable terminal	3,5x0,75-1,5mm2
	1598753	Isolation	3,5x2,5-4,5sq.mm
16	1598753	Isolation	
17	1307035	Housing	1-POLE
18	1308436	Housing	1-POLE
19	1608765	Insulator	
20	965824	Cable terminal	3,5x2,5-4,5sq.mm
21	1608766	Seal	
22	1307048	Housing	2-POLE
23	1307049	Housing	2-POLE
24	970753	Housing	2-POLE
25	1624477	Insulator	2-POLE
26	1259828	Housing	3-pole
27	3523442	Pin housing	3-POLIG (1259829)
28	1259830	Housing	4-POLE
29	1259831	Housing	4-POLE
30	966812	Housing	8-POLE
31	967809	Housing	8-POLE