

AQD70C,AQD70CL

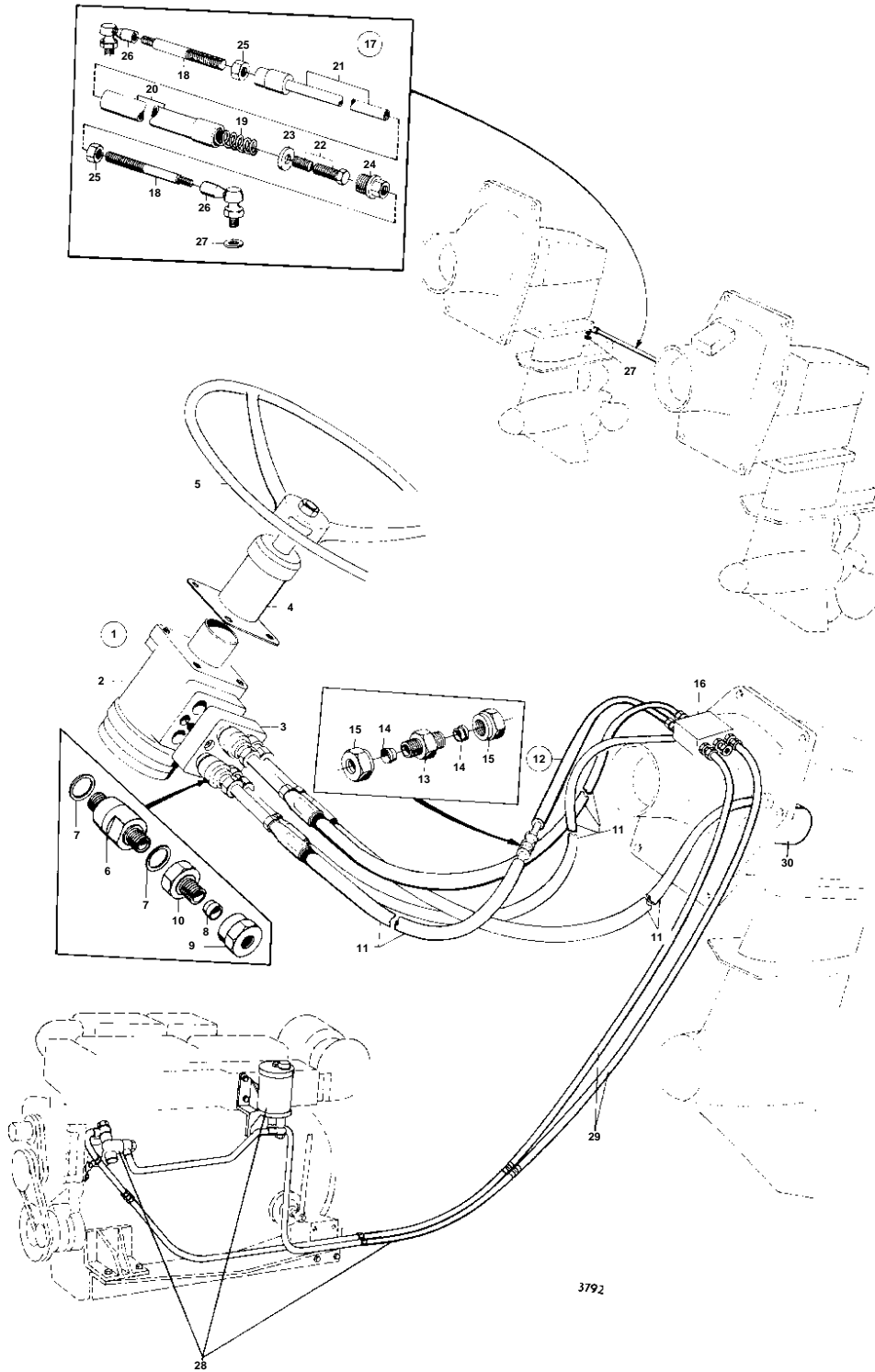

AQD70C,AQD70CL

REF	PART NO.	QTY	DESCRIPTION	SEE SEC.	NOTES
1	839088	1			SINGLE ENGINE INSTALLATION.
	850138	1	Control unit		TWIN ENGINE INSTALLATION.
	850137	1	Control unit		SINGLE ENGINE INSTALLATION.
2	839226	1	• Steering head		OSP80/150-001. SINGLE ENGINE INSTALLATION.. INCLUDED IN 839088.
	850134	1	• Steering head		OSPB80/150-0026. SINGLE ENGINE INSTALLATION.. INCLUDED IN 850137.
	839225	1	• Steering head		OSPA160/150-0003. TWIN ENGINE INSTALLATION.. INCLUDED IN 839229.
	850135	1	• Steering head		OSPB160/150-0043. TWIN ENGINE INSTALLATION.. INCLUDED IN 850138.
3	839227	1	• Valve body		OVP10/152-0030
4	839228	1	• Steering column		OTP75/150-4102. INCLUDED IN 839088.. INCLUDED IN 839229.
	850136	1	• Steering column, WHEEL TUBE OTHER COMPONENTS		OTPB75/150-5040. INCLUDED IN 850137.. INCLUDED IN 850138.
5	839192	1			
6	832385	4	Oil filter		
7	943908	8	Gasket		
8	956971	4	Ferrule		
9	956985	4	Nut		
10	945359	4	Fitting		
11	839089	4	Hose		
12	839094	X	Hydraulic hose		L = 1000 MM
13	957057	X	• Fitting		FOR EARLY TYPE OF 839094.
14	956971	X	• Ferrule		
15	956985	X	• Nut		
16	832296	1	Overflow valve		SEE GROUP 4A
17	832416	1	Tie rod		ALT. TWIN ENGINE INSTALLATION.
18	832417	2	• Push rod		
19	832418	1			
20	832419	1			
21	832420	1			
22	832421	1			
23	832422	1			
24	832423	1	• Fitting		
25	945855	2	• Nut		
26	832436	2	Ball joint		ALT
27	945094	2	Washer		ALT
28		1	HYDRAULIC PUMP AND OIL RESERVOIR AND INSTALLATION COMPONENTS	060-0250	
29		1	EXTENSION HOSE	060-0250	
30		1	STEERING CYLINDER		SEE GROUP 4C