

TAMD70C,AQD70C

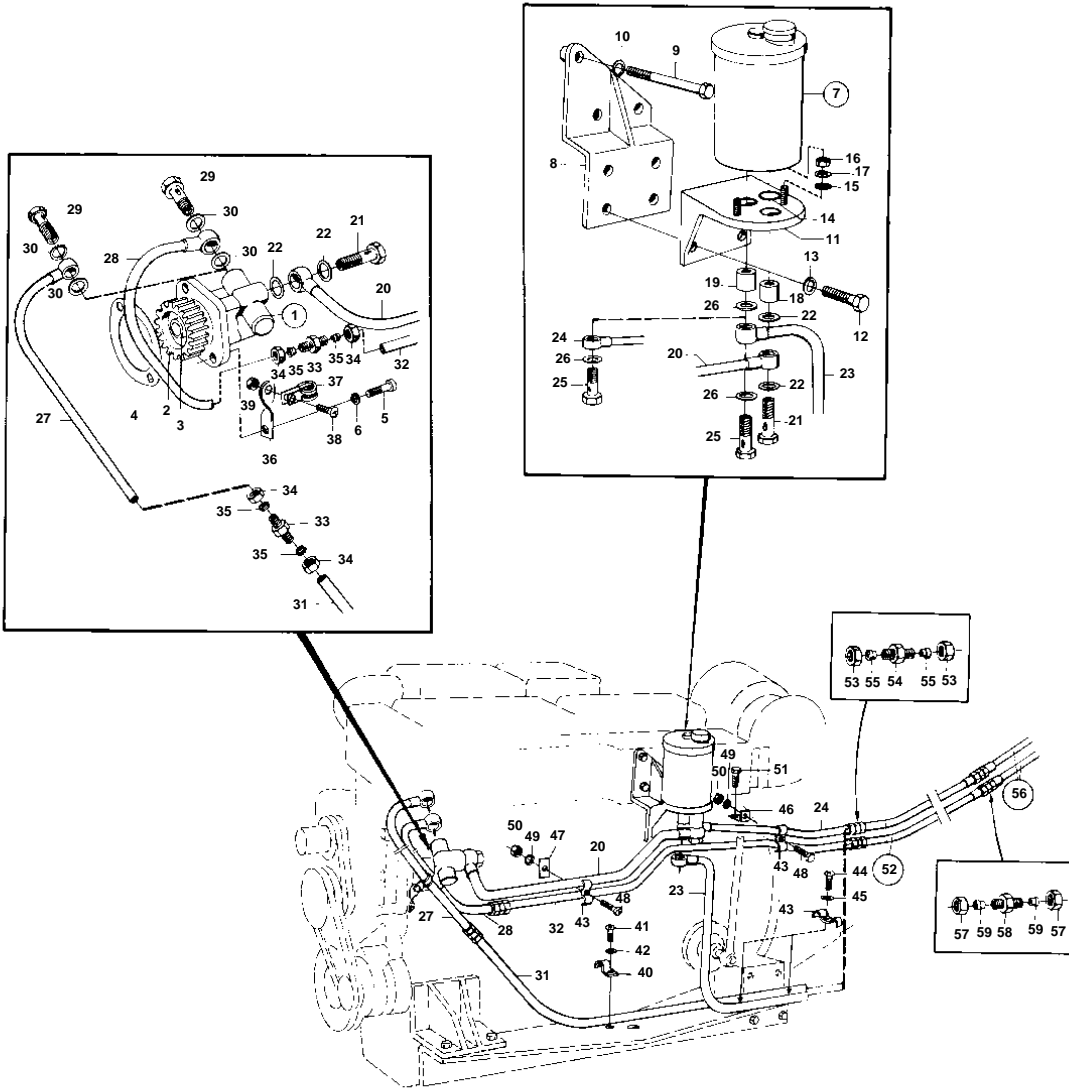

3919

TAMD70C,AQD70C

REF	PART NO.	QTY	DESCRIPTION	SEE SEC.	NOTES
1	356506	1	Hydraulic pump		
				060-0400	
2	421087	1	Gear		
3	346918	1	Nut		
4	421187	1	Gasket		
5	956586	2	Screw		
6	942336	2	Spring washer		
7	323138	1	Oil cooler		REPL BY 327194
				060-0500	
	327194	1	Reservoir		
				060-0550	
8	836478	1	Bracket		
9	941251	3	Screw		
10	942336	3	Spring washer		
11	328378	1	Bracket		
12	940115	4	Screw		
13	942336	4	Spring washer		
14	328382	2	O-ring		
15	328381	2	O-ring		
16	955782	2	Nut		
17	941907	2	Spring washer		
18	328379	1	Connection sleeve		
19	328380	1	Connection sleeve		
20	836683	1	Tube		
21	191620	2	Hollow screw		
22	907137	4	Gasket		
23		1	PIPE		MO-XXXX/5701. REPLACED BY 837347,837348,837349 AND CONNECTING COMPONENT S FOR NEW PIPES
24	837349	1	Tube		MOXXXX/5702-
25	26013	1	Hollow screw		
26	957181	2	Gasket		
27		1	PIPE		MO-XXXX/5701. REPLACED BY 837347,837348,837349 AND CONNECTING COMPONENT S FOR NEW PIPES
28	837347	1	Tube		MOXXXX/5702-
29	190713	1	Hollow screw		
30	11996	2	Gasket		
31		1	PIPE		MO-XXXX/5701. REPLACED BY 837347,837348,837349 AND CONNECTING COMPONENT S FOR NEW PIPES
32	837348	1	Tube		MOXXXX/5702-
33	957056	1	Nipple		
34	956984	2	Nut		
35	956970	2	Ferrule		
36	825629	1	Bracket		
37	952627	1	Clamp		
38	950046	1	Screw		
39	950352	1	Lock nut		
40	951193	1	Clamp		MO-XXXX/5701
41	950044	1	Screw		MO-XXXX/5701
42	941906	1	Spring washer		MO-XXXX/5701
43	836671	2	Clamp		
44	950058	2	Screw		MO-XXXX/5701
45	941907	2	Spring washer		MO-XXXX/5701
46	843233	1	Anchorage		MOXXXX/5702-
47	824570	1	Washer		MOXXXX/5702-
48	950046	2	Screw		MOXXXX/5702-
49	941906	2	Spring washer		MOXXXX/5702-
50	950352	2	Lock nut		MOXXXX/5702-
51	955558	1	Screw		MOXXX/5702-XXX/22342
52	832394	2	Hose		SEE GROUP 4A
53	956985	4	· Nut		FOR EARLY TYPE OF 832394.
	956985	2	· Nut		
54	957057	2	· Fitting		FOR EARLY TYPE OF 832394.
55	956971	4	· Ferrule		FOR EARLY TYPE OF 832394.

TAMD70C,AQD70C

REF	PART NO.	QTY	DESCRIPTION	SEE SEC.	NOTES
55	956971	2	· Ferrule		
56	839230	X	Hose		L = 2500 MM. FOR SPED.867167, 867224, 867266.
	839094	X	Hydraulic hose		L = 1000 MM. FOR SPED.867167, 867224, 867266.
57	956985	X	· Nut		FOR SPED.867167, 867224, 867266.. NOT INCLUDED IN 839230.
58	957057	X	· Fitting		FOR SPED.867167, 867224, 867266.. FOR 839230 AND EARLY TYPE OF 839094.. NOT INCLUDED IN 839230.
59	956971	X	· Ferrule		FOR SPED.867167, 867224, 867266.. NOT INCLUDED IN 839230.