

TAMD70C,AQD70C

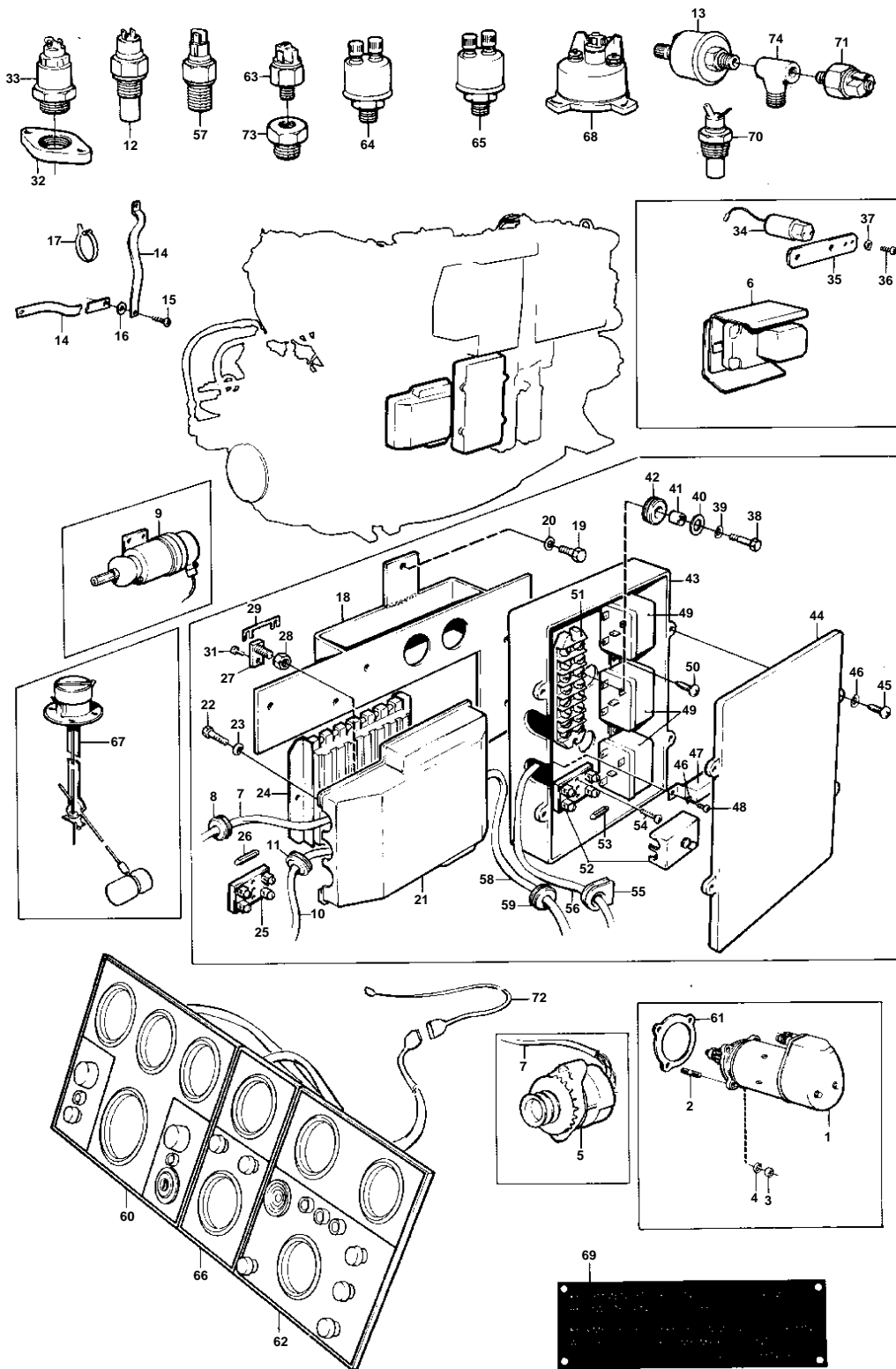

5636

TAMD70C,AQD70C

REF	PART NO.	QTY	DESCRIPTION	SEE SEC.	NOTES
1	842775	1			12V MO90403/XXXX
				030-1400	
	842774	1	Starter motor		24V MO-90403/XXXX
				030-1400	
	843511	1	Starter motor		12V MO90404/XXXX-
				030-1450	
	843510	1	Starter motor		24V MO90404/XXXX-
				030-1450	
	847306	1	Starter motor		12V LATER PROD
				030-1515	
	847307	1	Starter motor		24V LATER PROD
				030-1525	
2	953486	3	Stud		
3	955827	3	Nut		
4	942336	3	Spring washer		
5		1	ALTERNATOR AND INSTALLATION COMPONENTS		12V38A, 24V25A
				030-0800	
		1	ALTERNATOR AND INSTALLATION COMPONENTS		24V60A
				030-1000	
6		1	CHARGING RELAY AND INSTALLATION COMPONENTS		12V38A, 24V25A
				030-0800	
	823766	1	Charge regulator		24V60A
				030-1350	
7	837823	1	Cable trunk		12V38A, 24V25A. ALTERNATOR,STARTER, FUSE,CHARGING RELAY.
	837824	1	Cable trunk		24V60A. ALTERNATOR,STARTER,FUSE, CHARGING RELAY.
8	941265	1	• Cable grommet		
9		1	STOPSOLENOID AND INSTALLATION COMPONENTS		SEE GROUP 2D
10	837821	1	Cable trunk		ENGINE
11	941265	1	• Cable grommet		
12	827150	1	Temperature sensor		
13	843231	1	Oil pressure sensor		
14		1	CABLE HOLDER		
15	950144	2	Screw		
16	120265	2	Washer		
17	948210	X	Strip clamp		
18	837825	1	Bracket		
19	940135	3	Screw		
20	941907	3	Spring washer		
21	837791	2	Clutch housing		MO 12338/XXXX-.
22	955524	3	Screw		
23	941907	3	Spring washer		
24	837829	1	Terminal block		
25	88578	1	Fuse box		
26	943905	2	Fuse		25A
27	837796	4	Screw		
28	17602	8	Nut		
29	77796	2	Fuse		50A
	239148	2	Fuse		80A
31	941616	4	Screw		
32	837308	1	Flange		SEE GROUP 2B
33	842076	1	Glow plug		12V SEE GROUP 2C
	842077	1	Glow plug		24V SEE GROUP 2C
34	837327	1	Solenoid valve		12V SEE GROUP 2C
	837328	1	Solenoid valve		24V SEE GROUP 2C
35	837333	1	Bracket		
36	956090	2	Screw		

TAMD70C,AQD70C

REF	PART NO.	QTY	DESCRIPTION	SEE SEC.	NOTES
37	941906	2	Spring washer		
38	940135	2	Screw		
39	941907	2	Spring washer		
40	960141	2	Washer		
41	837272	2	Anchorage		
42	837369	2	Bushing		
43	837335	1	Clutch housing		
44	823617	1	Cover		
45	950047	4	Screw		
46	941906	6	Spring washer		
47	844486	1	Timer relay		12V
	837344	1	Resistor		24V
48	950044	2	Screw		
49	870670	3	Relay		12V
	870451	3	Relay		24V
50	950009	4	Screw		
51	942558	1	Terminal block		
52	88578	1	Fuse box		
53	943905	2	Fuse		25A
54	950011	4	Screw		
55	823759	2	Cable grommet		
56	837822	1	Cable trunk		
57	354671	1	Tachometer sensor		
58	837836	1	Cable trunk		CONNECTOR,INSTRUMENT PANEL.
59	941265	2	· Cable grommet		
60	837820	1	Instrument panel		12V
				030-1600	
	837819	1	Instrument panel		24V
				030-1600	
61		1	PLATE		EARLY TYPE
62	837993	1	Instrument panel		12V. -INSTRUMENT PANEL FOR HOUR INDICATOR AND EXTRA ALARM DEVICE.
				030-1650	
	837994	1	Instrument panel		24V. -INSTRUMENT PANEL FOR HOUR INDICATOR AND EXTRA ALARM DEVICE.
				030-1650	
63	880281	1	Pressure monitor		
64	837781	1	Pressure sensor		SEE GROUP 4A
65	837782	1	Pressure sensor		SEE GROUP 2B
66	837995	1	Instrument panel		12V. INSTRUMENT PANEL FOR TANK GAUGE AND RUDDER ANGEL INDICATOR
				030-1700	
	837996	1	Instrument panel		24V. INSTRUMENT PANEL FOR TANK GAUGE AND RUDDER ANGEL INDICATOR
				030-1700	
67	837999	1	Tank sensor		
68	837772	1	Rudder position sens		
69	837374	1	Sign		
70	822858	1	Thermo monitor		
71	848367	1	Pressure switch		STOP
72	825738	X	Cable trunk		L = 2500 MM
	820419	X	Cable		L = 7000 MM
73	180002	1	Fitting		
74	942490	1	T-nipple		