

MD70C,TMD70C

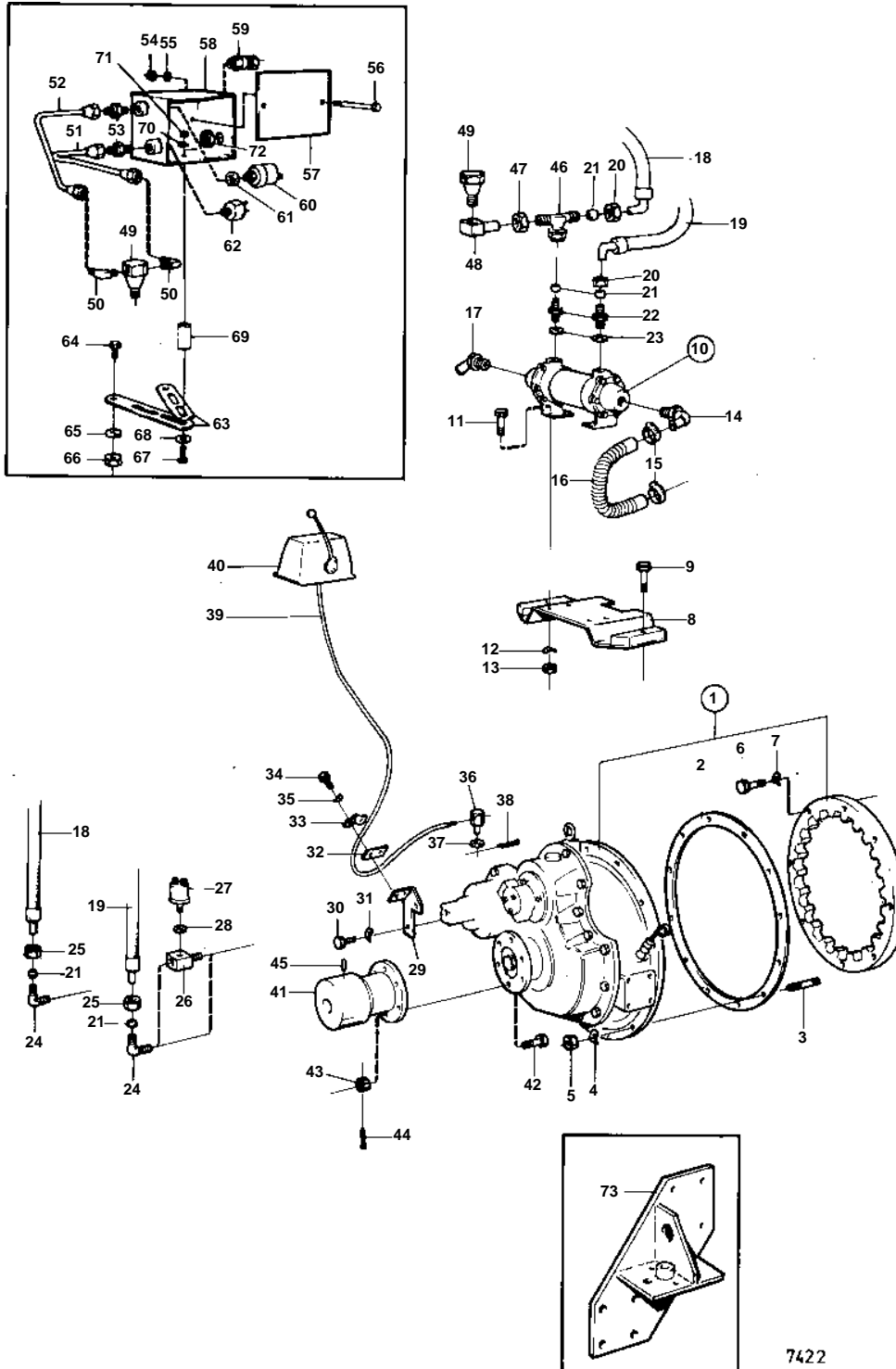

7422

MD70C,TMD70C

REF	PART NO.	QTY	DESCRIPTION	SEE SEC.	NOTES
1		1	REV.GEAR, RATIO 1:1		
		1	REV.GEAR, RATIO 1,51:1		
		1	REV.GEAR, RATIO 1,98:1		
		1	REV.GEAR, RATIO 2,99:1		
		1	· COMPONENT NOT SPEC		
2	862623	1	Gasket		
3	953486	11	Stud		L = 45 MM
	955536	1	Screw		
4	942336	12	Spring washer		
5	955827	11	Nut		
6	940162	8	Screw		
7	942336	8	Spring washer		
8	847020	1	Bracket		
9	955592	2	Screw		
10	844114	1	Oil cooler		
				04A-0650	
11	940135	4	Screw		
12	941907	4	Spring washer		
13	955826	4	Nut		
14		1	PIPE		SEE GROUP 2B
15	836778	1	Gasket		
16	940135	2	Screw		
16A	941907	2	Spring washer		
17	836759	1	Hose attachment		
18	847165	1	Hose		L = 580 MM
19	848254	1	Hose		L = 660 MM
20	941331	2	Nut		
21	956970	5	Ferrule		
22	943755	2	Fitting		
23	957184	2	Washer		
24	941757	2	Nipple		
25	956984	2	Nut		
26	842425	1	Nipple		
27	837781	1	Pressure sensor		SEE GROUP 3
28	947624	1	Gasket		
29	848223	1	Bracket		
30	955309	2	Screw		
31	955894	2	Washer		
32	819068	1	Washer		
33	819067	1	Brace		
34	950021	2	Screw		
35	941905	2	Spring washer		
36	813674	1	Cube		
37	940191	1	Washer		
38	17276	1	Cotter pin		
39		X	CONTROL CABLE		SEE GROUP 9
40		X	CONTROL		SEE GROUP 9
41	842106	1	Clutch flange		
	837055	1	Clutch flange		FOR RATIO 2,99:1.
42	955738	6	Screw		
	955750	6	Screw		FOR RATIO 2,99:1.
43	955886	6	Nut		
	955887	6	Nut		FOR RATIO 2,99:1.
44	907861	6	Cotter pin		
45	17178	2	Pin		FOR RATIO 2,99:1.
46	964049	1	T-pipe		
47	941331	1	Nut		
48	847024	1	Nipple		
49	942490	1	T-nipple		
50	954342	2	Elbow union		
51	845645	1	Tube		
52	846334	1	Tube		
53	954335	2	Fitting		

MD70C,TMD70C

REF	PART NO.	QTY	DESCRIPTION	SEE SEC.	NOTES
54	955825	2	Nut		
55	941906	2	Spring washer		
56	955518	2	Screw		
57	843225	1	Cover		
58	843224	1	Box		
59	822327	1	Cable union		
60	837781	1	Pressure sensor		
61	947624	1	Gasket		
62	848368	1	Pressure switch		
63	965534	4	Bracket		
64	940135	2	Screw		
65	941907	2	Spring washer		
66	955826	2	Nut		
67	940180	2	Screw		
68	960140	4	Washer		
69	821541	2	Sleeve		
70	941906	2	Spring washer		
71	955825	2	Nut		
72	880243	1	Nut		
73		2	ENGINE MOUNTS		SEE GROUP 2A