

COMMON

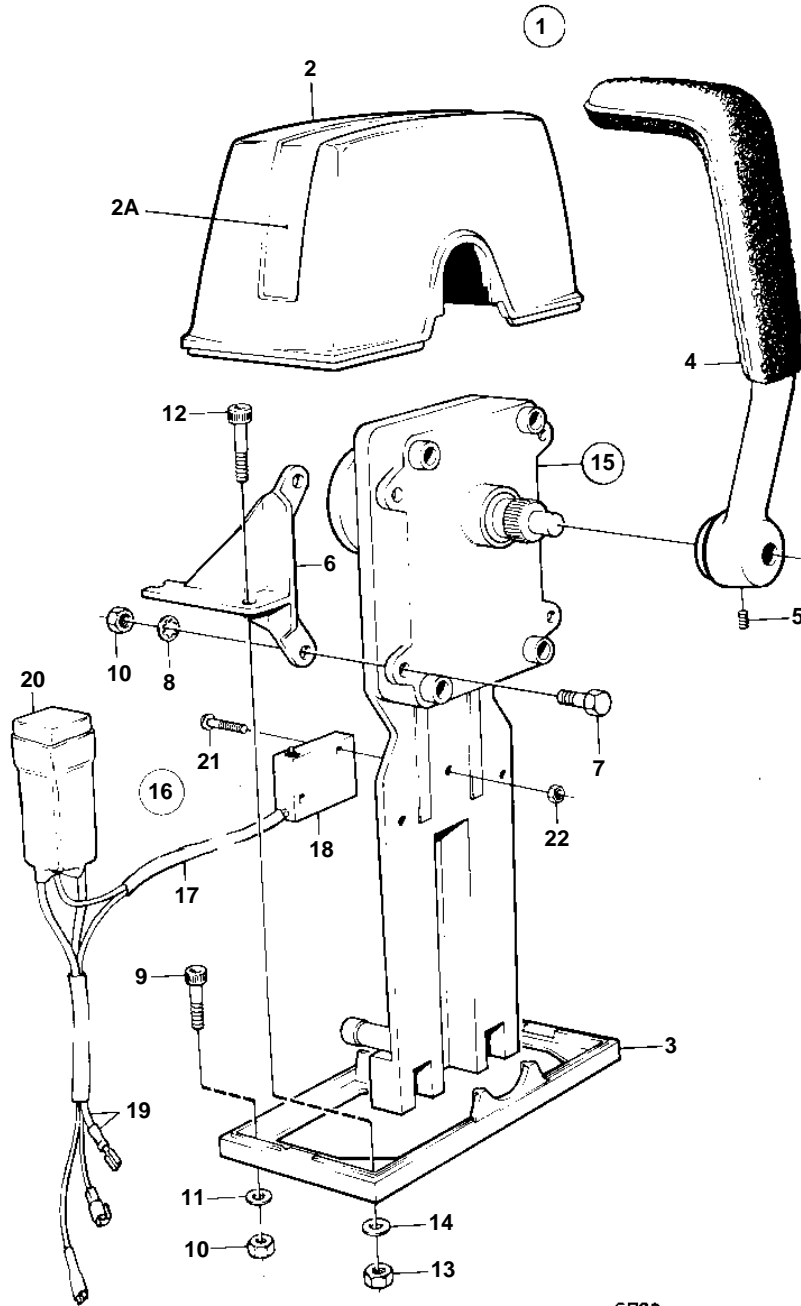

6788

## COMMON

REF	PART NO.	QTY	DESCRIPTION	SEE SEC.	NOTES
1	839470	1	Mounting kit		FOR SINGLE ENGINE INSTALLATION.. ERS AV 1 ST 851602 COMPONENTS NOT SPEC.
2	839472	1	· Cover	IK	
2A	851004	1	· Decal		
3	839474	1	· Plate	IK	
4	839475	1	· Lever	IK	
5	946786	1	· Lock screw	IK	M5
	839693	1	· Lock screw	IK	M8
6	839480	1	· Bracket	IK	MARKED 839480
	839481	1	· Bracket	IK	MARKED 839481
7	955244	4	· Screw	IK	
8	955946	4	· Lock washer	IK	
9	947671	2	· Allen head screw	IK	
10	955780	6	· Nut	IK	
11	960138	2	· Washer	IK	
12	947672	2	· Allen head screw	IK	
13	955781	2	· Nut	IK	
14	960139	2	· Washer	IK	
15	839469	1	Control		REPL BY 851001
				090-1500	
	851001	1	, CONTROL COMPS NOT SPEC.		ERS AV FOR SIDEMOUNTING 1 ST 851601 , FOR TOP- MOUNTING 1 ST 851600
	851601	1	Control, CONTROL COMPONENTS NOT SPEC.		
	851600	1	Control, CONTROL COMPONENTS NOT SPEC.		
16	855352	1	Neutral posit contac		
17	839619	1	· Cable kit		
18	850200	1	· · Switch		
19		X	· · CABLES AND TERMINALS RELAY		SEE GROUP 3
20	1501832	1	· Relay		
21	946177	2	· Screw		
22	947536	2	· Nut		