

COMMON

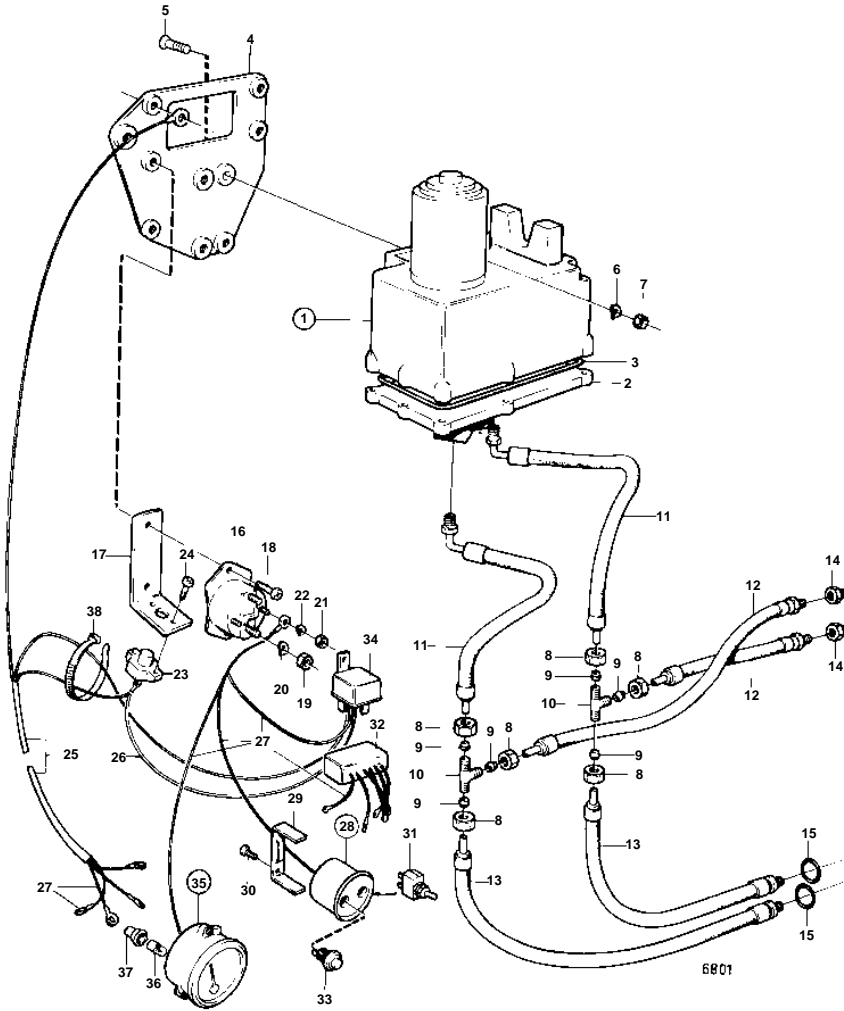

## COMMON

REF	PART NO.	QTY	DESCRIPTION	SEE SEC.	NOTES
1	852500	1	Hydraulic pump		
2	852563	1	· Pump unit		
3	852564	1	· Sealing ring		
4	852568	1	Bracket		
5	950161	4	Screw		L = 32 MM
6	941906	4	Spring washer		
7	955826	4	Nut		
8	941521	9	Nut		
9	956967	6	Fitting		
	964086	3	Fitting		
10	964034	2	T-nipple		
11	852504	2	Hose coupling		
12	850909	2	Hose		
13	850908	2	Hose		
14	851042	2	Nipple	04A-1285	
15	941820	2	O-ring	04A-1285	
16	852565	2	Relay		
17	850905	1	Bracket		
18	950046	3	Screw		
19	955834	4	Nut		
20	941907	4	Spring washer		
21	955844	4	Nut		
22	941905	4	Spring washer		
23	841178	1	Fuse		
24	950013	2	Screw		
25	852191	1	Cable trunk		
26	852192	1	Cable trunk		
27		X	CABELS AND CABLE TERMINALS		SEE GROUP 3
28	850989	1	Instrument panel		USA
	851871	1	Instrument panel		(851501) EXCL USA
29	850372	1	· Brace		
30	944201	2	· Screw		
31	814322	1	· Switch		
32	851870	1	· Trimming limiter		(851771)
33	852026	1	· Switch		
34	876040	1	· Relay kit		
35	851502	1	· Trim indicator		EXCL USA. INCLUDED ONLY IN 851501.
36	192451	1	· · Bulb		
37	841954	1	· · Bulb socket		
38	948210	X	Strip clamp		