

MD22L-B, MD22P-B, TMD22-B, TMD22P-C

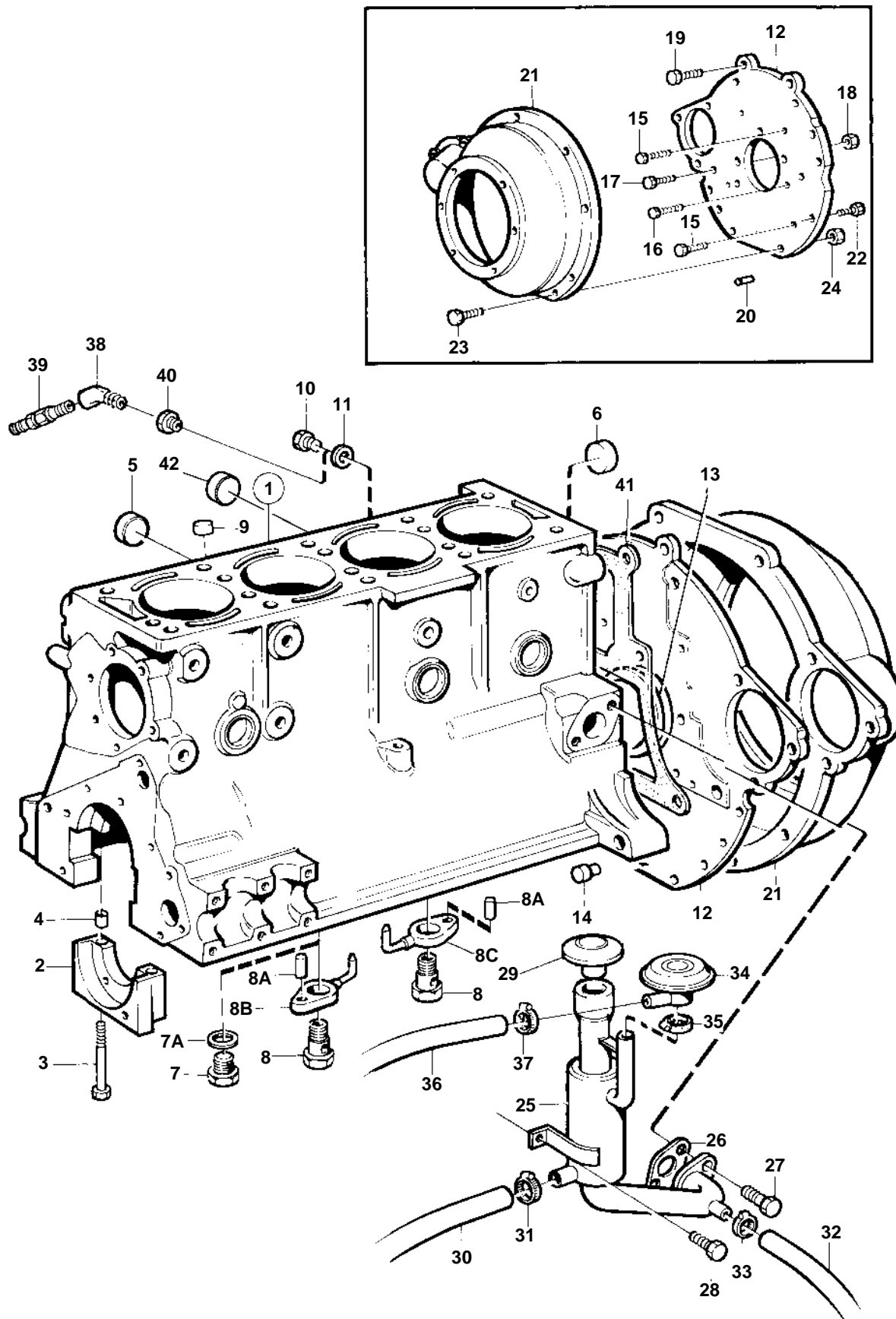

16598

MD22L-B, MD22P-B, TMD22-B, TMD22P-C

REF	PART NO.	QTY	DESCRIPTION	NOTES
1	859625	1	Cylinder block	
2		5	· Main bearing cap	
3	859631	10	· Screw	
4	859632	10	· Guide sleeve	
5	859633	8	· Plug	
6	859634	1	Plug	
7	946025	4	Screw	MD22L-B, MD22P-B (120168)
7A	957171	4	Gasket	MD22L-B, MD22P-B
8	861352	4	Hollow screw	TMD22-B, TMD22P-C
8A		4	Pin	TMD22-B, TMD22P-C
8B	861349	2	Nozzle	TMD22-B, TMD22P-C
8C	861350	2	Nozzle	TMD22-B, TMD22P-C
9	859723	1	Plug	
10	859725	1	Plug	
11	483963	1	Washer	
12	859715	1	Plate	
13	859718	1	Sealing ring	
14	859716	2	Guide pin	
15	946329	5	Flange screw	M10x25mm (973083)
16	946173	3	Flange screw	M8x20mm
17	965228	1	Flange screw	M12x75mm
18	971096	1	Nut	
19	859717	2	Screw	
20	950566	2	Pin	
21	3580664	1	Flywheel housing	
22	946472	6	Screw	M10x30mm
23	965187	2	Screw	M10x60mm
24	971095	2	Nut	
25	859736	1	Crankcase ventilatio	
26	859735	1	Gasket	
27	859737	2	Screw	
28	944926	1	Flange screw	
29	859738	1	Filler cap	
30	859739	1	Hose	Oil filling-oil pan.
31	961665	1	Hose clamp	
32	861604	1	Hose	Oil filling-oil pan.
33	961665	1	Hose clamp	
34	859743	1	Valve	
35	943469	1	Clamp	
36	6646938	1	Hose	Oil filling-air filter.
37	961665	1	Hose clamp	
38	809109	1	Elbow nipple	
39	966871	1	Tap	
40	180002	1	Fitting	
41	861404	1	Gasket	
42	941399	1	Plug	