

MD2B,MD2B/HY,AQD2B

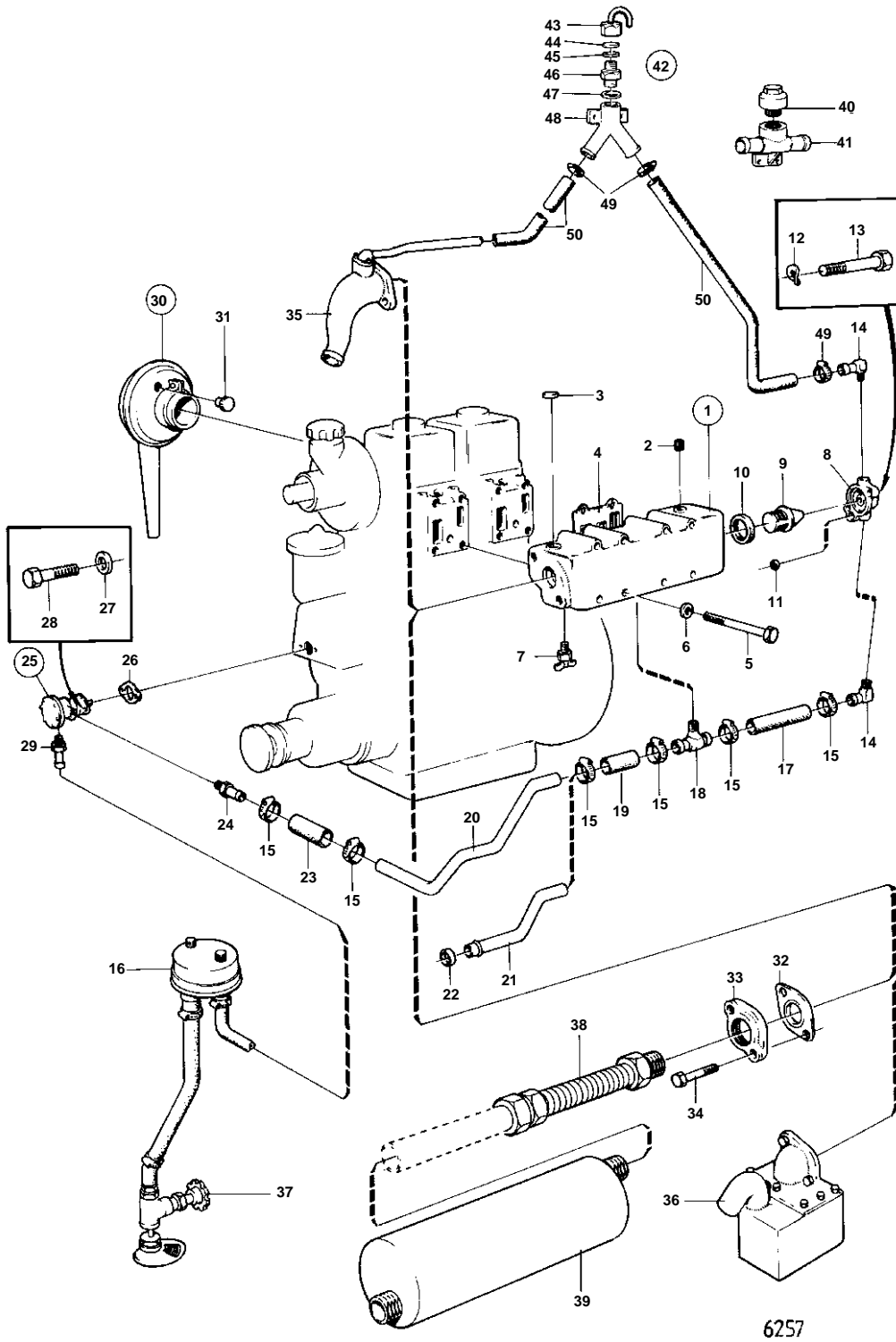

MD2B,MD2B/HY,AQD2B

REF	PART NO.	QTY	DESCRIPTION	SEE SEC.	NOTES
1	833364	1	Exhaust pipe		
2	190682	1	· Plug		
3	192211	4	· Plug		
4	833598	2	Gasket	IK	
5	940129	8	Screw		
6	955894	8	Washer		
7	807036	1	Tap		
8	833412	1	Housing		
9	829812	1	Thermostat		62%Z9C
10	416033	1	Sealing ring	IK	(418361)
11	955989	1	O-ring	IK	
12	941907	2	Spring washer		
13	955299	2	Screw		
14	801197	2	Hose attachment		
15	943473	6	Hose clamp		(951789)
16	831733	1	Strainer		SEE GROUP 9
17	952969	X	Rubber hose		L = 140 MM
18	833356	1	Hose nipple		
19	952969	X	Rubber hose		L = 70 MM
21	833517	1	Tube		
22	418411	1	Sealing ring		
23	952969	X	Rubber hose		L = 100 MM
25	833522	1	Water pump		
26	802551	1	Gasket	IK	02B-0600
27	11992	2	Gasket	IK	
28	955296	2	Screw		
30	833414	2	Air filter		
31	833546	2	· Plug		
32	803374	1	Gasket	IK	
33	807050	1	Exhaust pipe flange		
34	955319	2	Screw		
35	807193	1	Exhaust riser		EARLY TYPE, SEE GROUP 9
	833585	1	Riser		LATE TYPE, SEE GROUP 9
36		1	MUFFLER, WET		SEE GROUP 9
37	828242	1	Cooling wate inlet		SEE GROUP 9
38	833841	1	Compensator		FOR SILENCER 833840.
39	833840	1	Muffler, DRY		
40		1	VACUUM VALVE		EARLY TYPE. REPLACED BY 828263, 828262.
41		1	HOUSING		EARLY TYPE. REPLACED BY 828263, 828262.
42	828534	1	Vacuum valve		(828263)
43		1	· UPPER UNIT		
44	828264	2	· Diaphragm		
45	828424	2	· Gasket		
46		1	· LOWER PART		
47	947282	2	· Gasket		
48	828262	1	Hose connection		LATE TYPE
49	961666	4	Hose clamp		
50	13569	X	Hose		