

MD2B

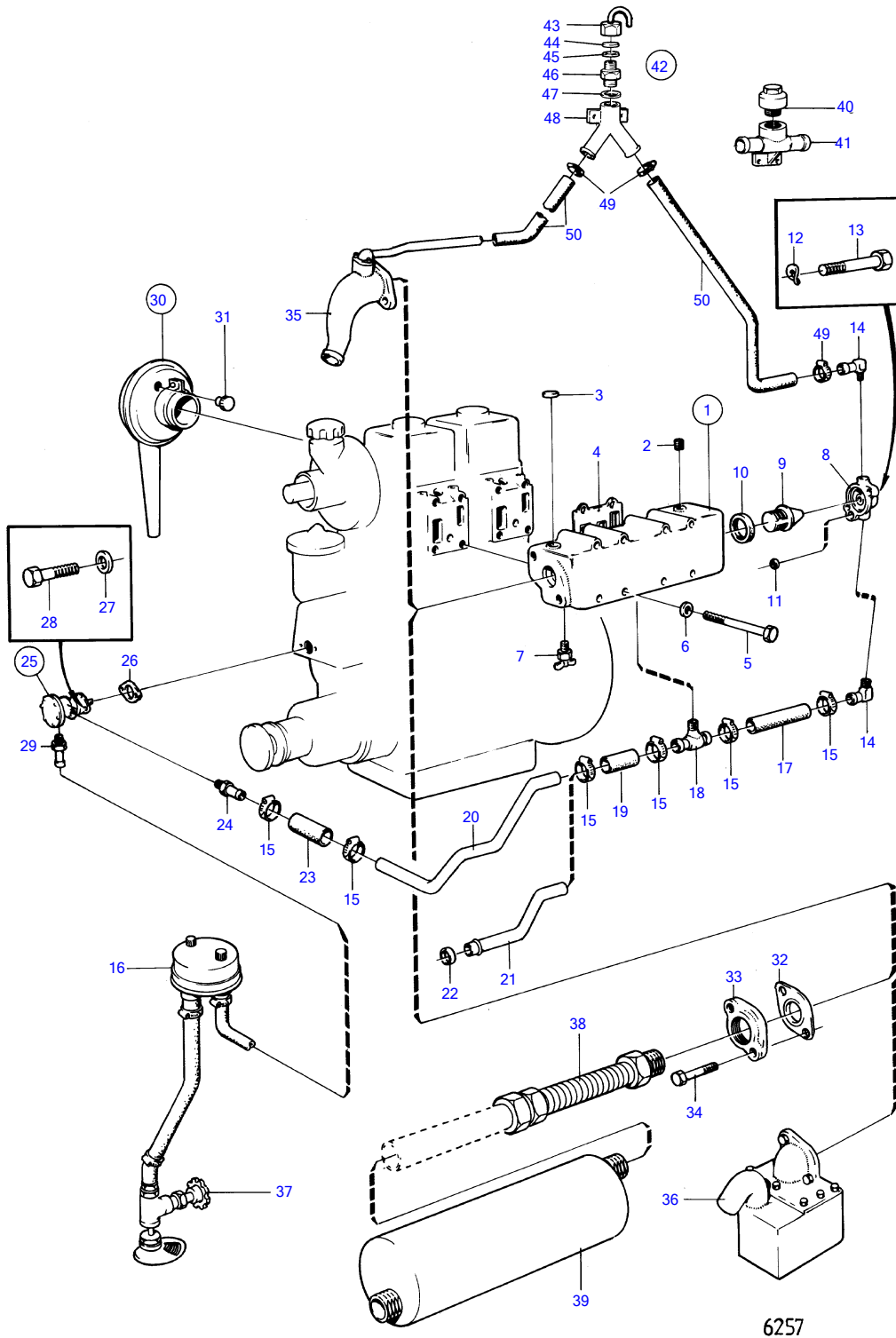

## MD2B

REF	PART NO.	QTY	DESCRIPTION	SEE SEC.	NOTES
1	833364	1	Exhaust pipe		
2	(190682)	1	• Plug		Obsolete part
3	192211	4	• Expansion plug		
4	833598	2	Gasket		
5	940129	8	Hexagon screw		
6	955894	8	Washer		
7	807036	1	Shut-off cock		
8	(833412)	1	Thermostat housing		Obsolete part
9	876080	1	Thermostat kit		62°C
10	416033	1	Sealing ring		(418361)
11	955989	1	O-ring		
12	941907	2	Spring washer		
13	955299	2	Hexagon screw		
14	801197	2	Hose attachment		
15	943473	6	Hose clamp		(951789)
16	831733	1	Strainer		See group 9
17	952969	X	Hose		L=140mm
18	(833356)	1	Hose attachment		Obsolete part
19	952969	X	Hose		L=70mm
20	(833333)	1	Coolant pipe		Obsolete part
23	952969	X	Hose		L=70mm
24	(803648)	1	Hose attachment		Obsolete part, MO-18306
	897391	1	Hose attachment		MO 18307-
25	833415	1	Water pump		
			•	13764	
			•	13765	
26	802551	1	Gasket		
27	11992	2	Gasket		
28	955296	2	Hexagon screw		
29	897391	1	Hose attachment		
30	(833414)	2	Air filter		Obsolete part
31	(833546)	2	• Plug		Obsolete part
32	803374	1	Gasket		
33	807050	1	Exhaust pipe flange		
34	955319	2	Hexagon screw		
35	807193	1	Exhaust riser		Early type, see group 9
	(833585)	1	Riser		Obsolete part, Late type, see group 9
36		1	muffler, wet		See group 9
37	828242	1	Cooling water inlet		See group 9
38	(833841)	1	Compensator		Obsolete part, For silencer 833840.
39	833840	1	Muffler, dry		
40		1	vacuum valve		Replaced by 828263, 828262., Early type
41		1	housing		Replaced by 828263, 828262., Early type
42	828534	1	Vacuum valve		(828263)
43		1	• upper unit		
44		2	• Diaphragm		
45	828424	2	• Gasket		
46		1	• lower part		
47	947282	2	• Gasket		
48	828262	1	Hose connection		Late type
49	961666	4	Hose clamp		
50	13569	X	Hose		