

MD1B, MD2B, MD3B

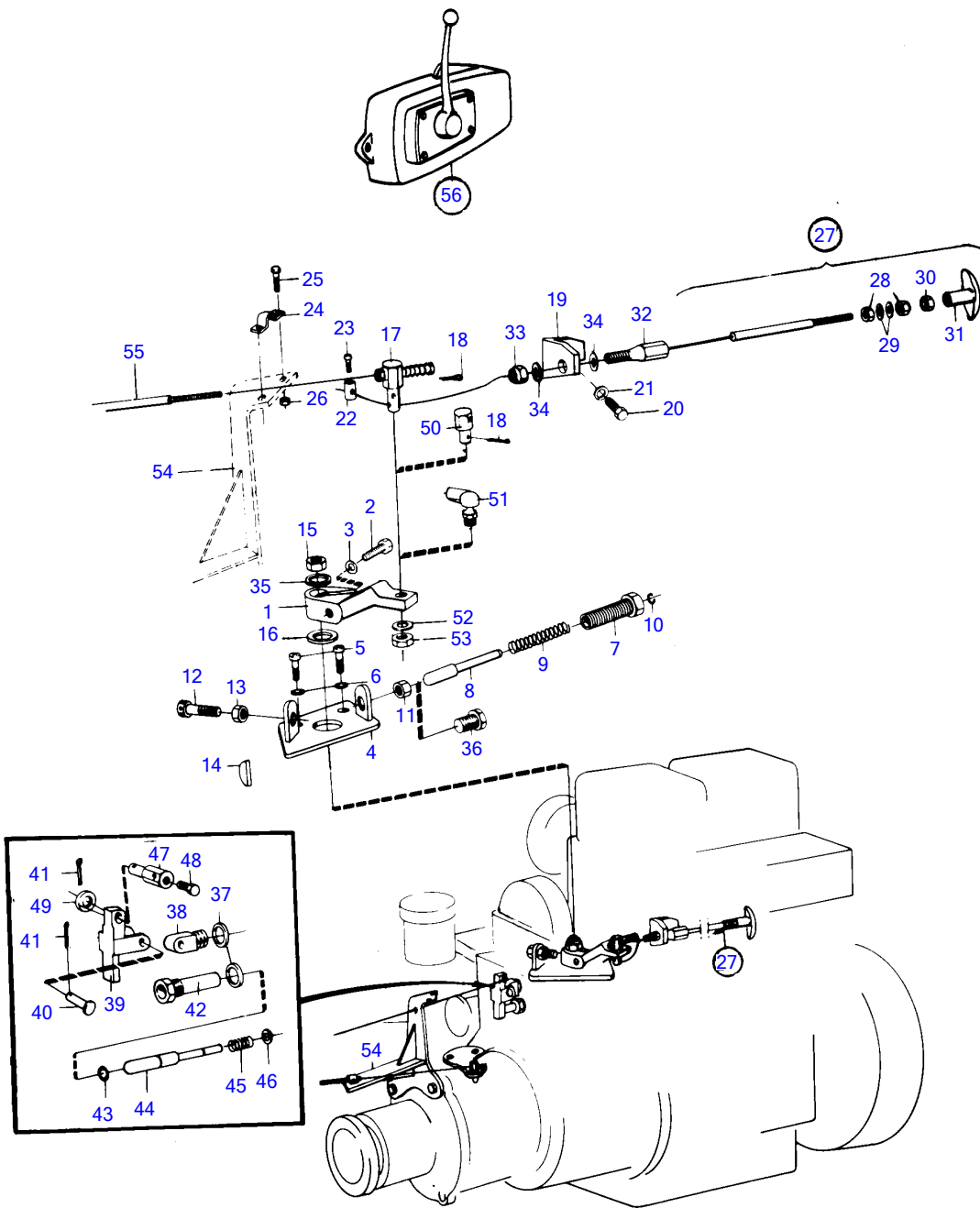

7160

MD1B, MD2B, MD3B

REF	PART NO.	QTY	DESCRIPTION	NOTES
1	(833482)	1	Lever	Obsolete part
2	(959617)	1	Screw	Obsolete part
3	941907	1	Spring washer	
4	(833072)	1	Bracket	Obsolete part
5	955270	2	Hexagon screw	
6	941906	2	Spring washer	
7	833076	1	Sleeve	MD1B spec 867091, 867142, MD1B 867229early type, MD2B spec 867094, 867122, 867230 MO-29258, 29309-29354. MD2B/HY. MD3B spec 867119, 867231 MO-5889. MD11C/HY, MD11C/HD-HY.
8	(833077)	1	Pin	MD1B spec 867091, 867142, MD1B 867229early type, MD2B spec 867094, 867122, 867230 MO-29258, 29309-29354. MD2B/HY. MD3B spec 867119, 867231 MO-5889. MD11C/HY, MD11C/HD-HY., Obsolete part
9	833078	1	Spring	MD1B spec 867091, 867142, MD1B 867229early type, MD2B spec 867094, 867122, 867230 MO-29258, 29309-29354. MD2B/HY. MD3B spec 867119, 867231 MO-5889. MD11C/HY, MD11C/HD-HY.
10	951667	1	E-circlip	MD1B spec 867091, 867142, MD1B 867229early type, MD2B spec 867094, 867122, 867230 MO-29258, 29309-29354. MD2B/HY. MD3B spec 867119, 867231 MO-5889. MD11C/HY, MD11C/HD-HY.
11	955792	1	Hexagon nut	
12	944323	1	Screw	
13	955782	1	Hexagon nut	
14	910112	1	Woodruff key	Early type
15	963107	1	Lock nut	
16	955897	1	Washer	
17	833463	1	Cube	MD1B spec 867091, 867142, MD1B 867229early type, MD2B spec 867094, 867122, 867230 MO-29258, 29309-29354. MD2B/HY. MD3B spec 867119, 867231 MO-5889. MD11C/HY, MD11C/HD-HY.
18	907834	1	Split pin	
19	(833492)	1	Bracket	Obsolete part, MD1B spec 867091, 867142, MD1B 867229early type, MD2B spec 867094, 867122, 867230 MO-29258, 29309-29354. MD2B/HY. MD3B spec 867119, 867231 MO-5889. MD11C/HY, MD11C/HD-HY.
20	959218	1	Hex. socket screw	MD1B spec 867091, 867142, MD1B 867229early type, MD2B spec 867094, 867122, 867230 MO-29258, 29309-29354. MD2B/HY. MD3B spec 867119, 867231 MO-5889. MD11C/HY, MD11C/HD-HY.
21	941907	1	Spring washer	MD1B spec 867091, 867142, MD1B 867229early type, MD2B spec 867094, 867122, 867230 MO-29258, 29309-29354. MD2B/HY. MD3B spec 867119, 867231 MO-5889. MD11C/HY, MD11C/HD-HY.
22	(21882)	1	Clamp	Obsolete part, MD1B spec 867091, 867142, MD1B 867229early type, MD2B spec 867094, 867122, 867230 MO-29258, 29309-29354. MD2B/HY. MD3B spec 867119, 867231 MO-5889. MD11C/HY, MD11C/HD-HY.
23	955224	1	Hexagon screw	MD1B spec 867091, 867142, MD1B 867229early type, MD2B spec 867094, 867122, 867230 MO-29258, 29309-29354. MD2B/HY. MD3B spec 867119, 867231 MO-5889. MD11C/HY, MD11C/HD-HY.
24	21471054	1	Bracket	
25	956078	2	Cross recessed screw	
26	963104	2	Lock nut	
27	(818470)	1	Push pull control	Obsolete part, L=6900mm
	(818478)	1	Push pull control	Obsolete part, L=3300mm
28	955857	2	• Hexagon nut	
29	955950	2	• Toothed washer	
30	955844	1	• Hexagon nut	
31	829241	1	• Handle	
32	829070	1	Cable lock	
33	(950363)	1	Lock nut	Obsolete part
34	955894	2	Washer	
35	955897	1	Washer	
36	955341	1	Hexagon screw	L=35mm
37	957175	2	Gasket	
38	(833765)	1	Retainer	Obsolete part
39	(833764)	1	Lever	Obsolete part
40	913125	1	Clevis pin	
41	907824	2	Split pin	
42	833763	1	Sleeve	
43	946781	1	O-ring	

MD1B, MD2B, MD3B

REF	PART NO.	QTY	DESCRIPTION	NOTES
44	833761	1	Pin	MD1B, MD2B, MD11C, MD11D.
	(833762)	1	Pin	Obsolete part, MD3B spec 867231 MO 5890-. MD17C spec 867211, 867231. MD17C/HD-HY, MD17C/HD-BT. MD17D.
45	833078	1	Spring	
46	(955961)	1	Snap ring	Obsolete part
47	833133	1	Cube	
48	(192244)	1	Screw	Obsolete part, MD1B, MD2B, MD3B., L=9,5mm
49	955892	1	Washer	
50	833462	1	Cube	MD1B spec 867229LATE type. MD2B spec 867230 MO 29259-29308, 29355-.
51	813042	1	Ball joint	MD3B, MD11C, MD11D, MD17C, MD17D.
52	941905	1	Spring washer	MD3B, MD11C, MD11D, MD17C, MD17D.
53	(951784)	1	Nut	Obsolete part, MD3B, MD11C, MD11D, MD17C, MD17D.
54		1	bracket, reverse gear	See group 4A
	(829641)	1	Bracket	Obsolete part, See group 4A
55		X	control cable	See group 9
56		X	control	See group 9