

MD120A, TMD120A, TAMD120A

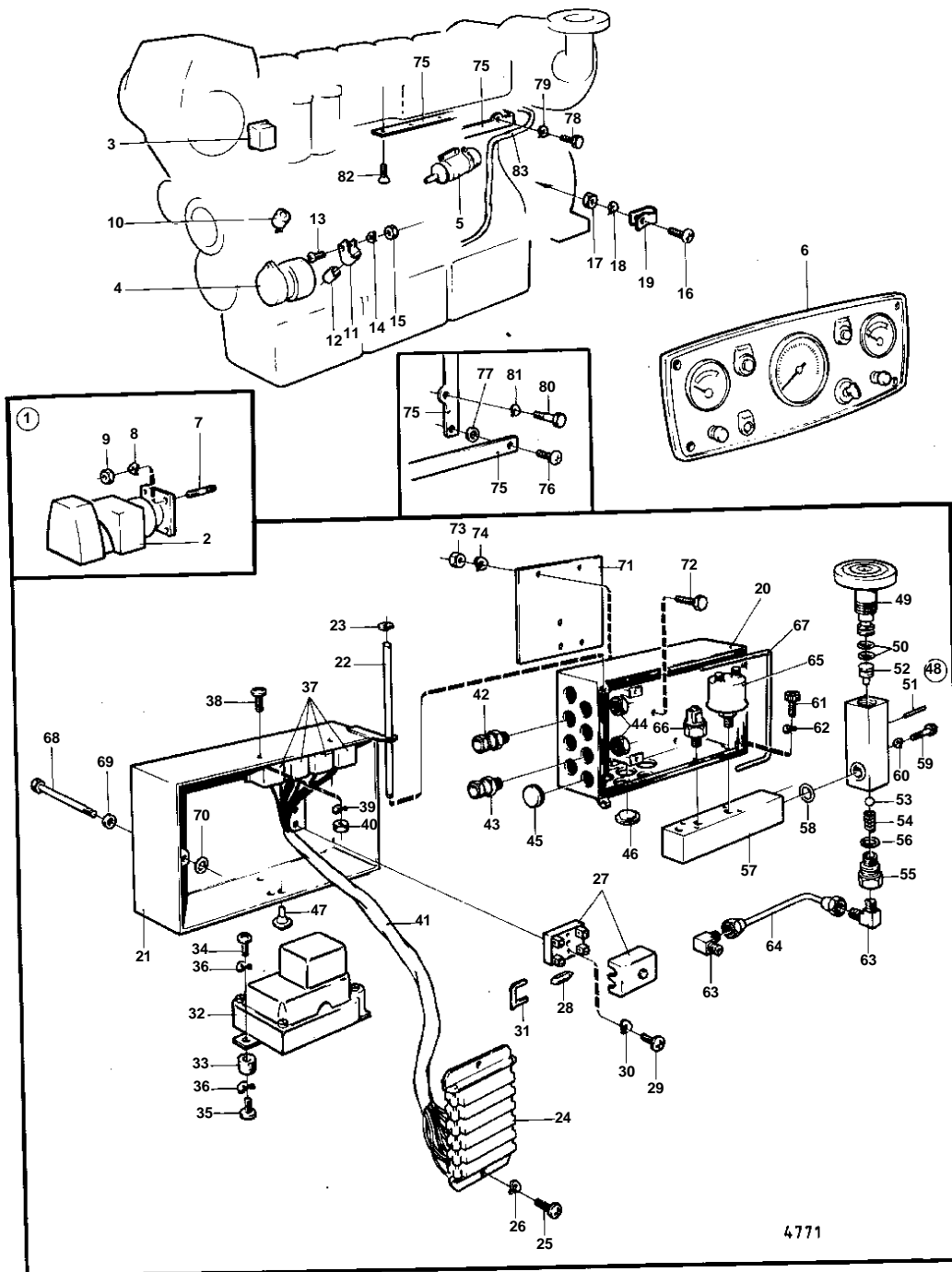

MD120A,TMD120A,TAMD120A

REF	PART NO.	QTY	DESCRIPTION	SEE SEC.	NOTES
1	870998	1	Starter motor		24V REPL BY 847308
				030-1400	
	847308	1	Starter motor		24V
			COMPONENTS NOT SPEC.		
2			STARTER COVER WITH INSTALLATION COMPONENTS	030-0900	
3			THERMOSWITCH AND PROTECTING BOX WITH INSTALLATION COMPONENTS	030-0850	
4			ALTERNATOR WITH INSTALLATION COMPONENTS INSTALLATION COMPONENTS	030-0550	
5			STOP SOLENOID WITH INSTALLATION COMPONENTS		SEE GROUP 2D
6	823364	1	Instrument panel		24V
				030-1500	
7	953486	3	Stud		
8	942336	3	Spring washer		
9	955827	3	Nut		
10	1507899	1	Tachometer sensor		
11	18986	1	Clamp		
12	241608	1	Protective sleeve		
13	950047	1	Screw		
14	941906	2	Spring washer		
15	955825	1	Nut		
16	956065	1	Screw		
17	955779	1	Nut		
18	941904	1	Spring washer		
19	952627	1	Clamp		
20	837812	1	Clutch housing		
21	837866	1	Cover		
22	837838	1	Shaft		
23	951667	2	Lock ring		
24	837829	1	Terminal block		
25	956074	2	Screw		
26	941905	2	Spring washer		
27	88578	2	Fuse box		
28	943905	2	Fuse, BLUE		25A
	942785	2	Fuse		16A
29	956060	4	Screw		
30	941904	4	Spring washer		
31	842390	1	Bridge connector		
32	823480	1	Charge regulator		24V 25A. BRÖYT SPEC. 867510.
33	899709	3	Vibration damper		
34	956091	3	Screw		
35	956092	3	Screw		
36	941906	6	Spring washer		
37	1504951	4	Relay		
38	956074	2	Screw		
39	941905	2	Spring washer		
40	955780	2	Nut		
41	842124	1	Cable trunk		
42	822327	2	Cable union		
43	881192	2	Cable union		
44	880243	4	Nut		
45	94081	9	Rubber button		
46	662620	2	Rubber button		
47	655545	3	Rubber button		ALT
48	837928	1	Valve		
49	837930	1			
50	925052	2	· Rubber ring		
51	951938	1	· Spring pin		

MD120A,TMD120A,TAMD120A

REF	PART NO.	QTY	DESCRIPTION	SEE SEC.	NOTES
52	837932	1	• Intermediate section		
53	70472	1	• Ball		
54	832441	1	• Spring		
55	837929	1			
56	955985	1	• O-ring		
57	837938	1	Intermediate section		
58	955984	1	Sealing ring		
59	959182	4	Screw		
60	941904	4	Spring washer		
61	942001	4	Screw		
62	941906	4	Spring washer		
63	954342	2	Elbow union		
64	842075	1	Tube		
	842199	1	Tube		TMD120A, MD120A
	842070	1	Tube		TAMD120A
65	881432	1	Pressure sensor		
66	843812	1	Switch		STOP
	843813	1	Switch		ALARM
67	842224	X	Sealing strip		L = 1000 MM
68	955261	1	Screw		
69	960138	1	Washer		
70	955978	1	Rubber ring		
71	842156	1	Bracket		MD120A, TMD120A
72	955524	5	Screw		
73	955826	2	Nut		
74	941907	5	Spring washer		
75			CABLE HOLDERS		
76	950144	2	Screw		
77	120265	2	Washer		
78	950558	1	Pin		
79	940280	1	Spring washer		
80	940133	1	Screw		
81	942336	1	Spring washer		
82	950158	2	Screw		
	950160	1	Screw		
83		X	CABLES		CAN'T BE USED ON ALTERNATOR 841765.