

KAD32P, KAD32P-A, TAMD42WJ-A, KAD43P, KAD43P-A, KAMD43P, KAMD43P-A, KAD44P, KAD44P-A, KAD44P-B, KAD44P-C, KAMD44P, KAMD44P-A, KAMD44P-B, KAMD44P-C, KAD300, , KAMD300, KAMD300-A

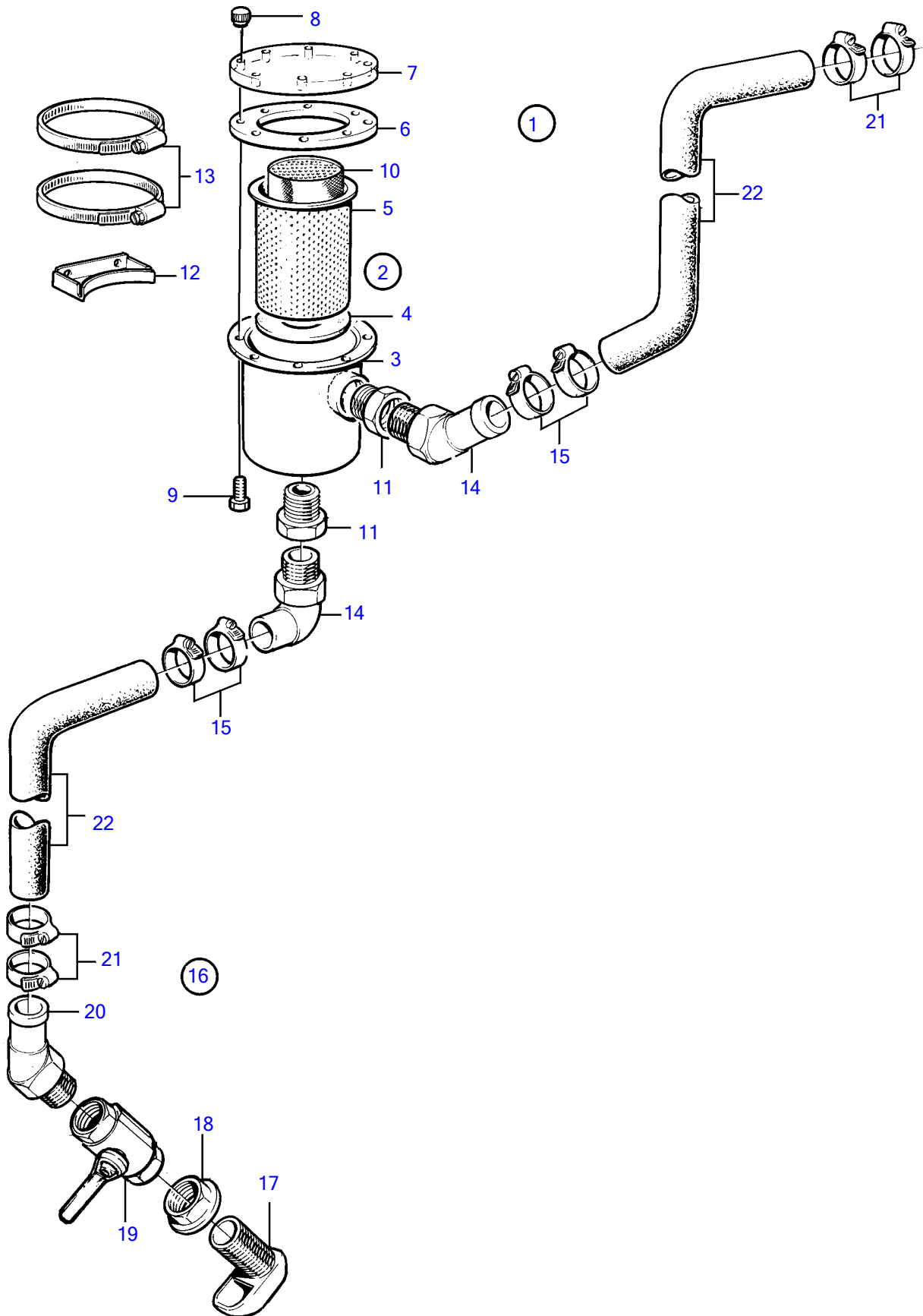

KAD32P, KAD32P-A, TAMD42WJ-A, KAD43P, KAD43P-A, KAMD43P, KAMD43P-A, KAD44P, KAD44P-A, KAD44P-B, KAD44P-C, KAMD44P, KAMD44P-A, KAMD44P-B, KAMD44P-C, KAD300, , KAMD300, KAMD300-A

REF	PART NO.	QTY	DESCRIPTION	NOTES
1	1140034	1	Sea water filter	D=32mm
2	842466	1	• Sea water filter	
3		1	• • Housing	
4	3589331	1	• • Gasket kit	
5	843358	1	• • Filter	
6	3589331	1	• • Gasket kit	
7	843359	1	• • Cardboard tube	
8	843357	8	• • Nut	
9	(843362)	8	• • Screw	Obsolete part
10	844902	1	• Sea water filter	
11	844903	2	• Bushing	
12	828061	2	• Retainer	
13	961678	2	• Hose clamp	
14	828696	2	• Hose attachment	
15	961669	4	• Hose clamp	
16	1140129	1	Cooling water inlet	D=32mm
17	836876	1	• Strainer	
18	836879	1	• Nut	
19	1140125	1	• Ball valve	
20	828696	1	• Hose attachment	45°
21	961670	2	• Hose clamp	
22	1140664	X	Exhaust hose	D=32mm