

D8A1-A MP, D8A2-A MP, D8A3-A MP, D8A4-A MP

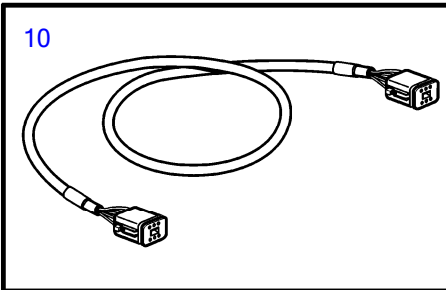
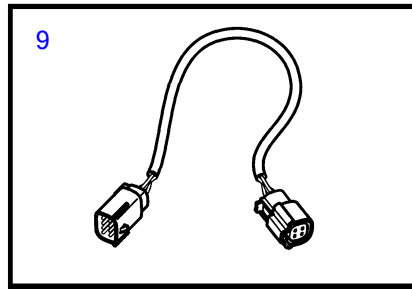
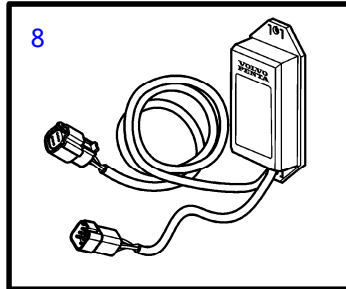
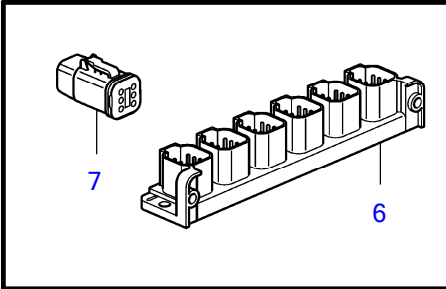
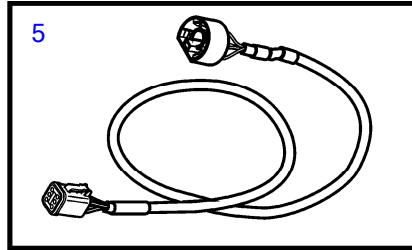
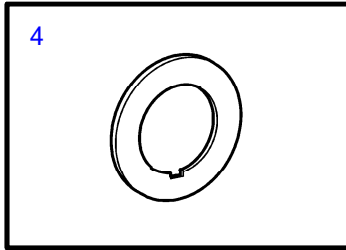
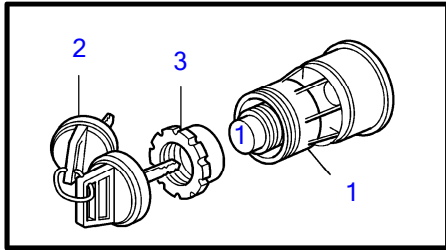

D8A1-A MP, D8A2-A MP, D8A3-A MP, D8A4-A MP

REF	PART NO.	QTY	DESCRIPTION	NOTES
1	3587070	1	Starter switch	Analogue Starter Key for Twin installation
2	3586527	1	• Lock kit	
3	859955	2	• Plastic nut	
4	860086	2	• Marking label	
5	881849	2	Wiring harness	
6	21469055	1	Connection block	
7	3840433	4	• Sealing plug	
8	21461496	2	Network adapter	
9	21421946	1	• Cable	
10	3886666	5	Cable	