

D8A1-A MP, D8A2-A MP, D8A3-A MP, D8A4-A MP

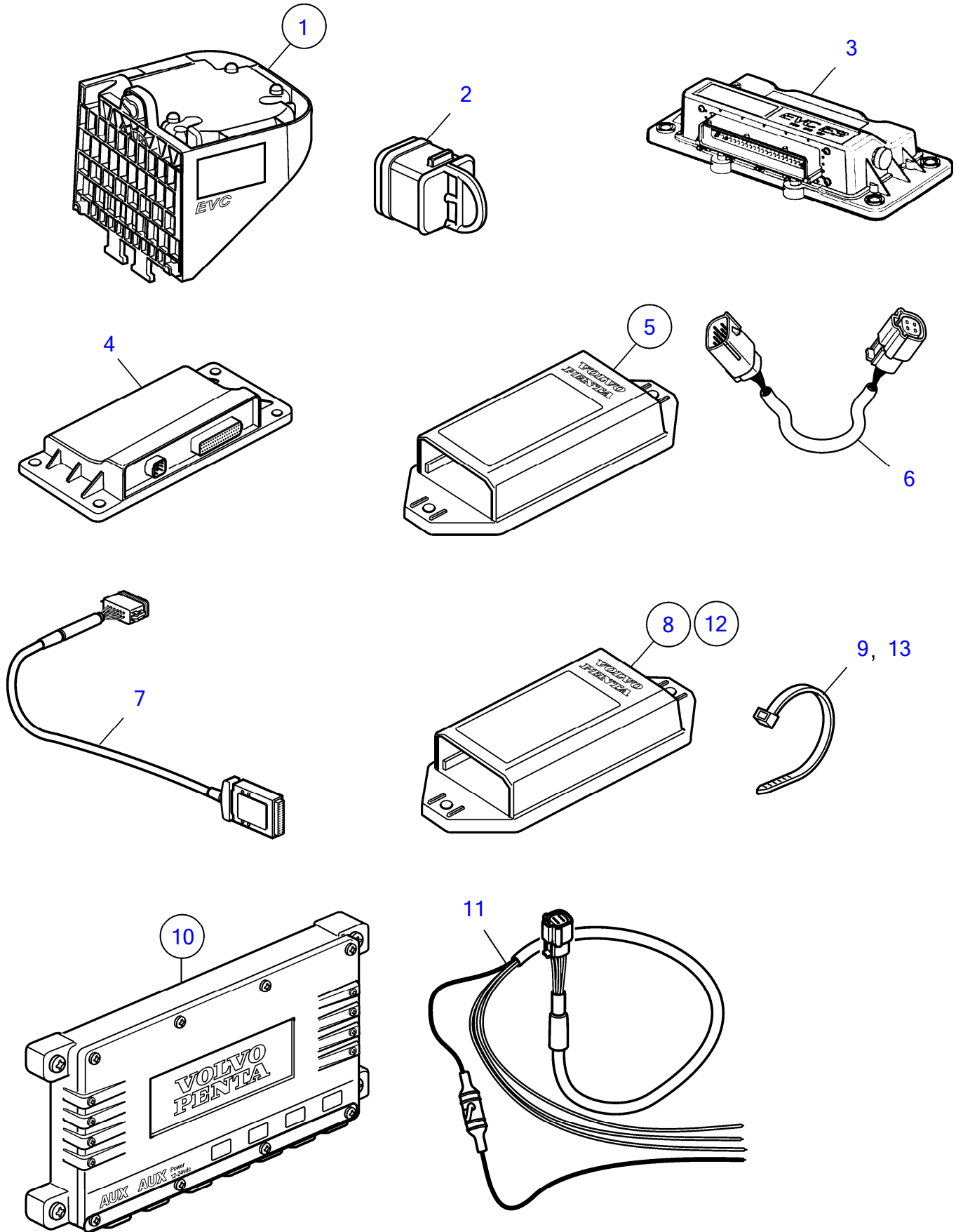

D8A1-A MP, D8A2-A MP, D8A3-A MP, D8A4-A MP

| REF | PART NO. | QTY | DESCRIPTION | NOTES |
|-----|----------|-----|---|---|
| 1 | 22685460 | 1 | Control unit, STCM | STCM Steering Thruster Control Module |
| 2 | 3840433 | 1 | • Sealing plug | |
| 3 | 22642634 | 1 | Power train control, PCU | |
| | 3586266 | X | Software | Vodia-programming. This p/n can not be ordered, but will be used for invoicing. |
| | 3586267 | X | Software | Warehouse programming. This p/n can not be ordered, but will be used for invoicing. |
| 4 | 21469067 | 1 | Control unit, SCU | Steering Control Unit |
| 5 | 21461496 | 1 | Network adapter, Analogue Key Interface | |
| 6 | 21421946 | 1 | • Cable | |
| 7 | 21509941 | 1 | Control unit, 4-20MA In-Interface | |
| 8 | 22813366 | 1 | Converter | |
| 9 | 948210 | 2 | • Cable tie | |
| 10 | 22894802 | 3 | lcm gyro | ICM GYRO for IS System |
| 11 | 21888965 | 1 | • Power cable | |
| 12 | 22936543 | 1 | Converter | For D3, D4 and D6, I/O module for monitoring/controlling of a swim platform |
| 13 | 948210 | 2 | • Cable tie | |

47705750-30-41612

28917

Upd:4/18/2019

D8A1-A MP, D8A2-A MP, D8A3-A MP, D8A4-A MP