

D70CHC,D70CRC

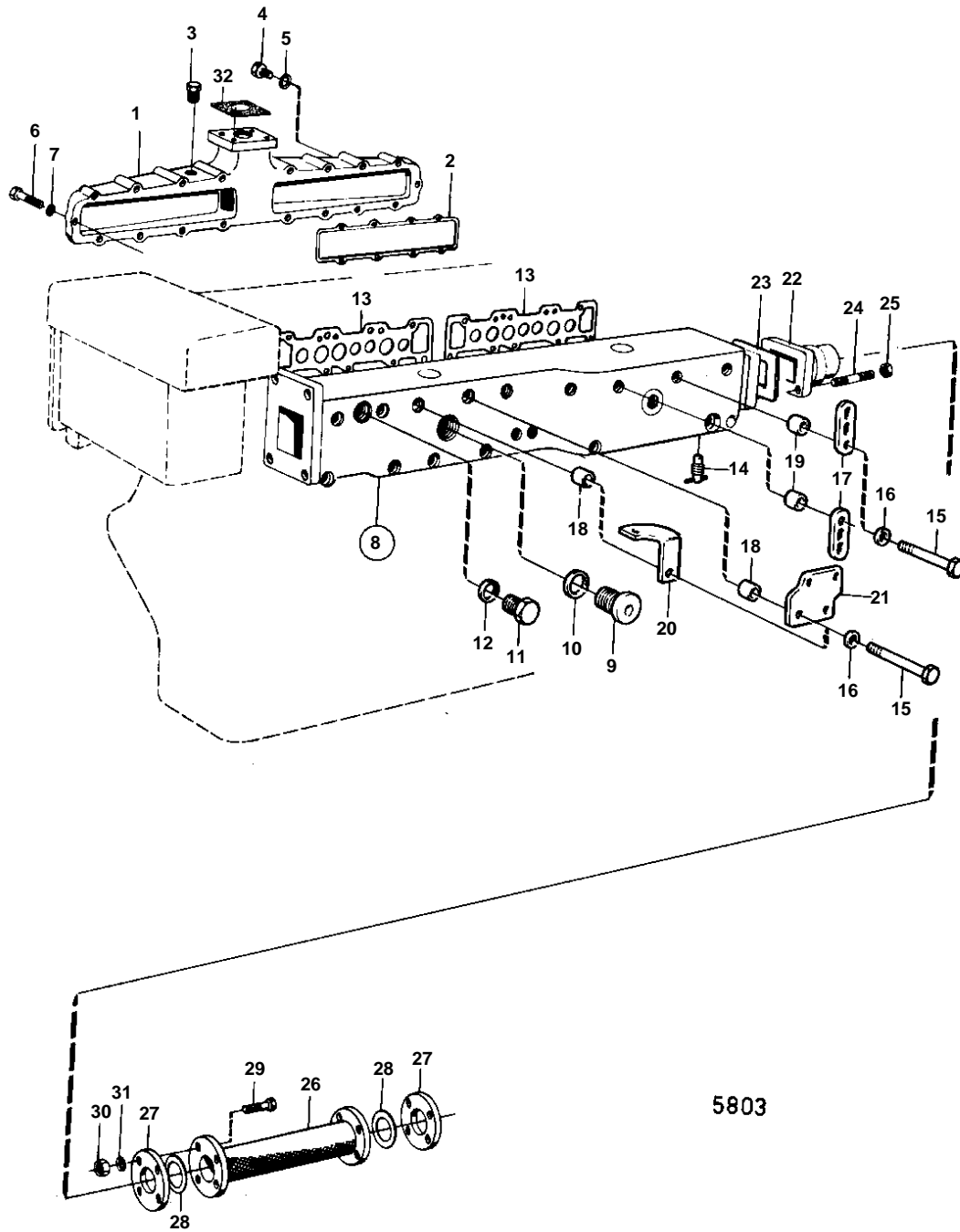

INDUCTION AND EXHAUST MANIFOLD WITH INSTALLATION COMPONENTS

02B

D70CHC,D70CRC

REF	PART NO.	QTY	DESCRIPTION	SEE SEC.	NOTES
1	466274	1	Inlet pipe		
2	424612	2	Gasket	IK	(421071)
3	191026	1	Plug		
4	940113	1	Screw		
5	957171	1	Gasket		
6	940161	6	Screw		L = 45 MM
	955527	4	Screw		L = 57 MM
	955528	4	Screw		L = 70 MM
	955530	4	Screw		L = 83 MM
7	941907	18	Spring washer		
8	837496	1	Exhaust pipe		
9	467367	6	· Plug		
10	469328	6	· Gasket	IK	
11	301185	2	· Plug		
12	957185	2	· Gasket	IK	
13	862634	2	Gasket	IK	(842531)
14	82745	1	Tap		
15	942338	4	Screw		L = 114 MM
	955544	8	Screw		L = 102 MM
	959797	5	Screw		L = 140 MM. WHEN DOUBLE SHEATED FUEL PIPES ARE NOT INSTALLED.
	959797	6	Screw		L = 140 MM. WHEN DOUBLE SHEATED FUEL PIPES ARE INSTALLED.
	959798	3	Screw		L = 152 MM. WHEN DOUBLE SHEATED FUEL PIPES ARE NOT INSTALLED.
	959798	2	Screw		L = 152 MM. WHEN DOUBLE SHEATED FUEL PIPES ARE INSTALLED.
16	942336	20	Spring washer		
17	965535	3	Bracket		WHEN DOUBLE SHEATED FUEL PIPES ARE NOT INSTALLED.
	965535	2	Bracket		WHEN DOUBLE SHEATED FUEL PIPES ARE INSTALLED.
18	912127	4	Spacer sleeve		WHEN DOUBLE SHEATED FUEL PIPES ARE NOT INSTALLED.
	912127	2	Spacer sleeve		WHEN DOUBLE SHEATED FUEL PIPES ARE INSTALLED.
19	912128	3	Spacer ring		WHEN DOUBLE SHEATED FUEL PIPES ARE NOT INSTALLED.
	912128	2	Spacer ring		WHEN DOUBLE SHEATED FUEL PIPES ARE INSTALLED.
20	844575	2	Attaching plate		WHEN DOUBLE SHEATED FUEL PIPES ARE NOT INSTALLED.
21	824234	1	Bracket		SEE GROUP 2C
22	820787	1	Exhaust pipe flange		
23	862776	1	Gasket	IK	(820783)
24	953259	4	Stud		
25	943152	4	Nut		
26	820900	1	Exhaust hose		L = 590 MM
27	820905	2	Connection flange		
28	862594	2	Gasket		(807578)
29	955593	8	Screw		
30	955829	8	Nut		
31	941912	8	Spring washer		
32	424619	1	Gasket	02B-0500	