

D6-300D-F (MC), D6-330D-F, D6-370D-F

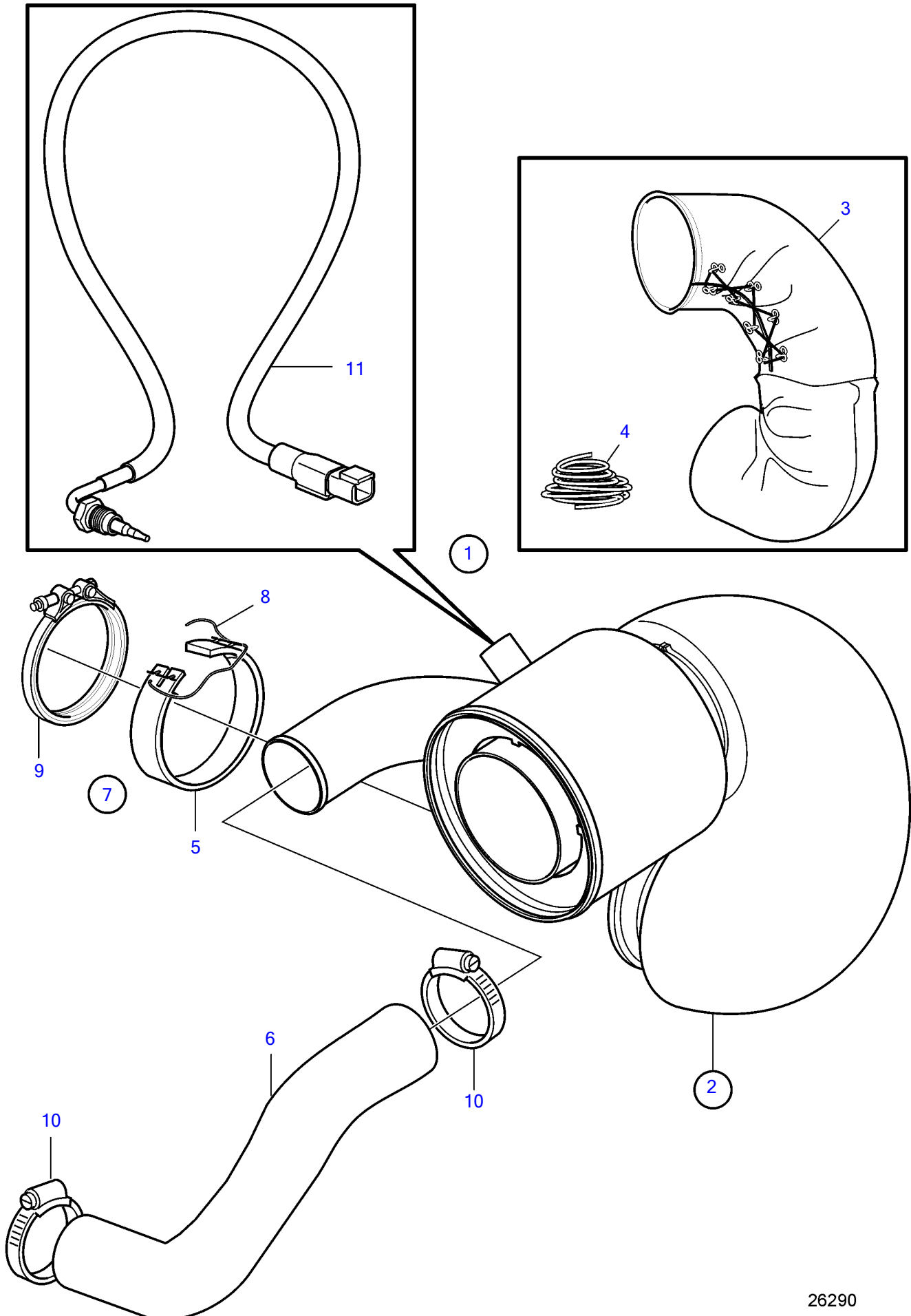

26290

D6-300D-F (MC), D6-330D-F, D6-370D-F

REF	PART NO.	QTY	DESCRIPTION	SEE SEC.	NOTES
1		1	Exhaust riser		
2	21710314	1	• Exhaust riser		
3	3584486		• • Isolation		
4		X	• • Locking wire		
5	3817198	1	• Isolation		
6	22132147	1	• Hose		
7		1	• Kit		
8	941710	X	• • Locking wire		
9	21325767	1	• • V-band clamp		
10	961672	2	• • Hose clamp		
11	21673187	1	Temperature sensor		
			• Installation Instruction 47703789	47703789-EN	Sensor