

D6-280A-A, D6-280A-B, D6-280A-C, D6-280A-D, D6-280A-E, D6-310A-A, D6-310A-B, D6-310A-C, D6-310A-D, D6-310D-B, D6-310D-C, D6-310D-D, D6-330A-B, D6-330A-C, D6-330A-D, D6-330D-B, D6-330D-C, D6-330D-D, D6-350A-A, D6-350A-B, D6-370A-B, D6-370A-C, D6-370A-D, D6-370D-B, D6-370D-C, D6-370D-D, D6-310A-E, D6-310D-E, D6-330A-E, D6-330D-E, D6-370A-E, D6-370D-E

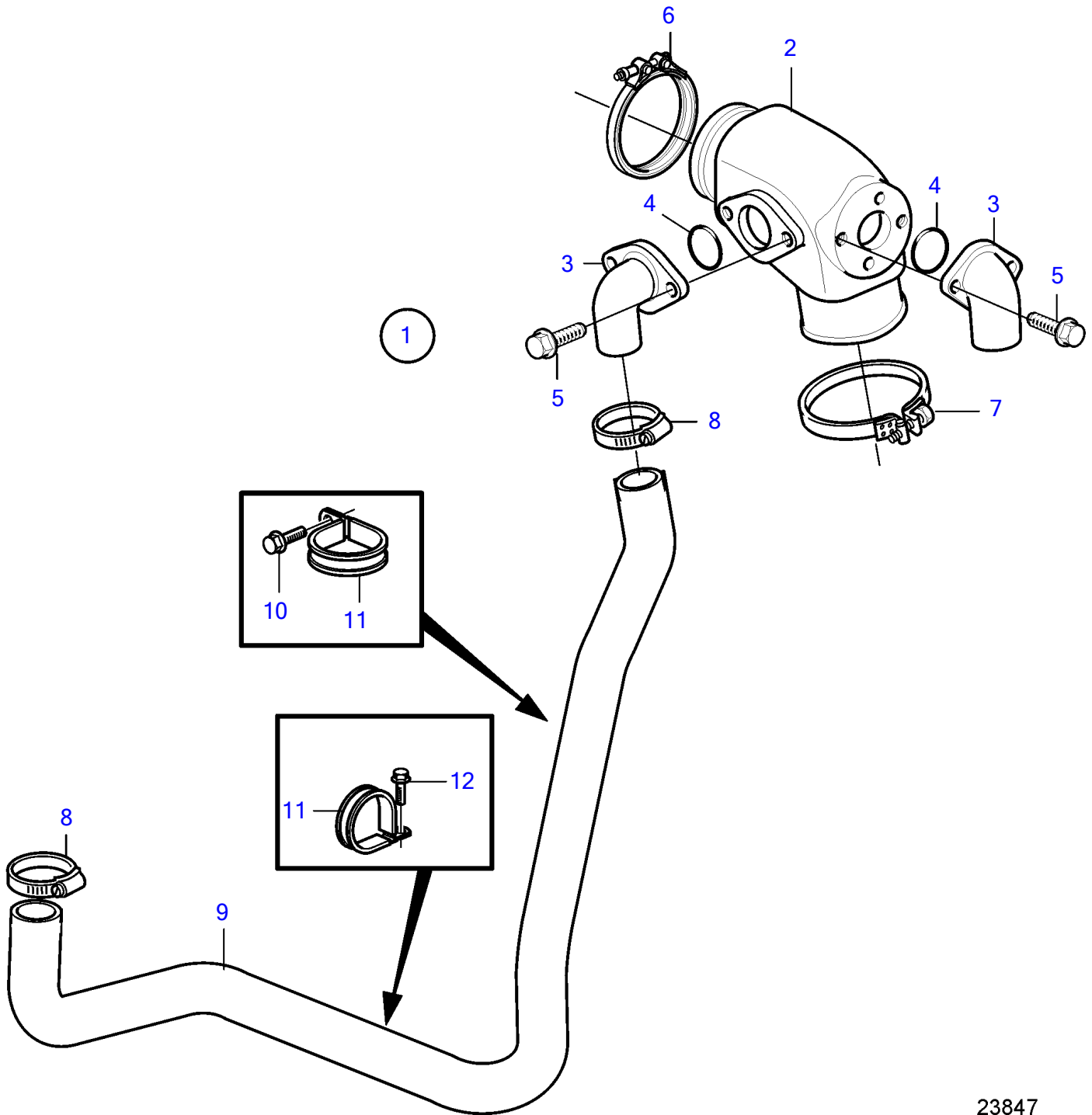

23847

D6-280A-A, D6-280A-B, D6-280A-C, D6-280A-D, D6-280A-E, D6-310A-A, D6-310A-B, D6-310A-C, D6-310A-D, D6-310D-B, D6-310D-C, D6-310D-D, D6-330A-B, D6-330A-C, D6-330A-D, D6-330D-B, D6-330D-C, D6-330D-D, D6-350A-A, D6-350A-B, D6-370A-B, D6-370A-C, D6-370A-D, D6-370D-B, D6-370D-C, D6-370D-D, D6-310A-E, D6-310D-E, D6-330A-E, D6-330D-E, D6-370A-E, D6-370D-E

REF	PART NO.	QTY	DESCRIPTION	NOTES
1	(3817827)	1	Exhaust pipe kit	Obsolete part
2	3841510	1	• Exhaust riser	
3	21450768	2	• Connector	
4	969415	2	• O-ring	
5	947542	4	• Flange screw	
6	3807212	1	• V-band clamp	
7	3817486	1	• Hose clamp	
8	961671	3	• Hose clamp	
9	3817236	1	• Hose	
10	946440	1	• Flange screw	
11	969354	2	• Clamp	
12	946440	1	• Flange screw	