

D6-280A-A, D6-280A-B, D6-280A-C, D6-280A-D, D6-280A-E, D6-280I-A, D6-280I-B, D6-280I-C, D6-280I-D, D6-280I-E, D6-310I-A, D6-310A-A, D6-310A-B, D6-310A-C, D6-310A-D, D6-310D-B, D6-310D-C, D6-310D-D, D6-310I-B, D6-310I-C, D6-310I-D, D6-330A-B, D6-330A-C, D6-330A-D, D6-330D-B, D6-330D-C, D6-330D-D, D6-330I-B, D6-330I-C, D6-330I-D, D6-350A-A, D6-350A-B, D6-370A-B, D6-370A-C, D6-370A-D, D6-370D-B, D6-370D-C, D6-370D-D, D6-370I-A, D6-370I-B, D6-370I-C, D6-370I-D, D6-310A-E, D6-310D-E, D6-310I-E, D6-330A-E, D6-330D-E, D6-330I-E, D6-370A-E, D6-370D-E, D6-370I-E, D6-400A-E, D6-435D-A, D6-435D-D, D6-435D-C, D6-435D-E, D6-435I-A, D6-435I-C, D6-435I-D, D6-435I-E

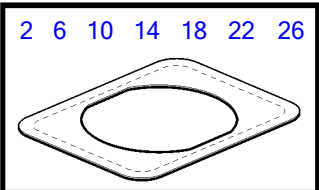
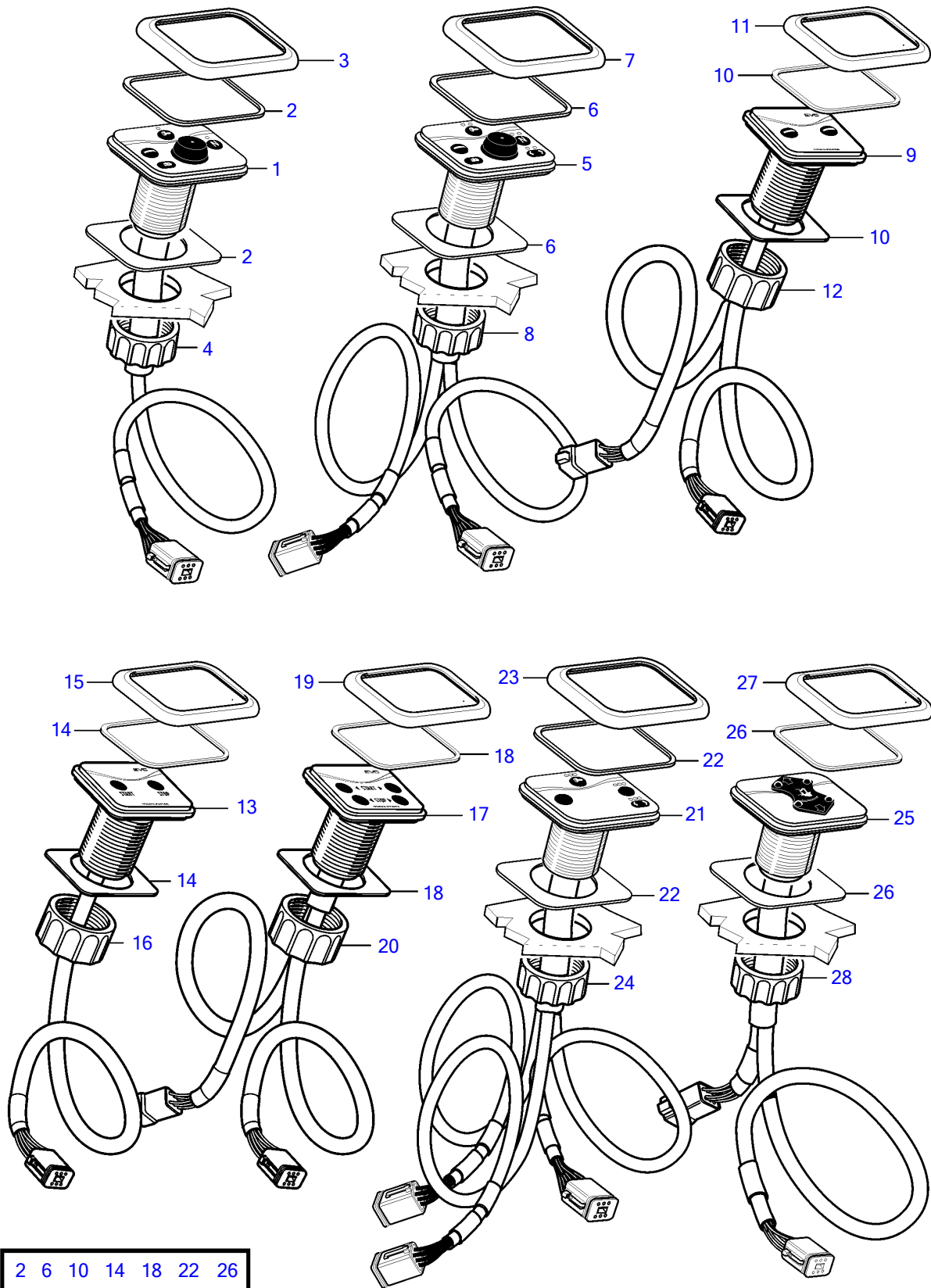

24466

D6-280A-A, D6-280A-B, D6-280A-C, D6-280A-D, D6-280A-E, D6-280I-A, D6-280I-B, D6-280I-C, D6-280I-D, D6-280I-E, D6-310I-A, D6-310A-A, D6-310A-B, D6-310A-C, D6-310A-D, D6-310D-B, D6-310D-C, D6-310D-D, D6-310I-B, D6-310I-C, D6-310I-D, D6-330A-B, D6-330A-C, D6-330A-D, D6-330D-B, D6-330D-C, D6-330D-D, D6-330I-B, D6-330I-C, D6-330I-D, D6-350A-A, D6-350A-B, D6-370A-B, D6-370A-C, D6-370A-D, D6-370D-B, D6-370D-C, D6-370D-D, D6-370I-A, D6-370I-B, D6-370I-C, D6-370I-D, D6-310A-E, D6-310D-E, D6-310I-E, D6-330A-E, D6-330D-E, D6-330I-E, D6-370A-E, D6-370D-E, D6-370I-E, D6-400A-E, D6-435D-A, D6-435D-D, D6-435D-C, D6-435D-E, D6-435I-A, D6-435I-C, D6-435I-D, D6-435I-E

REF	PART NO.	QTY	DESCRIPTION	NOTES
1	21310162	1	Control panel	Single installation
2	3808135	1	• Gasket	Also for flushmounting.
3	3808131	1	• Frame	
4	3808134	1	• Nut	
5	21310164	1	Control panel	Twin installation
6	3808135	1	• Gasket	Also for flushmounting.
7	3808131	1	• Frame	
8	3808134	1	• Nut	
9	21144011	1	Control panel	Sportfish
10	3808135	1	• Gasket	Also for flushmounting.
11	3808131	1	• Frame	
12	3808134	1	• Nut	
13	40005641		Control panel, start/stop	Single installation, Dual station
14	3808135	1	• Gasket	Also for flushmounting.
15	3808131	1	• Frame	
16	3808134	1	• Nut	
17	40005642	1	Control panel, start/stop	Twin installation, Dual station
18	3808135	1	• Gasket	Also for flushmounting.
19	3808131	1	• Frame	
20	3808134	1	• Nut	
21	3594954	1	Kit, start/stop	Triple installation.
22	3808135	1	• Gasket	
23	3808131	1	• Frame	
24	3808134	1	• Nut	
25	40005634	1	Control panel	Power trim
26	3808135	1	• Gasket	Also for flushmounting.
27	3808131	1	• Frame	
28	3808134	1	• Nut	