

MD31A,TMD31A,TAMD31A

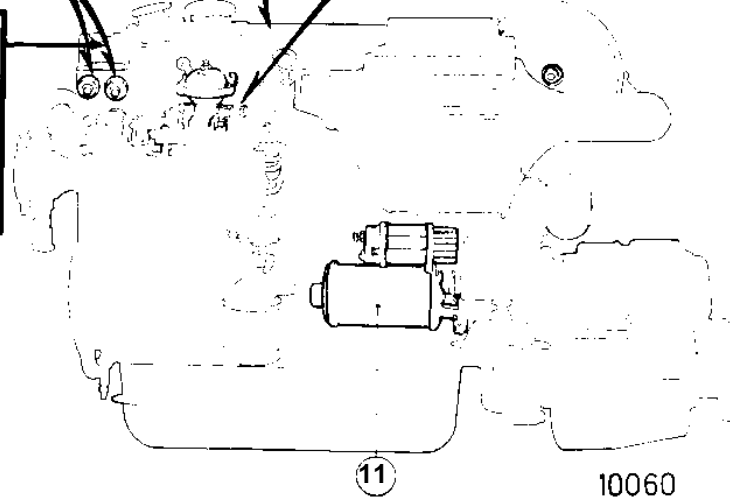
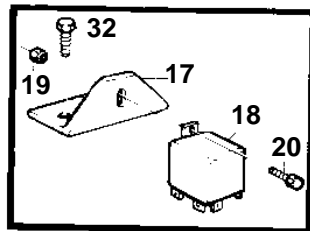
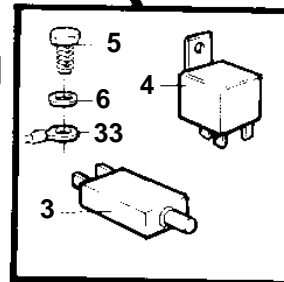
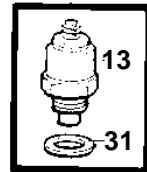
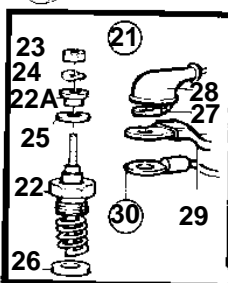
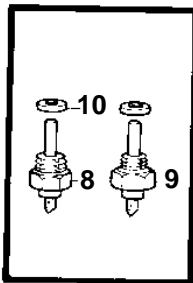
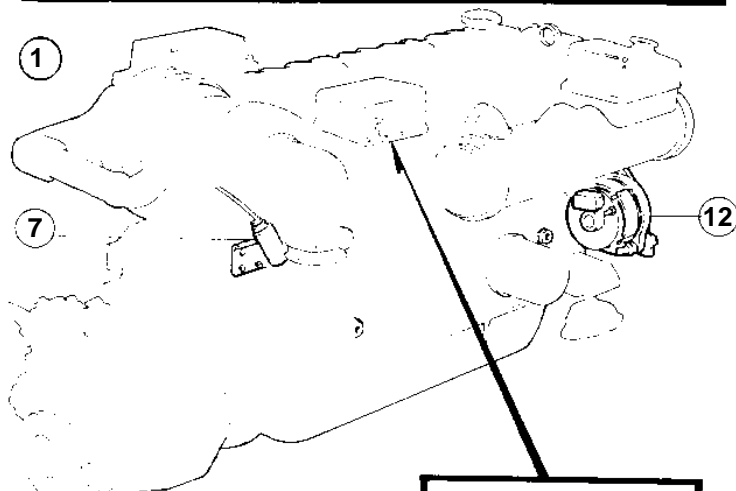
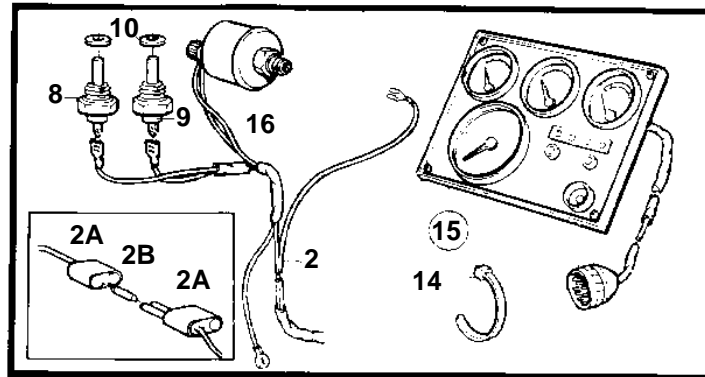

MD31A,TMD31A,TAMD31A

REF	PART NO.	QTY	DESCRIPTION	SEE SEC.	NOTES
1	860323	1	Conversion kit		
2	859049	1	• Cable trunk		
2A	966334	1	• • Fuse holder		
2B	11433	1	• • Fuse		FOR EXHAUST PRESSURE REGULATOR
3	966689	1	• Fuse		
4	837878	2	• Relay		
5	956074	1	• Screw		
6	942605	1	• Lock washer		
7	876175	1	• Control magnet kit		(859080)
			• COMPONENTS		SEE GROUP 3
8	862154	1	• Temperature sensor		
9	858229	1	• Thermo monitor		
10	957181	2	• Gasket		
11	838987	1	• Starter motor, STARTER MOTOR COMPONENTS		
12	849563	1	• Alternator, GENERATOR COMPONENTS		SEE GROUP 3 28V 55A. FOR 24 VOLTAGE ELECTRIC SYSTEM. SEE GROUP 3 REPL BY863955
	863955	1	• Alternator		28V 60A. FOR 24 VOLTAGE ELECTRIC SYSTEM.. ALSO AVAILABLE AS AN EXCHANGE PART.
12			• Bulletin 45-02A • COMPONENTS	45-02A-EN	Alternator SEE GROUP 3
13	859262	1	• Stop solenoid		(858058)
14	948210	10	• Strip clamp		
15	859063	1	• Instrument panel • COMPONENTS		REPL BY 860141 SEE GROUP 3
	864041	1	• Instrument panel • COMPONENTS		SEE GROUP 3
16	862155	1	• Sender		
17	858937	1	• Bracket		
18	838955	1	• Relay		
19	949278	1	• Lock nut		
20	965175	1	• Screw		
21	876132	1	• Heater plug kit		
22	859021	2	• • Glow plug		
23	965483	2	• • Nut		
24	941905	2	• • Spring washer		
25		2	• • O-RING		NOT TO BE USED WHERE CONTACT PLATE 860044 SHALL BE USED
26	859211	2	• • Sealing ring		
27		X	• CABLES AND TERMINALS		ALT SEE GROUP 3
28	673580	X	• Rubber collar		
29	859451	1	• Rail		ALT. GLOW PLUG 1-2
	859450	1	• Rail		ALT. GLOW PLUG 2-3
	859449	1	• Rail		ALT. GLOW PLUG 3-4
30	860044	1	• Bridge		SEE GROUP 3
31	243572	1	• O-ring		
32		2	SCREW		SEE GROUP 2B
33		X	CABLES AND TERMINALS		SEE GROUP 3