

MD31A,TMD31A,TAMD31A

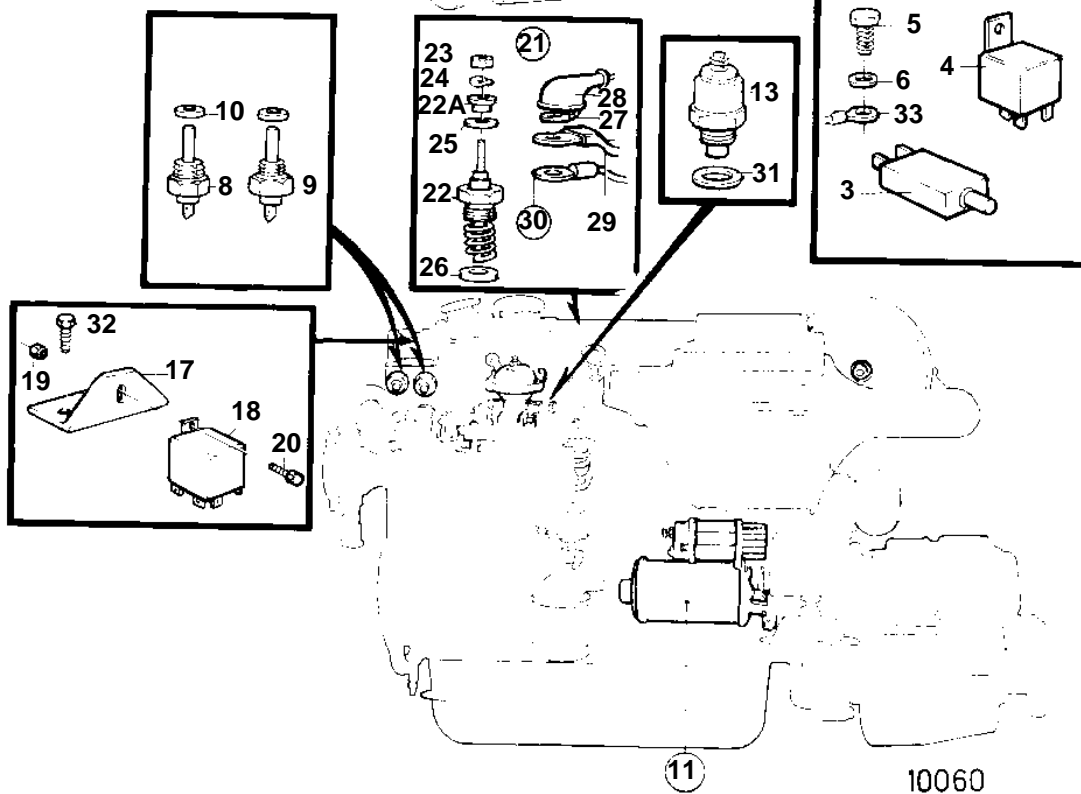
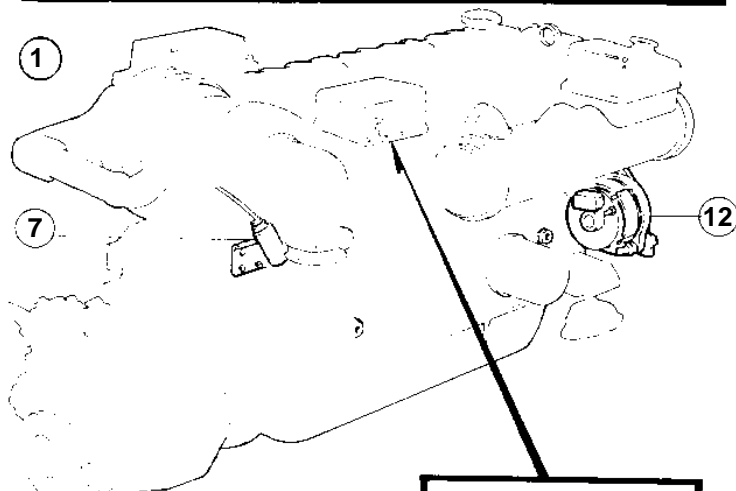
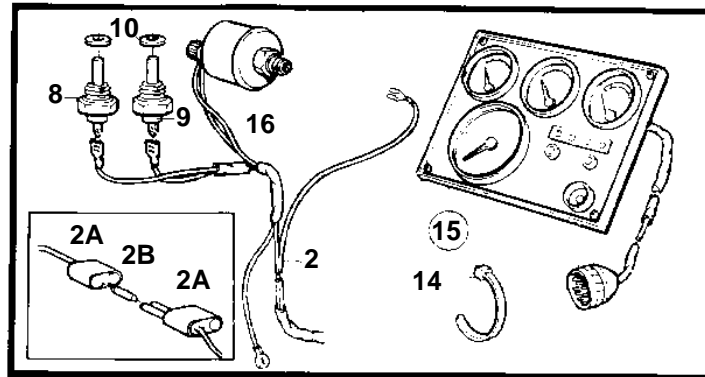

MD31A,TMD31A,TAMD31A

REF	PART NO.	QTY	DESCRIPTION	SEE SEC.	NOTES
1	858910	1	Conversion kit		REPL BY 860323 FOR ENGINES WITH PREHEATING OF AIR.
2	858085	1	• Cable kit		REPL BY 859049
	859049	1	• Cable trunk		
2A	966334	1	• • Fuse holder		
2B	11433	1	• • Fuse		FOR EXHAUST PRESSURE REGULATOR
3	966689	1	• Fuse		
4	837878	1	• Relay		
	838955	1	• Relay		
5	956074	1	• Screw		
6	942605	1	• Lock washer		
7	876175	1	• Control magnet kit		(859080)
			• COMPONENTS		SEE GROUP 3
8	843325	1	• Temperature sensor		
9	858229	1	• Thermo monitor		
10	957181	2	• Gasket		
11	838987	1	• Starter motor, STARTER MOTOR COMPONENTS		
12	849563	1	• Alternator, GENERATOR COMPONENTS		SEE GROUP 3 28V 55A. FOR 24 VOLTAGE ELECTRIC SYSTEM. SEE GROUP 3 REPL BY863955
	863955	1	• Alternator		28V 60A. FOR 24 VOLTAGE ELECTRIC SYSTEM.. ALSO AVAILABLE AS AN EXCHANGE PART.
12			• Bulletin 45-02A • COMPONENTS	45-02A-EN	Alternator SEE GROUP 3
13	859262	1	• Stop solenoid		(858058)
14	948210	10	• Strip clamp		
15	858086	1	• Instrument panel • COMPONENTS		REPL BY 858866 SEE GROUP 3
	858866	1	• Instrument panel • COMPONENTS		SEE GROUP 3
22A	859328	2	• • Thrust sleeve		
27		X	• CABLES AND TERMINALS		SEE GROUP 3
28	673580	X	• Rubber collar		
31	243572	1	• O-ring		
33		X	CABLES AND TERMINALS		SEE GROUP 3