

D2-55A, D2-55B, D2-55C, D2-55D, D2-55E, D2-55F

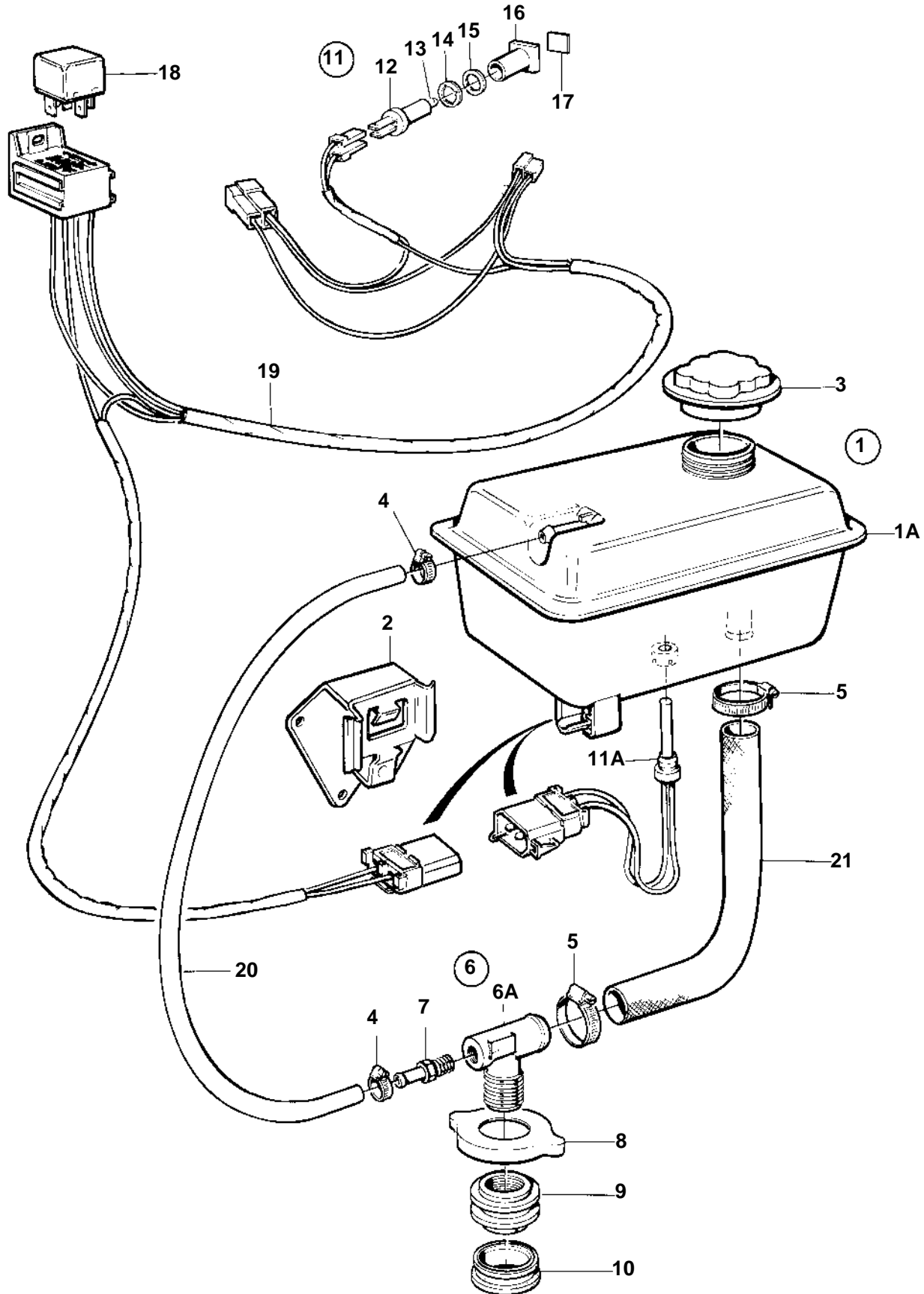

15865

D2-55A, D2-55B, D2-55C, D2-55D, D2-55E, D2-55F

REF	PART NO.	QTY	DESCRIPTION	SEE SEC.	NOTES
1	3581427	1	Expansion tank		(861745)
1A	861105	1	· Expansion tank		
2	3582351	1	· Bracket		
3	1674083	1	· Pressure cap		75kPa (1357775)
4	961663	2	· Hose clamp		
5	961666	2	· Hose clamp		
6	3581441	1	· Hose connection		(861741)
6A	943516	1	· · Elbow nipple		
7	860558	1	· · Hose coupling		
8	861740	1	· · Cardboard tube		
9	3581430	1	· · Sealing retainer		
10	1543751	1	· · Sealing ring		
11	861759	1	Level guard		
11A	3547710	1	· Level guard		
12	808175	1	· Lamp socket		
13	19923	1	· Bulb		12V, 2W
14	967583	1	· Retainer		
15	829714	1	· Sealing ring		
16	838455	1	· Retainer		
17	3825092	1	· Symbol strip		
18	873765	1	· Relay		(873765)
19		X	· Cables and terminals	1963	
20	942700	X	Hose		
21	952970	X	Hose		