

D16C-A MH, D16C-B MH, D16C-C MH

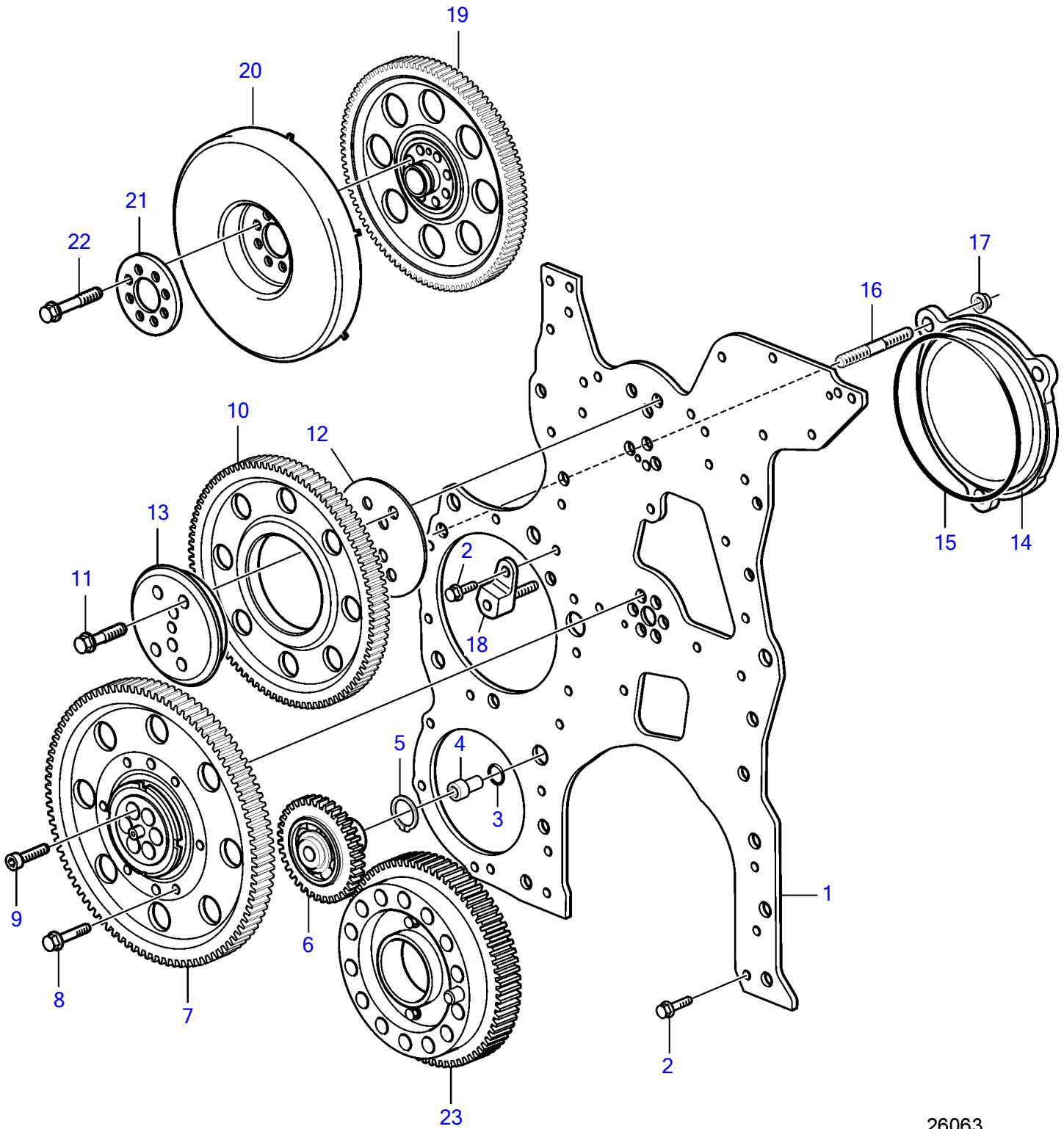

26063

## D16C-A MH, D16C-B MH, D16C-C MH

REF	PART NO.	QTY	DESCRIPTION	SEE SEC.	NOTES
1	20854044	1	Timing gear plate		
2	945444	26	Flange screw		
3	949656	1	O-ring		
4			Shaft		
5	914465	1	Snap ring		
6	21284699	1	Idler gear		
7	21057442	1	Idler gear		
8	8192804	8	Screw		
9	20483919	6	Hex. socket screw		
10	20743007	1	Idler gear		
11	21015266	6	Flange screw		
12	8131850	1	Thrust washer		
13	20520535	1	Hub, crankshaft		
14	849135	1	Cover		
15	948977	1	O-ring		
16	953102	2	Stud		
17	979230	3	Flange nut		
18	20531962	1	Nut		
19	20891469	1	Gear, gear camshaft		Replaced by 21456239
	21456239	1	Gear, gear camshaft		
20		1	Vibration damper	9861	
21	21294882	1	Spacer		
22	8192804	8	Screw		
23	20801971	1	Gear		