

D16C-A MH, D16C-B MH, D16C-C MH

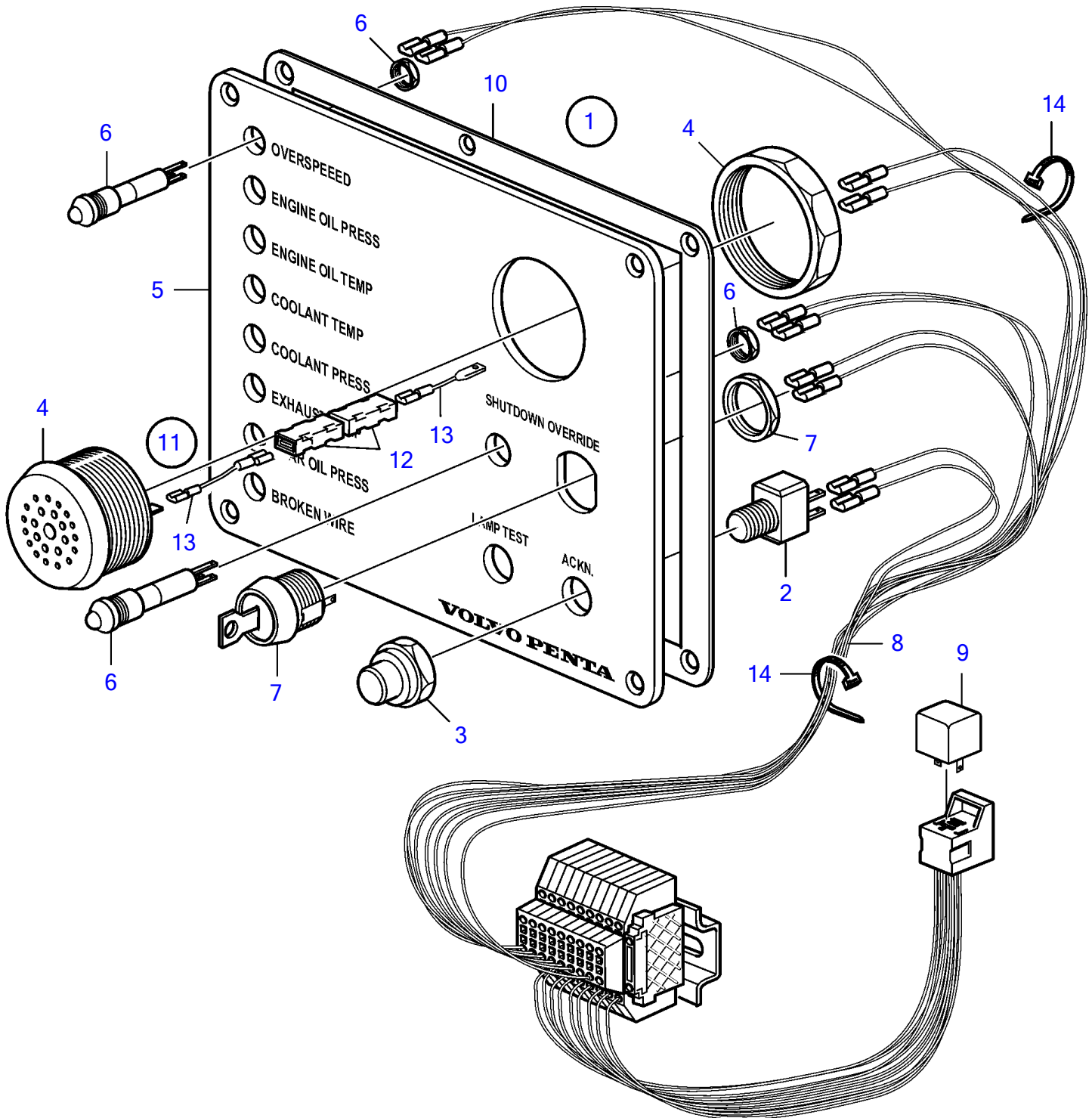

19731

D16C-A MH, D16C-B MH, D16C-C MH

REF	PART NO.	QTY	DESCRIPTION	NOTES
1	881959	1	Control panel	
2	828584	2	• Toggle switch	
3	828586	2	• Nut	
4	3817974	1	• Alarm	(828587)
5	(881954)	1	• Front panel	Obsolete part
6	881956	9	• Diode	
7	881963	1	• Switch	
8	881999	1	• Cable kit	
9	3171420	1	• • Relay	
10	862331	1	Gasket	
11	859427	1	Diode kit	Contains parts for single and Twin installation.
12		4	• Diode	
13	859426	1	• Cable kit	
14	948702	X	Cable tie	