

D12D-A MH, D12D-B MH, D12D-C MH, D12D-E MH, D12D-G MH, D12C-A MP, D12D-A MP, D12D-B MP, D12D-C MP, D12D-D MP

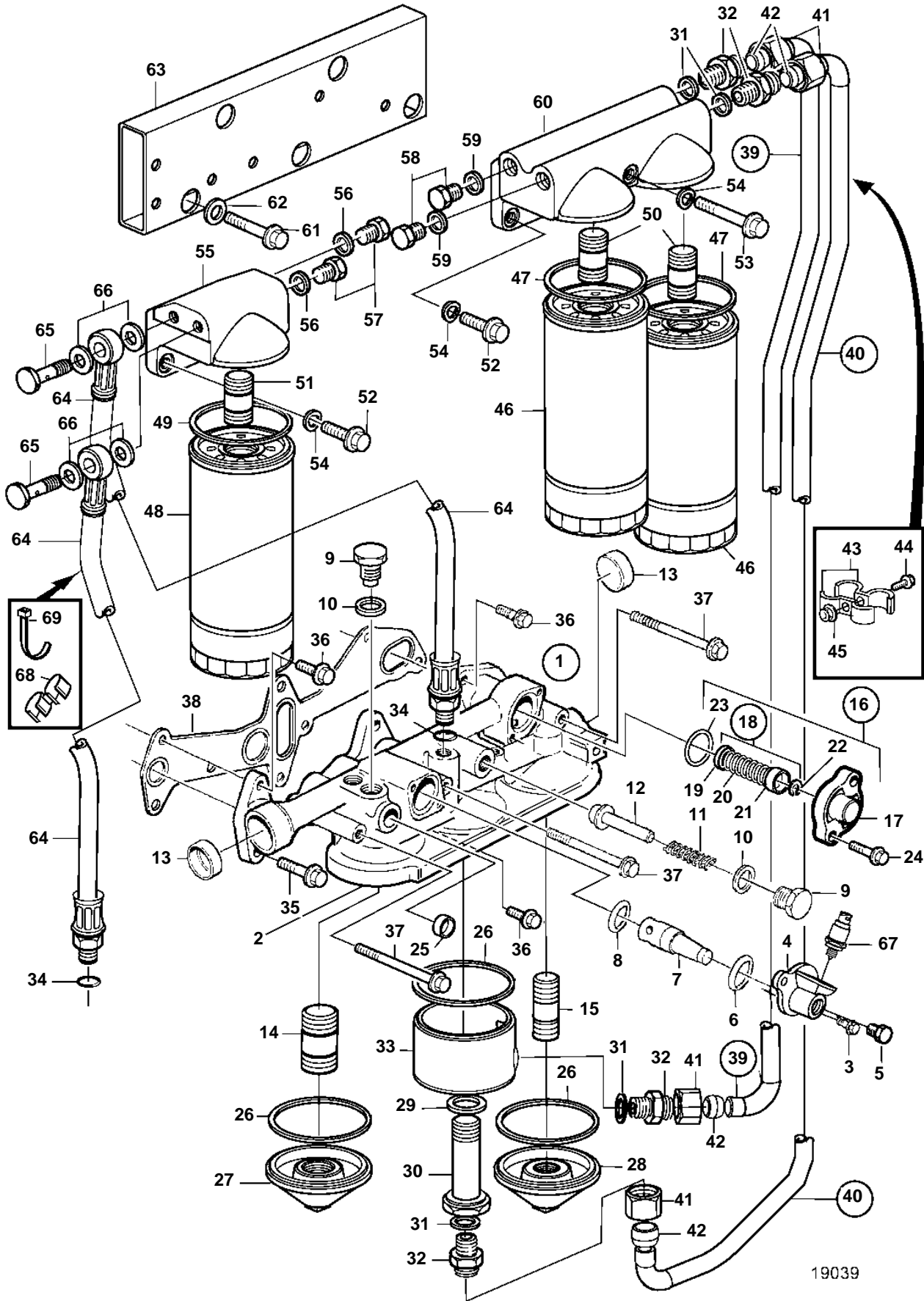

D12D-A MH, D12D-B MH, D12D-C MH, D12D-E MH, D12D-G MH, D12C-A MP, D12D-A MP, D12D-B MP, D12D-C MP, D12D-D MP

REF	PART NO.	QTY	DESCRIPTION	SEE SEC.	NOTES
1	3886152	1	Oil filter housing		
2		1	· Filter housing		
3	946544	2	· Flange screw		
4	3827980	1	· Cardboard tube		
5	479979	1	· Plug		
6	949659	1	· O-ring		
7	471646	1	· Piston cooling valve		(3830140)
8	469846	1	· Sealing ring		
9	471598	2	· Plug		
10	947627	2	· Gasket		
11	3830138	1	· Compression spring		
12	471085	1	· Valve cone		
13	948812	2	· Cap plug		
14	469904	1	· Nipple		
15	466623	1	· Nipple		
16	3169689	1	· Valve		
17	3184806	1	· · Cover		
18	3169687	1	· · · Delivery valve		
19		1	· · · · Valve		
20		1	· · · · Spring		
21		1	· · · · Valve guide		
22	955964	1	· · · · Snap ring		
23	949659	1	· · · O-ring		
24	947542	2	· Flange screw		
25	946778	1	· Cap plug		
26	948981	3	· O-ring		
27	3812509	1	· Cover		(848431)
28	3812511	1	· Cover		(3828030)
29	944126	1	· O-ring		
30	3827458	1	· Nipple		
31	976932	4	· Gasket		
32	982254	4	· Nipple		
33	3827459	1	· Cover		
34	976971	2	O-ring		
35	947760	1	Flange screw		Used when oil filler is mounted on right side., L=40mm
36	945444	5	Flange screw		L=25mm
37	969225	3	Flange screw		L=120mm
38	8170534	1	Gasket		
39	3827412	1	Oil pipe		REPL BY 3886153
	3886153	1	Oil pipe		
40	3827413	1	Oil pipe		REPL BY 3886154
	3886154	1	Oil pipe		
41	956987	4	· Fitting nut		
42	956973	4	· Ferrule		
43	424204	4	Attaching clamp		
44	947760	2	Flange screw		
45	948645	2	Flange lock nut		
46	478736	2	Oil filter		
47		2	· Gasket		
48	477556	1	Oil filter, by-pass		
49		1	· Gasket		
50	466623	2	Nipple		
51	469904	1	Nipple		
52	946472	4	Flange screw		L=30mm
53	969313	1	Flange screw		L=110mm
54	941908	5	Spring washer		
55	11127104	1	Oil filter housing, by-pass		
56	969011	2	Gasket		
57	960630	2	Plug		
58	960634	2	Plug		
59	947627	2	Gasket		
60	11031901	1	Oil filter housing		
61	981377	4	Flange screw		L=165mm

D12D-A MH, D12D-B MH, D12D-C MH, D12D-E MH, D12D-G MH, D12C-A MP, D12D-A MP, D12D-B MP, D12D-C MP, D12D-D MP

REF	PART NO.	QTY	DESCRIPTION	SEE SEC.	NOTES
62	941908	4	Spring washer		
63	3827411	1	Bracket		
64	3827414	2	Hose		
65	25167	2	Hollow screw		
66	969011	4	Gasket		
67		1	Sender, oil pressure	4247	
68	9205207	1	Retainer		
69	948211	1	Cable tie		