

-  Dielectric Grease (92-823509-1)
-  Loctite PST Pipe Sealant (92-809822)

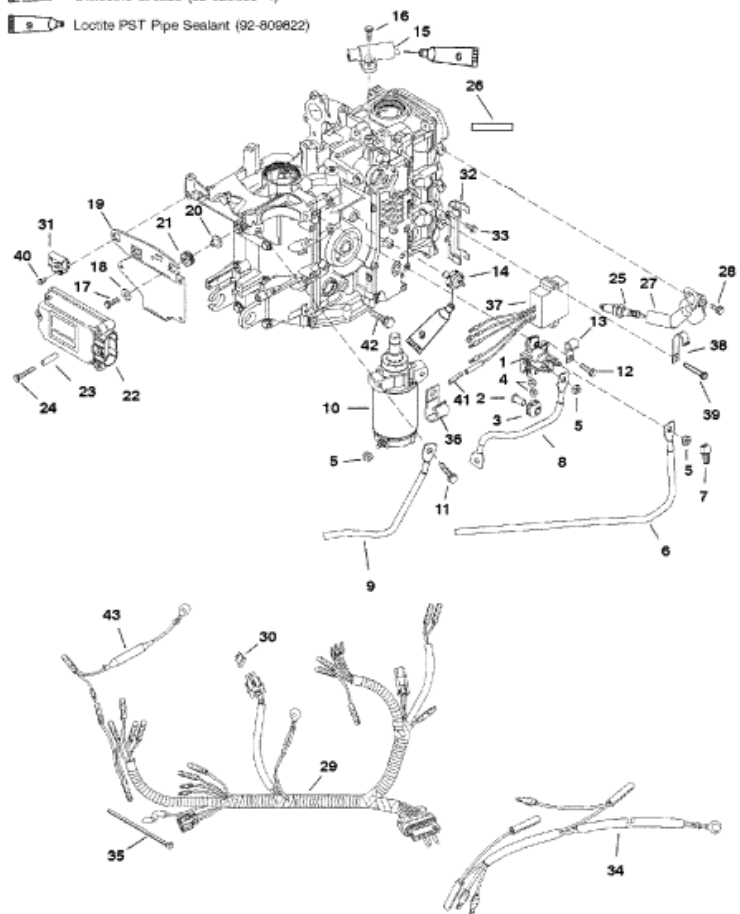

9149

Parts List

| Ref | Class | Part      | Description                  | Qty | Comment           | Footnote |
|-----|-------|-----------|------------------------------|-----|-------------------|----------|
| 1   | 89    | 850187T 1 | SOLENOID ASSEMBLY            | 1   | (ELECTRIC)        |          |
| 2   | 23    | 818968    | BUSHING                      | 2   | (ELECTRIC)        |          |
| 3   | 25    | 818967    | GROMMET                      | 2   | (ELECTRIC)        |          |
| 4   | 11    | 26419     | NUT, (#8-32)                 | 2   | (ELECTRIC)        |          |
| 5   | 11    | 94330     | NUT, (.250-20)               | 3   | (ELECTRIC)        |          |
| 6   | 84    | 88439A 9  | BATTERY CABLE, Positive      | 1   | (ELECTRIC)        |          |
| 7   | 85    | 79695     | BOOT, Insulator (Black)      | 1   | (ELECTRIC)        |          |
| 8   | 84    | 93388A12  | CABLE                        | 1   | (ELECTRIC)        |          |
| 9   | 84    | 88439A 4  | BATTERY CABLE, Negative      | 1   | (ELECTRIC)        |          |
| 10  | 50    | 859170T 1 | STARTER MOTOR                | 1   | (ELECTRIC)        |          |
| 11  | 10    | 40011153  | SCREW, (M8 x 45)             | 3   | (ELECTRIC)        |          |
| 11  | 10    | 40011149  | SCREW, (M8 x 25)             | 1   | (MANUAL)          |          |
| 12  | 10    | 826844 30 | SCREW, (M6 x 30)             | 2   | (ELECTRIC)        |          |
| 12  | 10    | 824832 4  | SCREW, (M6 x 16)             | 1   | (MANUAL)          |          |
| 13  | 54    | 65292     | J CLIP                       | 1   | (ELECTRIC)        |          |
| 14  | 87    | 828040F   | PRESSURE SWITCH              | 1   |                   | 5        |
| 15  |       | 828358    | SENSOR                       | 1   |                   |          |
| 16  | 10    | 40011107  | SCREW, (M5 x 16)             | 2   |                   |          |
| 17  | 10    | 821300 25 | SCREW, (M6 x 25)             | 3   |                   |          |
| 18  | 12    | 65567     | WASHER, (.265 x .750 x .048) | 3   |                   |          |
| 19  |       | 859224    | PLATE                        | 1   |                   |          |
| 20  | 23    | 822003    | BUSHING                      | 3   |                   |          |
| 21  | 25    | 834985    | GROMMET                      | 3   |                   |          |
| 22  |       | 856178T 3 | ECM                          | 1   |                   |          |
| 23  | 23    | 853920 1  | BUSHING                      | 3   |                   |          |
| 24  | 10    | 821291 40 | SCREW, (M6 x 40)             | 3   |                   |          |
| 25  | 33    | 827858    | SPARK PLUG, (NGK-DPR6EA-9)   | 3   |                   |          |
| 26  |       | NSS       | NOT SOLD SEPARATE, Decal-Coi | 1   |                   |          |
| 27  | 339   | 830404T 3 | IGNITION COIL                | 3   |                   |          |
| 28  | 10    | 40011128  | SCREW, (M6 x 20)             | 3   |                   |          |
| 29  | 84    | 856158A 2 | ENGINE WIRING HARNESS        | 1   | (MANUAL)          |          |
| 29  | 84    | 854781A 2 | ENGINE WIRING HARNESS        | 1   | (ELECTRIC)        |          |
| 30  | 88    | 812619    | FUSE, Yellow (20 Ampere)     | 1   | (ELECTRIC)        |          |
| 31  |       | 828054    | COVER, Fuse                  | 1   | (ELECTRIC)        |          |
| 32  |       | 826115 1  | CLAMP, Connector             | 1   | (ELECTRIC)        |          |
| 33  | 10    | 824832 4  | SCREW, (M6 x 16)             | 2   | (ELECTRIC)        |          |
| 34  | 84    | 852375A 6 | EXTENSION HARNESS            | 1   | (ELECTRIC HANDLE) |          |
| 35  | 54    | 816311T   | CABLE TIE, (8.00 Inches)     | AR  |                   |          |
| 36  | 54    | 47483     | J CLIP                       | 1   | (MANUAL)          |          |
| 37  |       | 854514T   | VOLTAGE REGULATOR            | 1   | (ELECTRIC)        |          |
| 38  | 54    | 65292     | J CLIP                       | 1   | (ELECTRIC)        |          |