

Parts List						
Ref	Class	Part	Description	Qty	Comment	Footnote
1		62720A 4	GIMBAL HOUSING ASSEMBLY	1		
2	37	87018	DECAL, GIMBAL HOUSING	1		
3	26	31783	OIL SEAL, LOWER ROLLER BE	1		
4	31	54043	ROLLER BEARING (LOWER)	1		
5	26	54925	OIL SEAL, UPPER ROLLER BEA	1		
6	31	21145	ROLLER BEARING (UPPER)	1		
7	22	69059	GREASE FITTING	1		
8	19	77633	LUBRICAP, GREASE FITTING	1		
9	16	57988	STUD, GIMBAL HOUSING (5-3/8	8		
10	27	54395T	GASKET, GIMBAL HOUSING	1		
11	25	54521	"O" RING, GIMBAL HOUSING	1		
12		54068	PILOT RING, GIMBAL HOUSING	1		
13	16	56766	STUD, GIMBAL HOUSING (1-3/8	2		
14		34762A 1	PLATE ASSEMBLY, INHIBITOR	1		
15	10	34763	SCREW, INHIBITOR PLATE (3	2		
16	32	54392	TUBE, OIL - GIMBAL HOUSING	1		
17	23	54421	BUSHING, SEALING - OIL TUBE	1		
18		54422A 1	COVER, SEALING BUSHING	1		
19	10	28636	SCREW, COVER (3/4")	2		
20	32	34423	HOSE, OIL - GIMBAL HOUSING TI	1		
21	54	54428	CLAMP, OIL HOSE	2		
22		47347	CONNECTOR (EARLY PRESTOLI	1		
22		85054A 5	CONNECTOR (OILDYNE & LATER	1		
23	27	47644	GASKET, HYDRAULIC CONNECT	1		
24	11	20361	NUT, HYDRAULIC CONNECTOR :	2		
25	17	54052T	SWIVEL PIN, GIMBAL HOUSING	1		
26	18	54929	COTTER PIN, LOWER SWIVEL PI	1		
27		57322	COVER, RETAINING	1		
28	10	28635	SCREW, RETAINING COVER TO	2		
29	13	78968	LOCKWASHER, HYDRAULIC CON	2		

ACCESS HOLE PLUG KIT
 22-88847A1 CONTAINS ALL
 NECESSARY PARTS (INCLUDING
 TEMPLATE) TO ALLOW REMOVAL
 OF SWIVEL SHAFT WITHOUT
 REMOVING GIMBAL HOUSING.

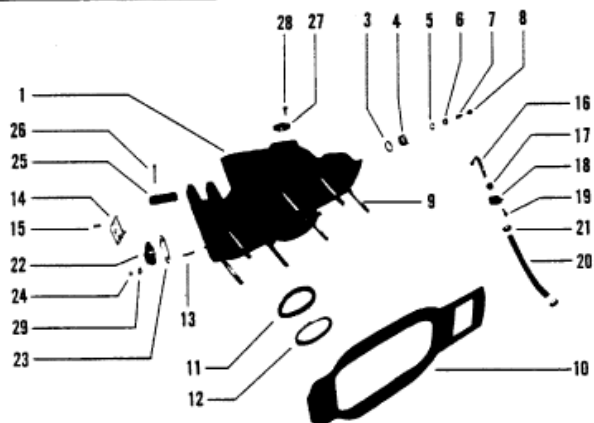

FOR CONTINUITY
 CIRCUIT COMPONENTS
 SEE PAGE 3